



Howard Park | Greystoke | Penrith | CA11 0TU

Guide Price £275,000



david britton
ESTATES

Key features

- Semi detached house
- Three bedrooms
- Kitchen diner
- Living room
- Gardens
- Garage
- Driveway parking
- Popular Village location

Description

A rare opportunity to own a lovely three bedroomed semi detached home, sitting at the bottom of a quiet cup-de-sac in the lovely Village of Greystoke just outside the Lake District national park.



Directions



Floor plans

GROUND FLOOR
571 sq.ft. (53.0 sq.m.) approx.



1ST FLOOR
397 sq.ft. (36.9 sq.m.) approx.

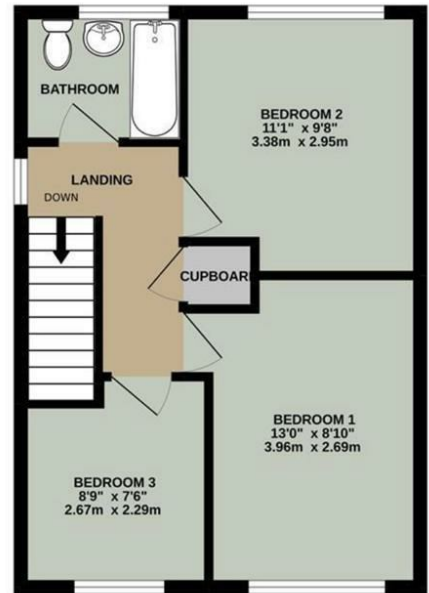

TOTAL FLOOR AREA: 968 sq.ft. (89.9 sq.m.) approx.

Whilst every attempt has been made to ensure the accuracy of the floorplan contained here, measurements of doors, windows, rooms and any other items are approximate and no responsibility is taken for any error, omission or mis-statement. This plan is for illustrative purposes only and should be used as such by any prospective purchaser. The services, systems and appliances shown have not been tested and no guarantee as to their operability or efficiency can be given.
Made with Metropix ©2022

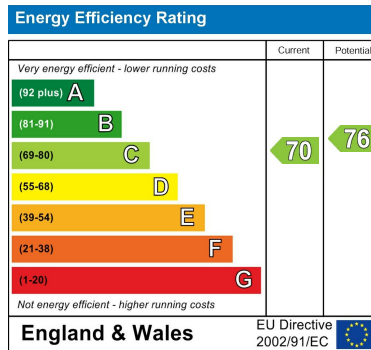

Unit 3 Mason Court Gillan Way, Penrith 40 Business Park
 Penrith
 Cumbria
 CA11 9GR
 01768881111
 Sales@brittonestates.co.uk
 www.brittonestates.co.uk