



Sellafield Road | | Beckermest | CA21 2XN

Guide Price £499,995



david britton
ESTATES

Key features

- Subject to planning permission for 14 market led houses
- Existing farm house in need of renovation
- Good commuter area for Sellafield and West coast
- More potential land via separate negotiation

Description

A development site with the potential of 14 full market led houses and a large sandstone farmhouse SSTP .

Beckermets is a very well thought of village and has been accepted as a village of choice for commuters working at Sellafield. A site here has the potential to bring an attractive return for a developer creating a well thought out development.

****Viewings strictly by appointment only****

Directions

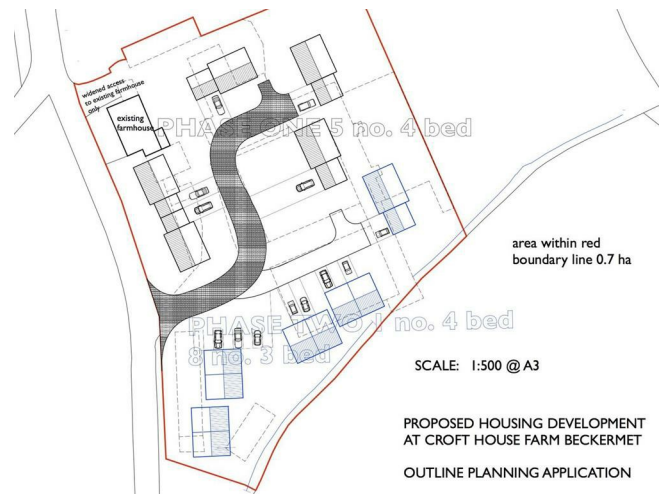

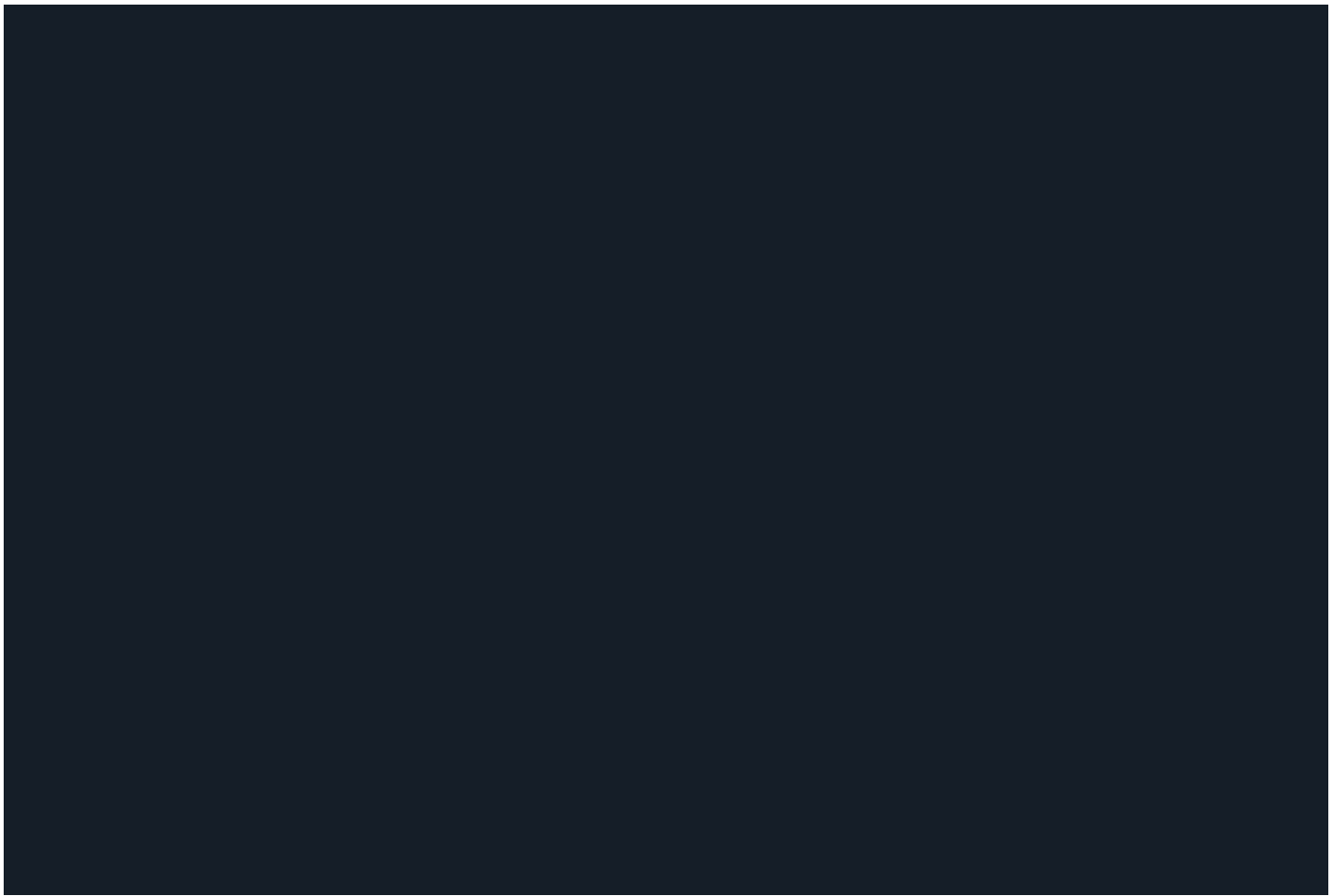

Floor plans

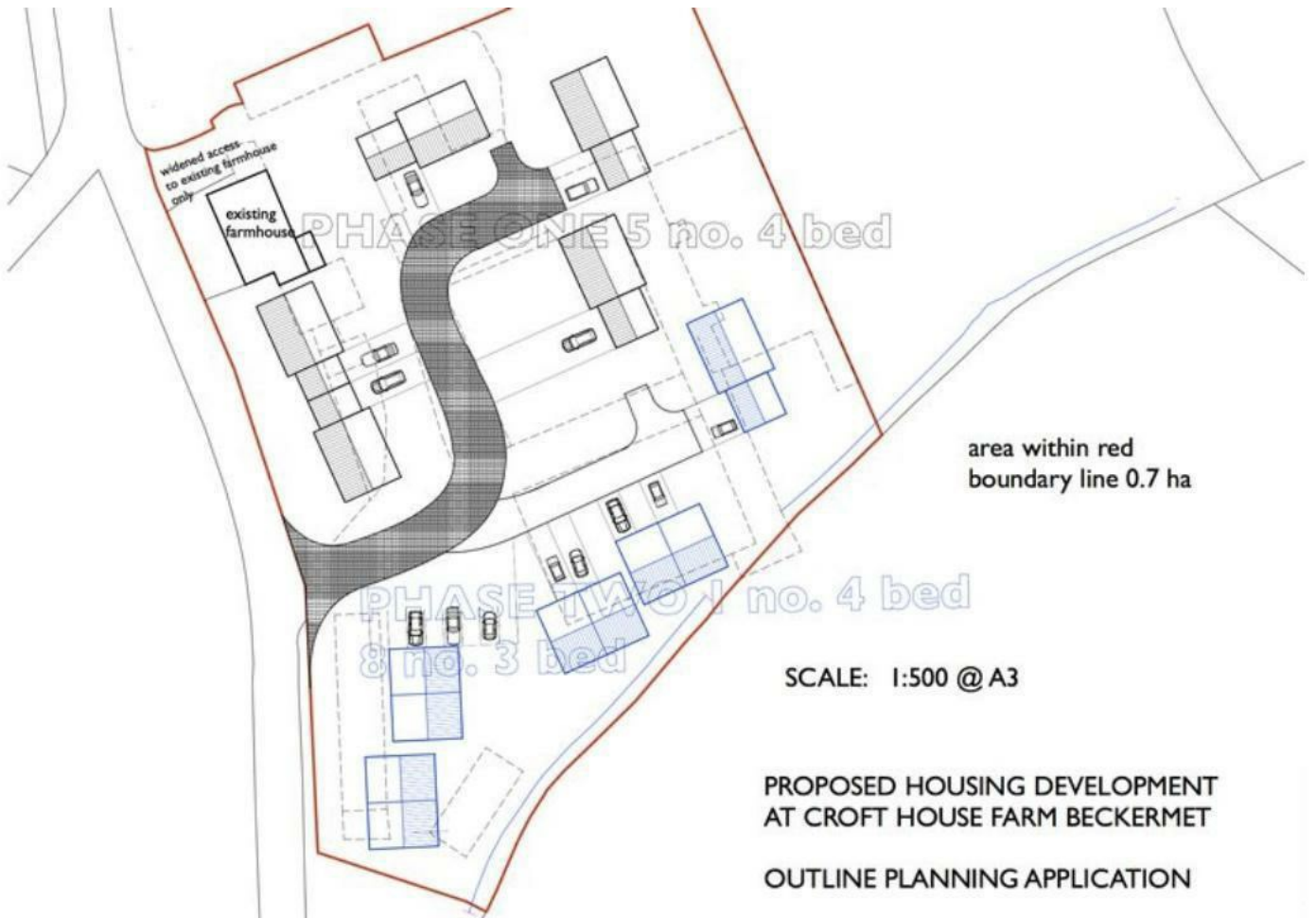

Energy Efficiency Rating		
	Current	Potential
<i>Very energy efficient - lower running costs</i>		
(92 plus) A		
(81-91) B		
(69-80) C		
(55-68) D		
(39-54) E		
(21-38) F		
(1-20) G		
<i>Not energy efficient - higher running costs</i>		
England & Wales	EU Directive 2002/91/EC	



Unit 3 Mason Court Gillan Way, Penrith 40 Business Park
 Penrith
 Cumbria
 CA11 9GR
 01768881111
 Sales@brittonestates.co.uk
 www.brittonestates.co.uk