



Manor Way

, Borehamwood WD6 1BX

- 2 double bedrooms
- Visitors' Permit
- Available furnished or unfurnished
- Fully fitted kitchen
- Close to shops and station
- Allocated underground Parking
- Communal garden
- Two bathrooms
- Large balcony
- Ready 13th May 2024

£1,550 PCM

Local Authority **Hertsmere**
Council Tax Band **D**
EPC Rating

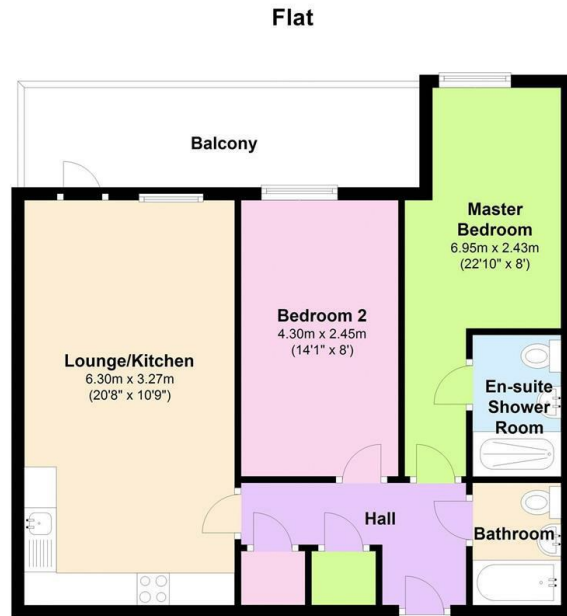

This floor plan is for illustrative purposes only and is not to scale. Where measurements are shown, these are approximate and should not be relied upon. Total square area includes the entirety of the property and any outbuildings/garages. Sanitary ware and kitchen fittings are representative only and approximate to actual position, shape and style. No liability is accepted in respect of any consequential loss arising from the use of this plan. Reproduced under licence from Evolve Partnership Limited. All rights reserved.

Plan produced using PlanUp.



Mill Hill Office
Concorde House Grenville Place, London,
NW7 5SA

Contact
0203 544 1561
raphael@housemanhomes.co.

Agents Note: Whilst every care has been taken to prepare these particulars, they are for guidance purposes only. All measurements are approximate and for general guidance purposes only and whilst every care has been taken to ensure accuracy, they should not be relied upon and potential buyers/tenants are advised to recheck the measurements.