



Bolton Road

Maidenbower, Crawley, RH10 7LR

Asking Price £175,000 Leasehold

Taylor Robinson welcomes to the market a 1 bedroom ground floor maisonette located in the highly sought after area of Maidenbower and offered to the market with no onward chain. The property in brief comprises of an entrance porch leading to a light and airy living room with storage cupboard. There is a double bedroom with views across the gardens, a fully fitted kitchen with direct access to the communal gardens and a bathroom fitted in a white contemporary suite. The property also benefits from double glazing, gas central heating, allocated parking space, communal gardens and conveniently located close to schools, bus routes and the local amenities.

Viewing

Please contact our Taylor Robinson Office on 01293 552388 if you wish to arrange a viewing appointment for this property or require further information.

- Guide Price £175,000 - £185,000
- Chain Free
- Quiet location
- Fully Fitted Kitchen
- Communal Garden
- Double Glazing & Gas Central Heating
- Allocated Parking Space
- Sought After Location
- Remaining Lease Term 86 Years
- Ground Rent £150 & Service Charge £1200 Annually



Floor Plan

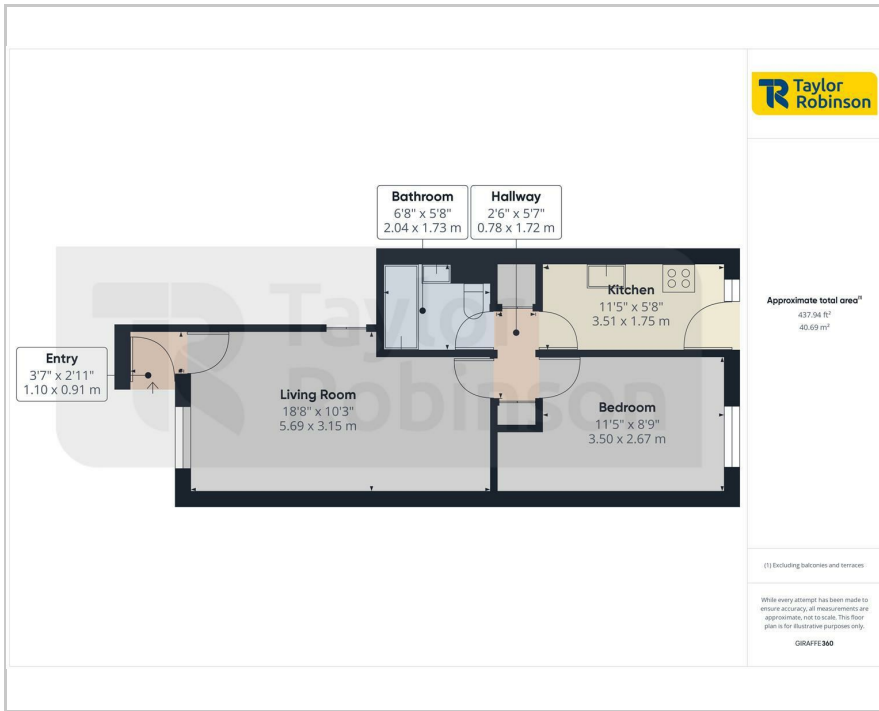

Area Map



Energy Efficiency Graph

Energy Efficiency Rating

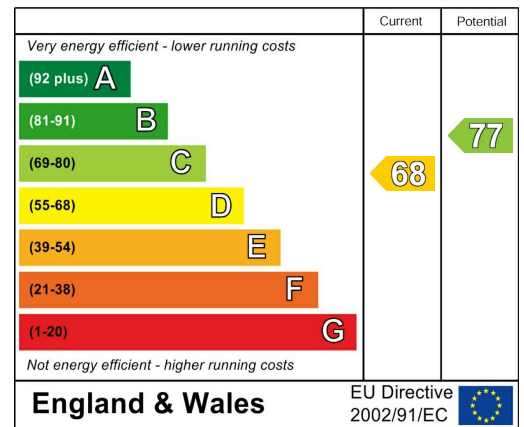

Council Tax Band: B



These particulars, whilst believed to be accurate are set out as a general outline only for guidance and do not constitute any part of an offer or contract. Intending purchasers should not rely on them as statements of representation of fact, but must satisfy themselves by inspection or otherwise as to their accuracy. No person in this firm's employment has the authority to make or give any representation or warranty in respect of the property.