



## Woodfield Lodge, Woodfield Road

Northgate, Crawley, RH10 8AH

**£190,000 Leasehold**

Taylor Robinson is delighted to welcome to the market a 1 bedroom apartment located in a gated development and offered to the market with no onward chain. The property in brief comprises of an entrance hall with large storage cupboard and boiler cupboard. There is a light and airy living room with Juliette balcony, a fully fitted kitchen and a modern shower room. Externally you will find an allocated parking space and the property also benefits from double glazing and gas central heating.

- One Double Bedroom Apartment
- Gated Development
- Chain Free
- Well Presented
- Fully Fitted Kitchen
- Light and Airy Living Room
- Modern Shower Room
- Remaining Lease Term 83 Years
- Annual Service Charge including Ground Rent = £1352.88

### Viewing

Please contact our Taylor Robinson Office on 01293 552388 if you wish to arrange a viewing appointment for this property or require further information.



## Floor Plan

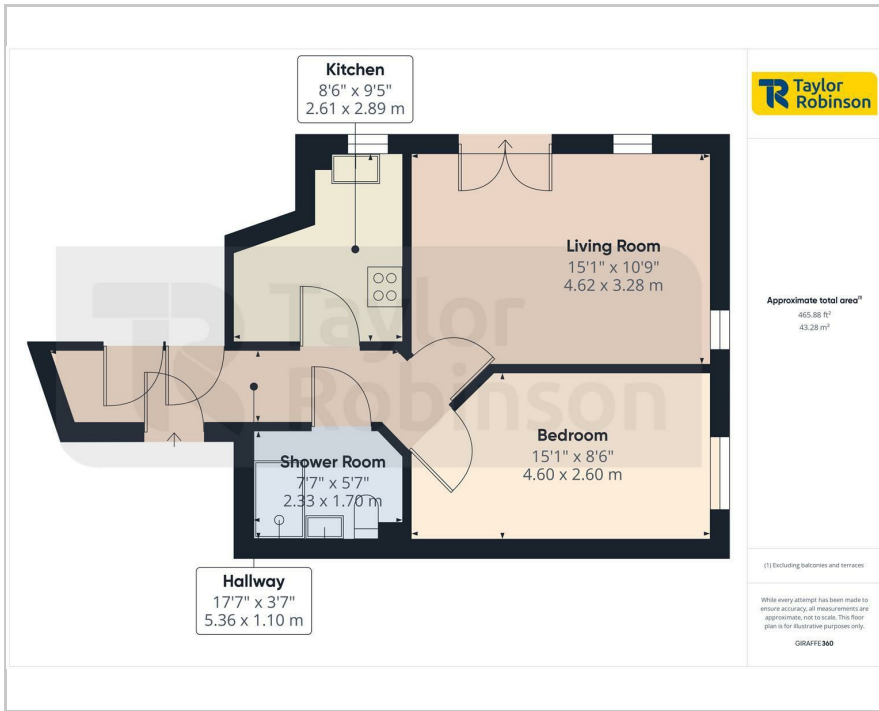

## Area Map

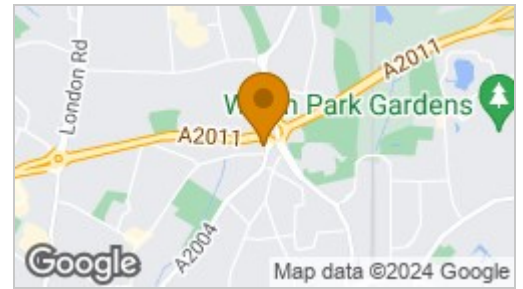

## Energy Efficiency Graph

### Energy Efficiency Rating

	Current	Potential
<i>Very energy efficient - lower running costs</i>		
(92 plus) <b>A</b>		
(81-91) <b>B</b>	<b>81</b>	<b>81</b>
(69-80) <b>C</b>		
(55-68) <b>D</b>		
(39-54) <b>E</b>		
(21-38) <b>F</b>		
(1-20) <b>G</b>		
<i>Not energy efficient - higher running costs</i>		
<b>England &amp; Wales</b>	EU Directive 2002/91/EC	

## Council Tax Band: B



These particulars, whilst believed to be accurate are set out as a general outline only for guidance and do not constitute any part of an offer or contract. Intending purchasers should not rely on them as statements of representation of fact, but must satisfy themselves by inspection or otherwise as to their accuracy. No person in this firm's employment has the authority to make or give any representation or warranty in respect of the property.

**2 Brittingham House Orchard Street, Crawley, West Sussex, RH11 7AE Tel: 01293 552388**

**Email: sales@taylor-robinson.co.uk**

**www.taylor-robinson.co.uk**