

Brunt & Fussell



Bath Road, Swineford, BS30 6LN

£265,000

Situated in the hamlet of Swineford and offered with no onward chain is this super characterful cottage, ideal for those wishing to live in a countryside environment at the foot of the Cotswolds. This charming home boasts hallway, lounge diner, kitchen, two bedrooms, bathroom and useful loftroom for use as storage or study. The property is partly double glazed and gas centrally heated, boasts ample rear garden and ideally suits someone wishing to stamp their own mark on their new home. Rarely will this opportunity arise so viewing is highly recommended. Energy Rating D, Council Tax Band C.

- No Onward Chain
- Cottage Home
- Two Bedrooms
- Lounge Diner
- Loft Room
- Great Location

Viewing

Please contact our Brunt & Fussell Ltd Office on 01179566004 if you wish to arrange a viewing appointment for this property or require further information.



Floor Plan

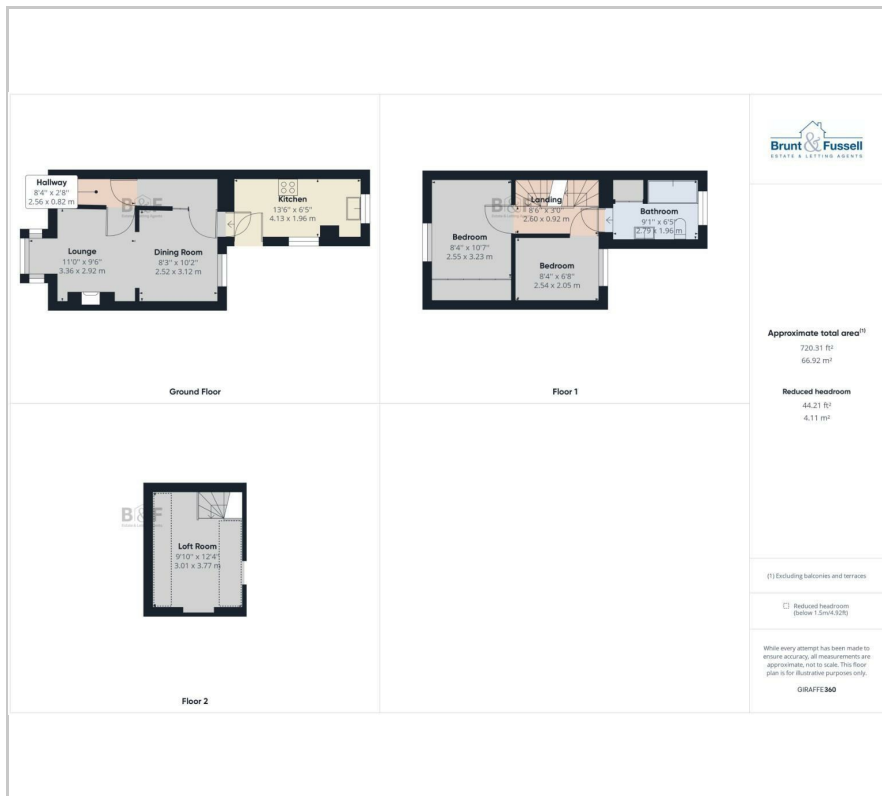

Area Map

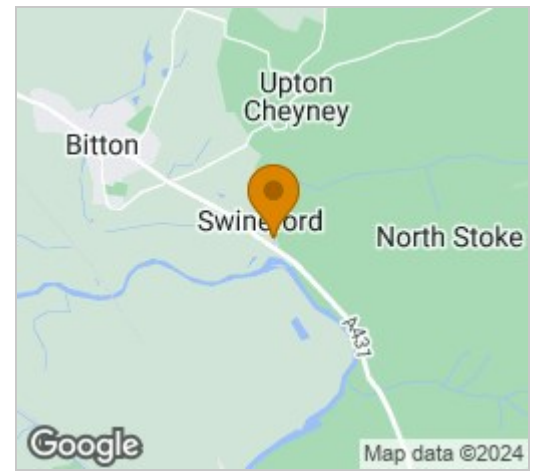

Energy Efficiency Graph

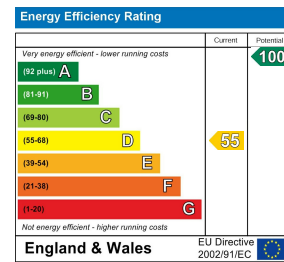

These particulars, whilst believed to be accurate are set out as a general outline only for guidance and do not constitute any part of an offer or contract. Intending purchasers should not rely on them as statements of representation of fact, but must satisfy themselves by inspection or otherwise as to their accuracy. No person in this firm's employment has the authority to make or give any representation or warranty in respect of the property.