



Mutton Lane

, Potters Bar, EN6 2AA

Guide price £220,000



GUIDE PRICE (£220,000-£240,000)

Howse-Group are delighted to offer to market is this TOP FLOOR floor studio apartment offering a large kitchen lounge sleeping area and bathroom. Located only minutes walk from Potters Bar train station and local amenities.

A perfect property for first time buyers looking to get their foot on the property ladder & investors alike!

Viewings are highly advised

call now 0208 087 3122



- ENTRANCE HALL
- LIVING ACCOMODATION
- KICTHEN
- BATHROOM



Area Map



Floor Plans

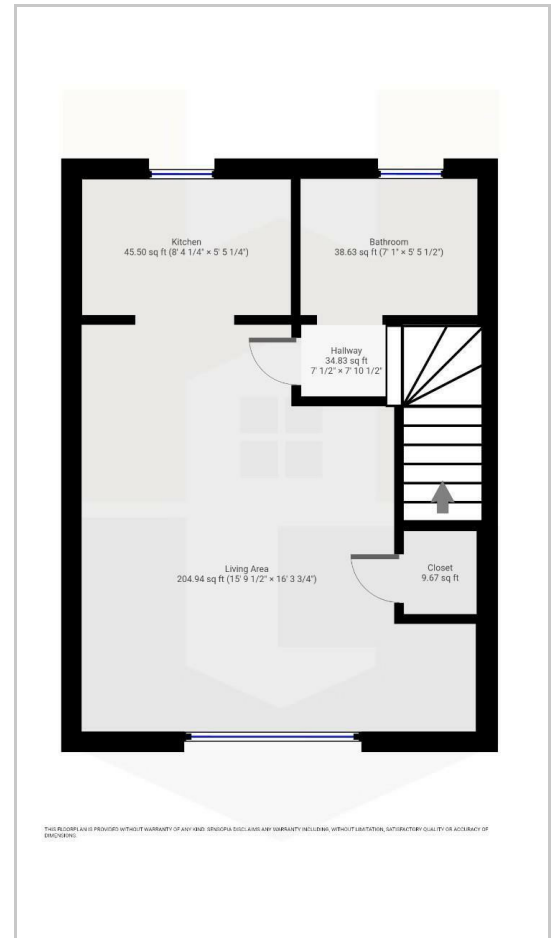

Energy Efficiency Graph

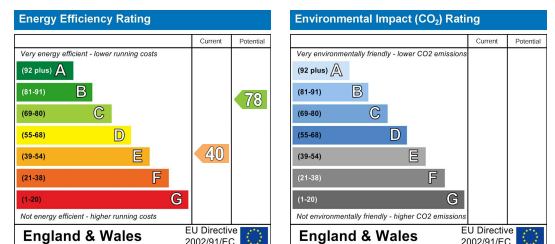

These particulars, whilst believed to be accurate are set out as a general outline only for guidance and do not constitute any part of an offer or contract. Intending purchasers should not rely on them as statements of representation of fact, but must satisfy themselves by inspection or otherwise as to their accuracy. No person in this firm's employment has the authority to make or give any representation or warranty in respect of the property.