



## Higham Station Avenue

, London, E4 9AY

Asking price £725,000



Howse-Group present to market a rare opportunity to own this 1930s four/five bedroom semi-detached property, which is located in desirable South Chingford on a tree lined residential street. Only a short walk to Chingford Mount, that has a selection of shopping and transport amenities.

This larger than average home boasts many features which include; double glazing and gas central heating. On the ground floor two reception rooms, a large kitchen diner, downstairs Wc, and bedroom/study. To the first floor four bedrooms with En-suite shower room and bathroom. Externally a double entrance private drive a converted garage and an approx. 100ft garden.

Call now to arrange a viewing

0208 087 3122



- PORCH
- RECEPTION 1
- KITCHEN DINER
- RECEPTION 2
- DOWNSTAIRS SHOWER ROOM
- BEDROOM 1
- BEDROOM 2
- BEDROOM 3
- BEDROOM 4
- BEDROOM/STUDY
- GARDEN

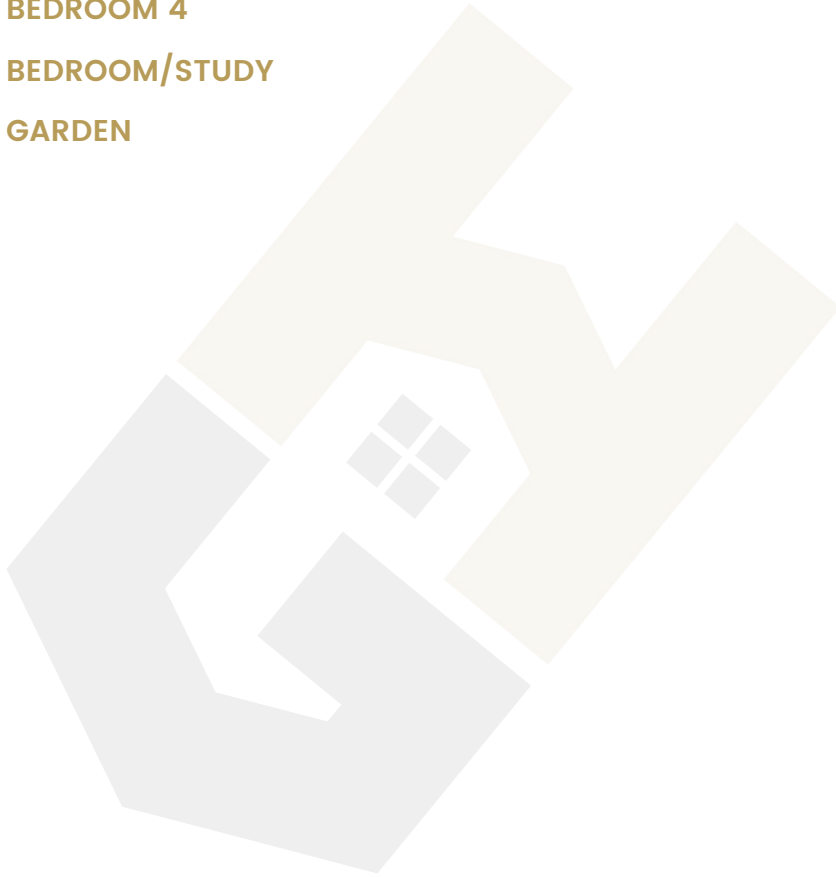

## Area Map



## Floor Plans

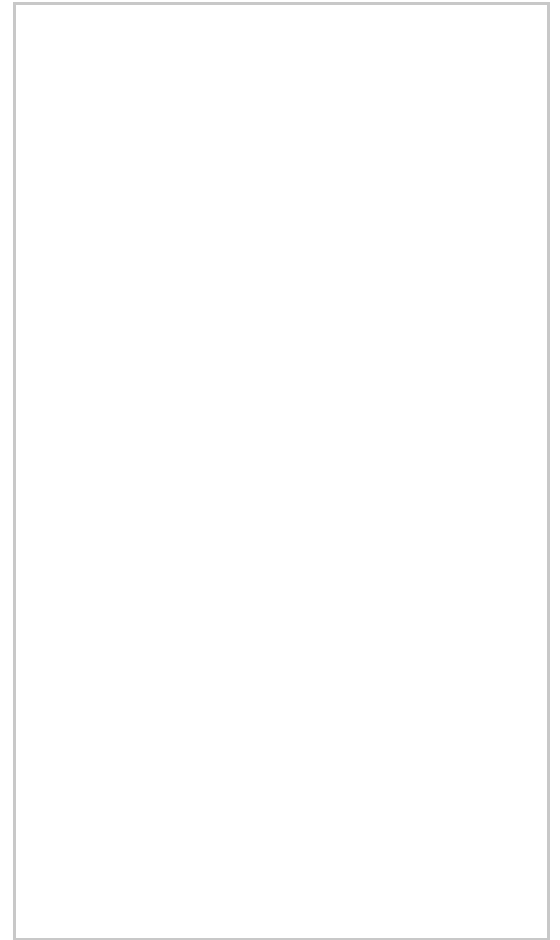

## Energy Efficiency Graph

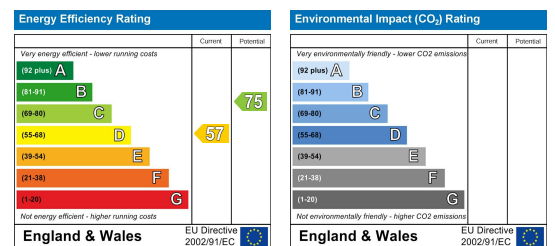

These particulars, whilst believed to be accurate are set out as a general outline only for guidance and do not constitute any part of an offer or contract. Intending purchasers should not rely on them as statements of representation of fact, but must satisfy themselves by inspection or otherwise as to their accuracy. No person in this firm's employment has the authority to make or give any representation or warranty in respect of the property.