



TO LET



6, Church House Church House, Ogleforth, York, YO1 7JN

£1,850 Per Calendar Month





THE PROPERTY

This is a fantastic opportunity to rent an extremely spacious two bedroom two bathroom apartment on the second floor of this development. With a large open plan living area and kitchen which has ample natural light with windows to two elevations and fantastic views.

The building has undergone a transformation turning it from The Chapter of York offices to a bespoke development which is set to become one of the most popular addresses in York Centre.

The apartments are finished to a high standard and are all extremely spacious with ample storage.

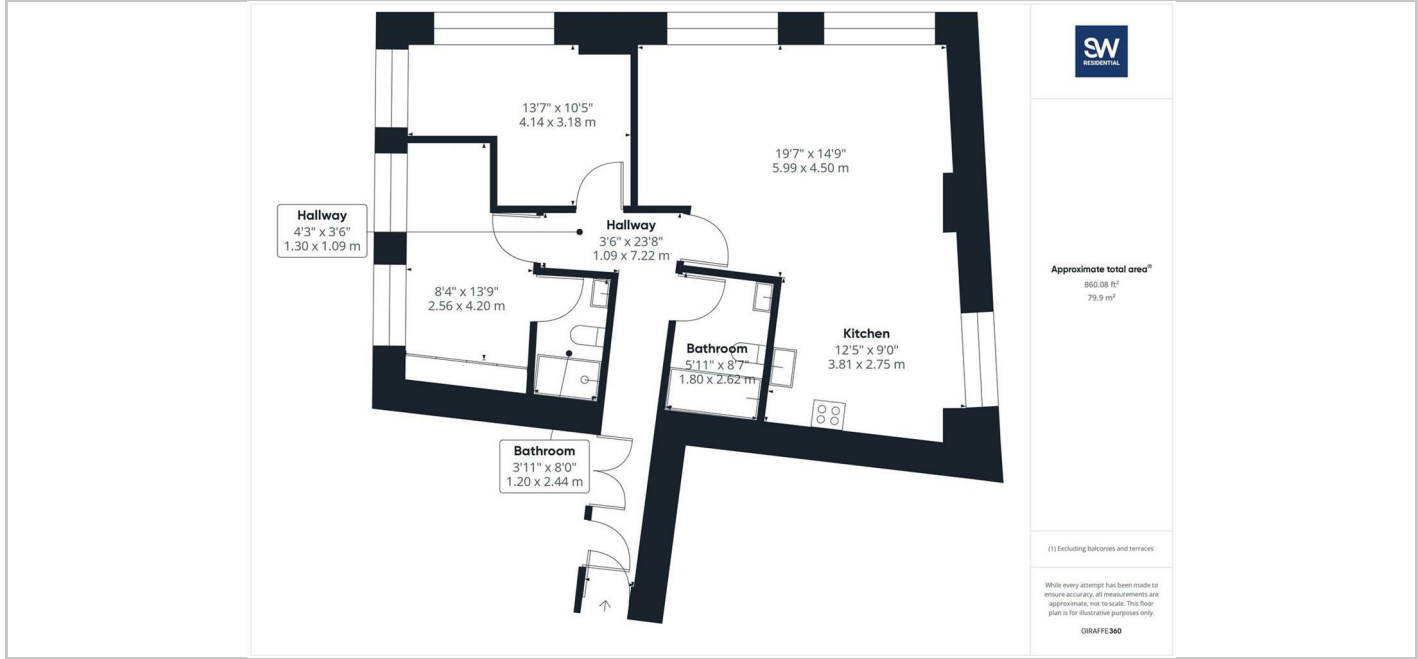

SITUATION

Directions

6th Floor Central Square, 29 Wellington Street, West Yorkshire, LS1 4DL
Tel: 0113 221 6000 Email: residential@sw.co.uk