

WE VALUE



YOUR HOME



Castle Lane, Wallingford  
£1,650 PCM

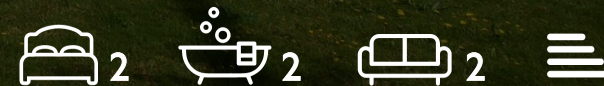



**\*\*Available immediately for Long Term Let\*\*** Located within a prestigious riverside conversion, this two bedroom, first floor apartment comes with stunning views over the river Thames & maintained communal grounds. The property has a wonderfully light dual aspect living room with feature fireplace, kitchen/breakfast room, two double bedrooms, en suite bathroom & family shower room. A dedicated carport provides off-street parking for one vehicle.







- AVAILABLE IMMEDIATELY FOR LONG-TERM LET
- FIRST FLOOR APARTMENT
- TWO DOUBLE BEDROOMS
- EN-SUITE TO MASTER
- PANORAMIC VIEWS OVER OPEN COUNTRYSIDE
- CARPORT & OFF-STREET PARKING
- LOCATED WITHIN TWO WALLINGFORD LANDMARKS



Energy Efficiency Rating		Environmental Impact (CO <sub>2</sub> ) Rating	
	Current	Potential	
Very energy efficient - lower running costs			Very environmentally friendly - lower CO <sub>2</sub> emissions
92 plus <b>A</b>			(81-91) <b>A</b>
(81-91) <b>B</b>			(61-80) <b>B</b>
(69-80) <b>C</b>			(51-60) <b>C</b>
(55-68) <b>D</b>			(39-50) <b>D</b>
(39-54) <b>E</b>			(29-38) <b>E</b>
(21-38) <b>F</b>			(21-28) <b>F</b>
(1-20) <b>G</b>			(1-20) <b>G</b>
Not energy efficient - higher running costs			Not environmentally friendly - higher CO <sub>2</sub> emissions
<b>England &amp; Wales</b>	EU Directive 2002/91/EC		<b>England &amp; Wales</b>
			EU Directive 2002/91/EC

Energy Efficiency Graph



## Floor Plan

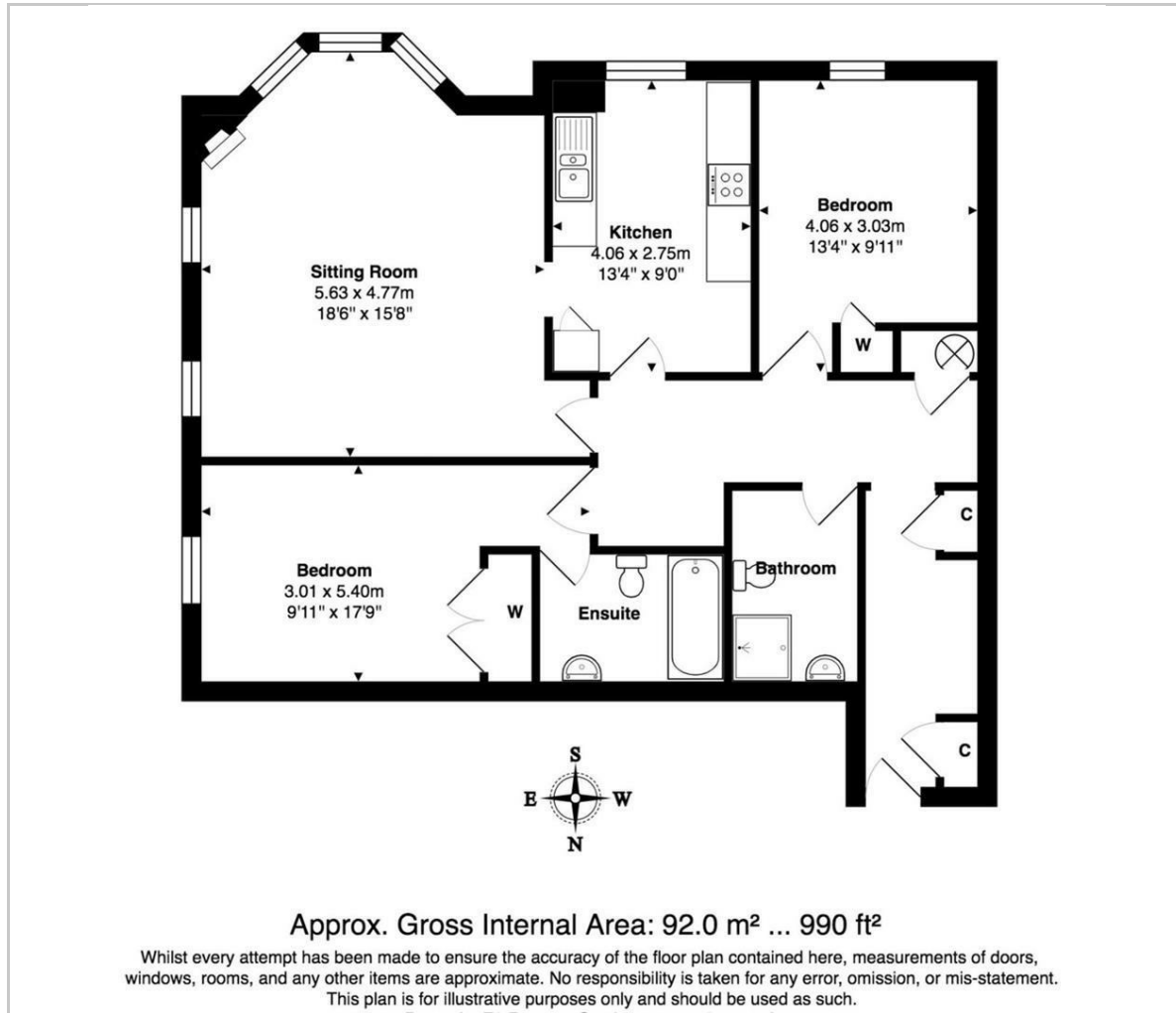

## Area Map

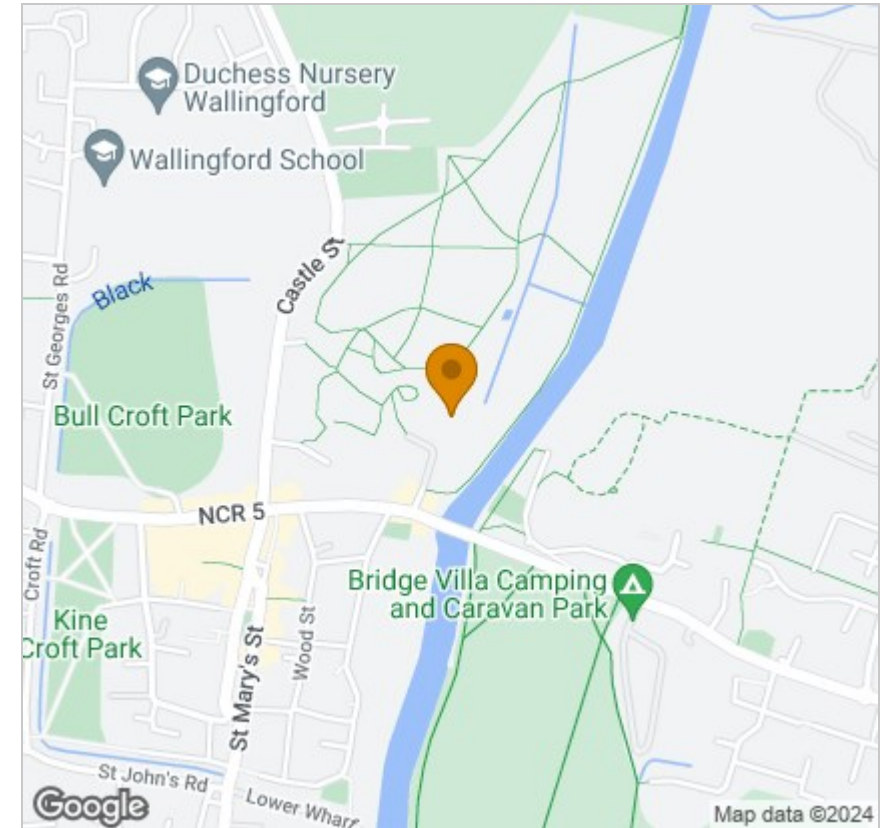

## Viewing

Please contact our In House Sales & Lettings Office on 01491 839999 opt.1 if you wish to arrange a viewing appointment for this property or require further information.

These particulars, whilst believed to be accurate are set out as a general outline only for guidance and do not constitute any part of an offer or contract. Intending purchasers should not rely on them as statements of representation of fact, but must satisfy themselves by inspection or otherwise as to their accuracy. No person in this firm's employment has the authority to make or give any representation or warranty in respect of the property.

28 St Martins Street, Wallingford, Oxfordshire, OX10 0AL  
Tel: 01491 839999 opt.1 Email: [sales@inhouseestateagents.co.uk](mailto:sales@inhouseestateagents.co.uk) [www.inhouseestateagents.co.uk](http://www.inhouseestateagents.co.uk)