

WE VALUE



YOUR HOME



High Street, Wallingford
Offers Over £1,000,000



Fairford House is a beautiful example of a detached property and comes with a wealth of homely features and ample space for all the family. Conveniently located just a stones throw from Wallingford's town centre amenities, parks and schools, this family home features four reception rooms including a sunroom, a stunning landscaped rear garden, four double bedrooms with two en-suites and a family bathroom, and both off-street parking and a garage. If you are looking for a forever home where you can create memories for generations to come, this property could be the perfect find.





- DETACHED FOUR-BEDROOM FAMILY HOME
- WELL-PRESENTED WITH SPACIOUS ROOM SIZES
- TWO EN-SUITES AND FAMILY BATHROOM
- STUNNING LANDSCAPED REAR GARDEN
- OFF-STREET PARKING & GARAGE
- FOUR RECEPTION ROOMS
- UTILITY ROOM & CLOAKROOM
- CLOSE TO PARKS, SCHOOLS AND TOWN CENTRE AMENITIES

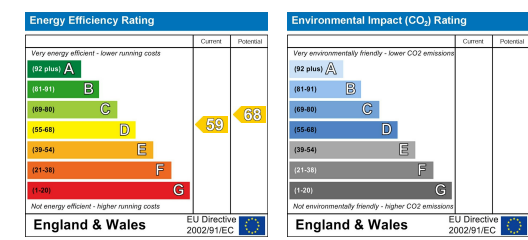

Energy Efficiency Graph

Floor Plan

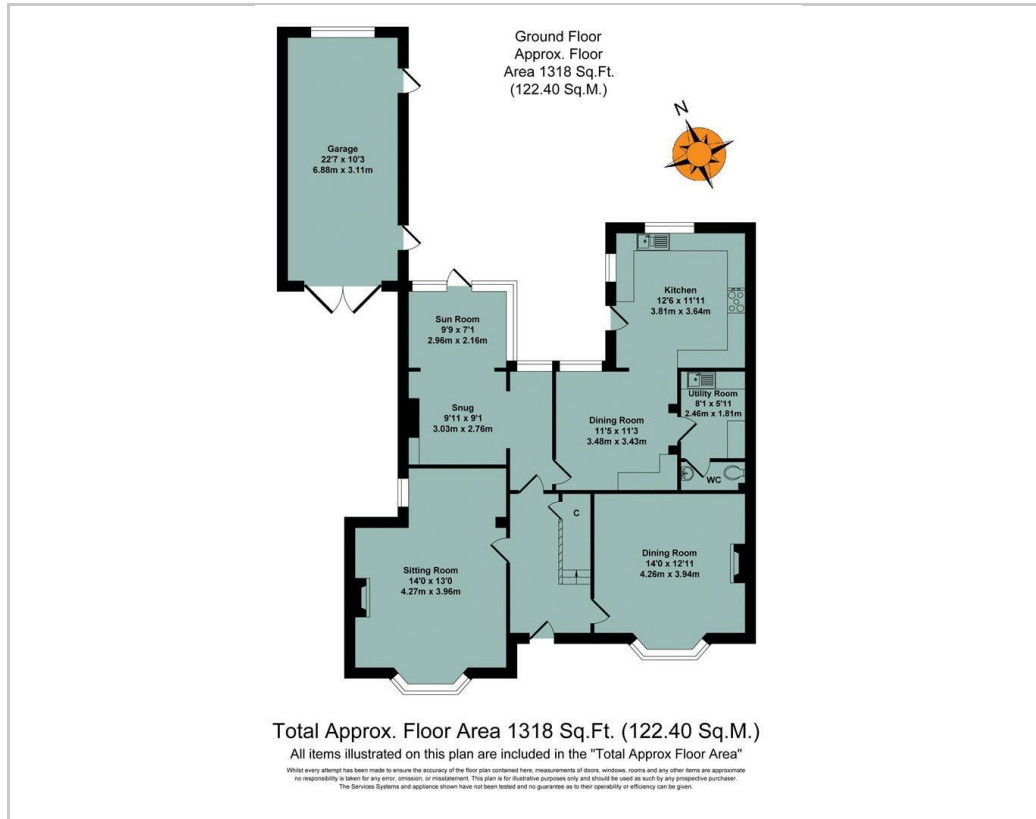

Floor Plan

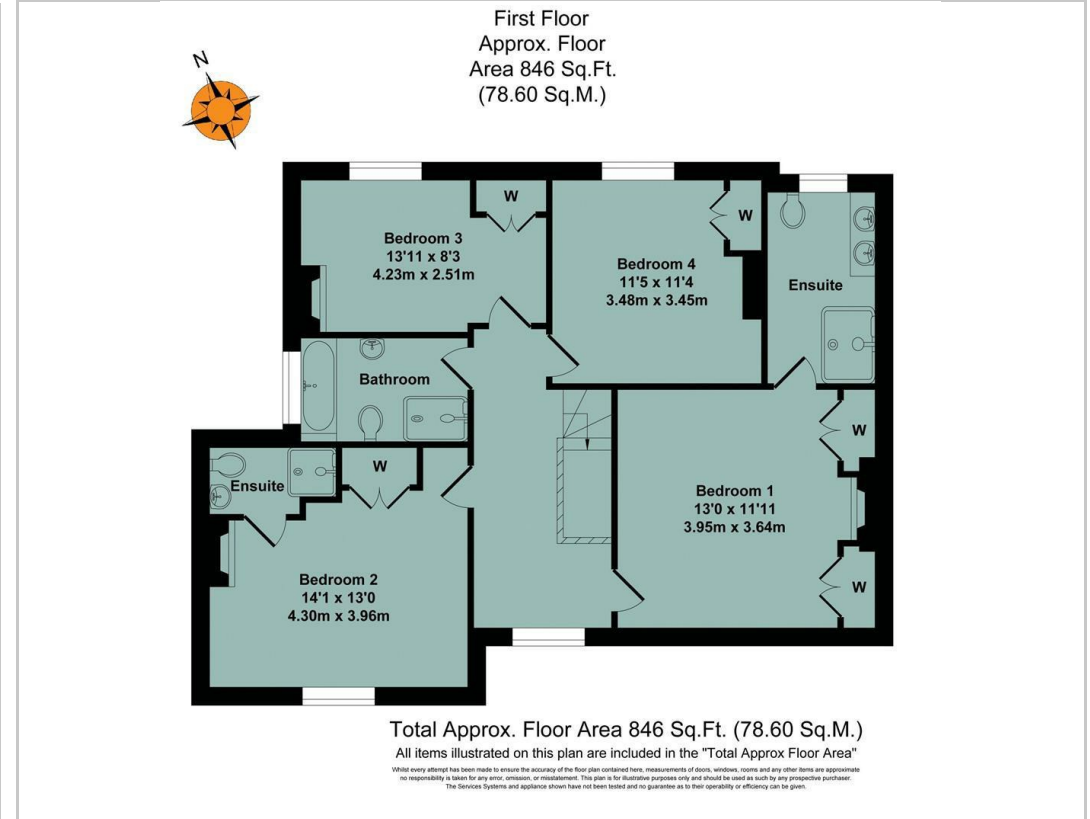

Viewing

Please contact our In House Sales & Lettings Office on 01491 839999 opt.1 if you wish to arrange a viewing appointment for this property or require further information.

These particulars, whilst believed to be accurate are set out as a general outline only for guidance and do not constitute any part of an offer or contract. Intending purchasers should not rely on them as statements of representation of fact, but must satisfy themselves by inspection or otherwise as to their accuracy. No person in this firms employment has the authority to make or give any representation or warranty in respect of the property.

28 St Martins Street, Wallingford, Oxfordshire, OX10 0AL
Tel: 01491 839999 opt.1 Email: sales@inhouseestateagents.co.uk www.inhouseestateagents.co.uk