

WE VALUE



YOUR HOME



Lodden Avenue, Berinsfield
Offers Over £300,000



Located on a generous end plot with views of the playing fields, this three-bedroom family home has been renovated throughout and features a modern open-plan living space with a neutral and stylish decor. Benefitting from front and rear gardens, allocated parking for two vehicles and coming to the market with no onward chain, this well-located property is ideal for families looking for a practical family home within easy reach of the village's many amenities and great transport links to nearby towns and cities.





- NO ONWARD CHAIN
- WELL-PRESENTED & RENOVATED THROUGHOUT
- GENEROUS FRONT & REAR GARDENS
- SPACIOUS OPEN PLAN LAYOUT TO THE GROUND FLOOR
- THREE BEDROOMS
- ALLOCATED PARKING FOR TWO VEHICLES
- OUTLOOK OVER GREEN SPACE TO THE REAR
- CLOSE TO AMENITIES & TRANSPORT LINKS

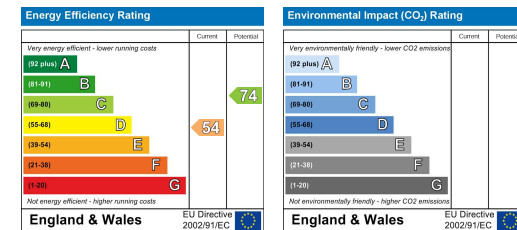

Energy Efficiency Graph

Floor Plan

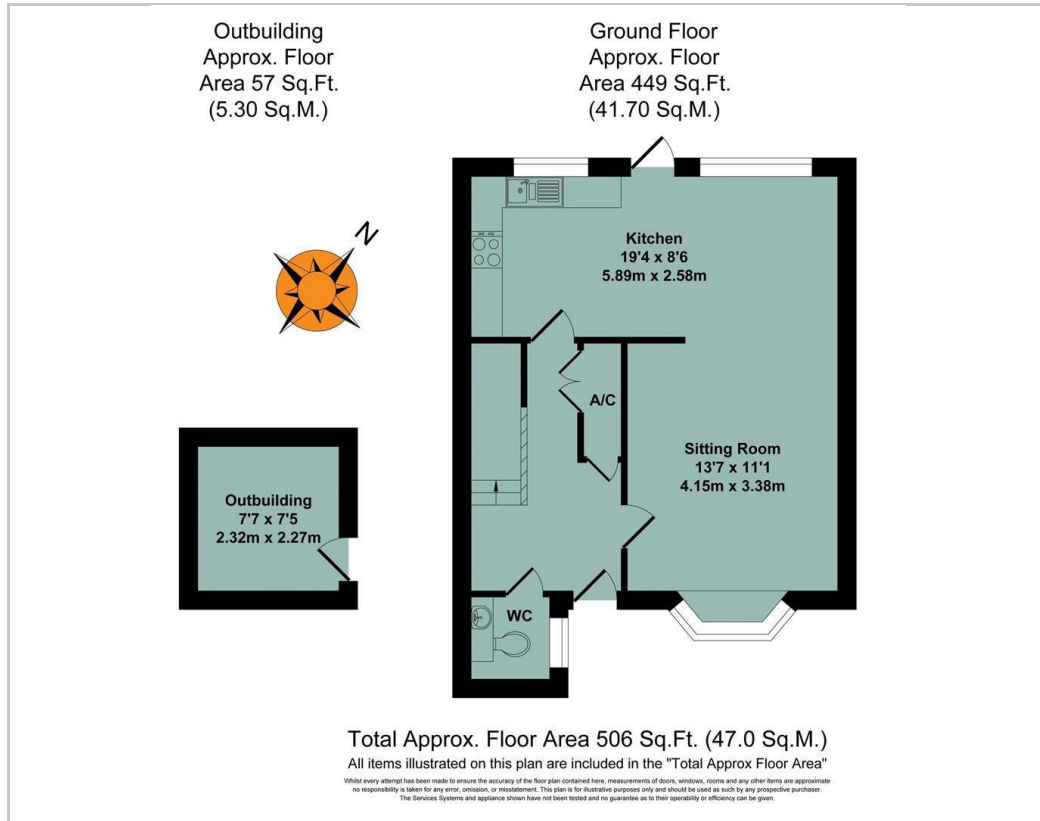

Floor Plan

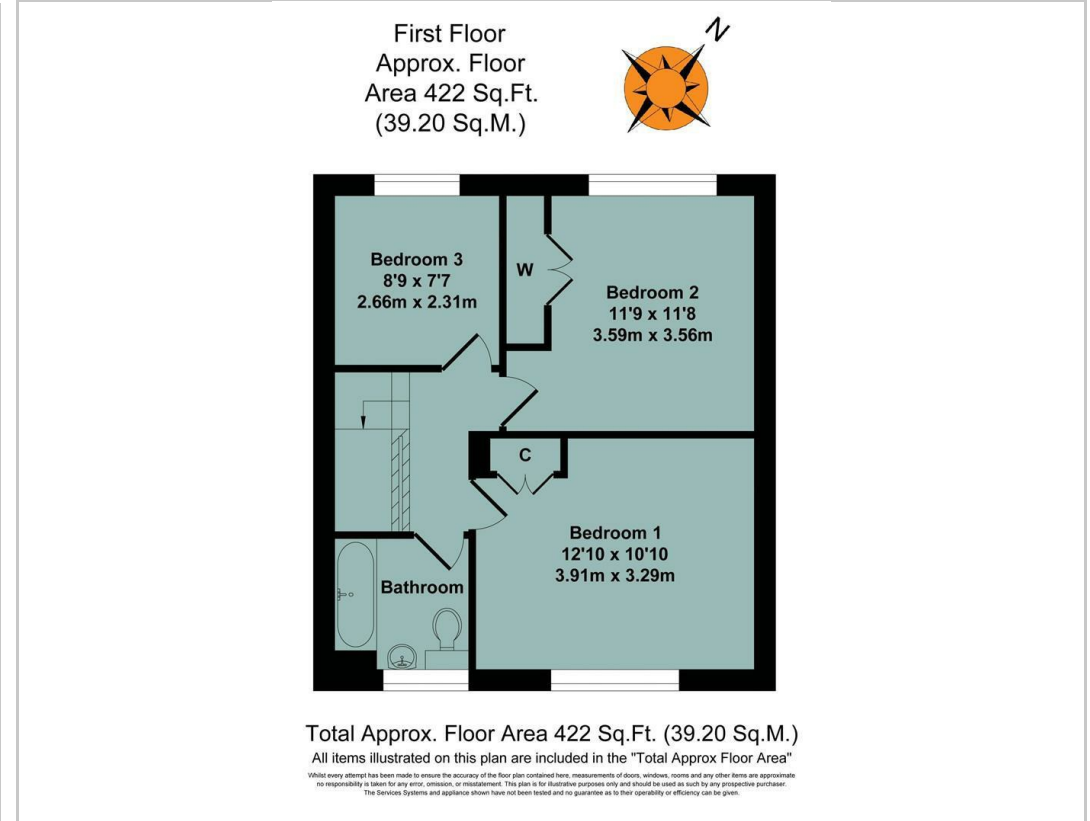

Viewing

Please contact our In House Sales & Lettings Office on 01491 839999 opt.1
if you wish to arrange a viewing appointment for this property or require further information.

These particulars, whilst believed to be accurate are set out as a general outline only for guidance and do not constitute any part of an offer or contract. Intending purchasers should not rely on them as statements of representation of fact, but must satisfy themselves by inspection or otherwise as to their accuracy. No person in this firms employment has the authority to make or give any representation or warranty in respect of the property.

28 St Martins Street, Wallingford, Oxfordshire, OX10 0AL
Tel: 01491 839999 opt.1 Email: sales@inhouseestateagents.co.uk www.inhouseestateagents.co.uk