

Austerberry™

the best move you'll make

Estate Agents

Letting and Management Specialists



28 Silsden Grove, Meir, Stoke-On-Trent, ST3 6RL

£130,000

- Watch Our Online Video Tour!
- Fitted Kitchen
- Recent Combi Boiler in Loft
- Double Glazed Conservatory
- Plenty Of Off Road Parking Space
- Fully Updated And Refurbished
- Modern Shower Room
- UPVC Double Glazing
- One Bedroom

Ideal for a single person or a couple and a semi-detached bungalow that definitely won't disappoint you!

This property has been completely refurbished and updated in recent years to include replastering, a combi boiler in the loft, fully fitted kitchen and newly fitted shower room.

There's UPVC double glazing throughout and as well as a double glazed conservatory at the rear accessed from the double bedroom there is also a useful conservatory/porch to the side of the property.

This bungalow has plenty of off road parking space at the front and side and a low maintenance rear garden. It is in a cul-de-sac location.

See our online virtual tour and for more information call or e-mail us.



ACCOMMODATION

GROUND FLOOR

CONSERVATORY/PORCH

10'5" x 7'1" (3.18 x 2.16)

Tiled floor. Radiator. UPVC double glazed doors to the front and rear. UPVC double glazed windows with fitted vertical blinds. Worktop/breakfast bar. UPVC double glazed door leading into the...

ENTRANCE HALL

Grey laminate flooring. Radiator. Spotlights. Storage cupboard.

LOUNGE/DINING ROOM

14'11" x 9'3" (4.55 x 2.82)

Fitted carpet. Radiator. UPVC double glazed window with fitted vertical blinds. Feature fireplace with living flame effect electric fire.

MODERN FITTED KITCHEN

11'11" x 5'1" (3.63 x 1.55)

Grey laminate flooring. Excellent range of wall cupboards and base units with soft close doors and drawers as well as integrated electric hob, stainless steel cooker hood and eye level oven. Plumbing for washing machine. UPVC double glazed window with fitted vertical blinds. Spotlights. Part tiled walls.

BEDROOM

12'3" x 8'9" (3.73 x 2.67)

Fitted carpet. Radiator. UPVC double glazed window. Door into the...

CONSERVATORY/PORCH

13'6" x 9'9" (4.11 x 2.97)

Grey laminate flooring. Radiator. UPVC double glazed windows with fitted vertical blinds. Door into the garden.

MODERN SHOWER ROOM

6'11" x 5'6" (2.11 x 1.68)

Grey vinyl flooring. Part tiled walls. Stainless steel centrally heated towel rail radiator. UPVC double glazed window. White suite featuring a room width shower together with wc and wash basin within a fitted unit.

OUTSIDE

There is a tarmac driveway and additional paved parking space at the front of the bungalow. To the rear is a very pleasant low maintenance garden with a large shed and an outside tap.



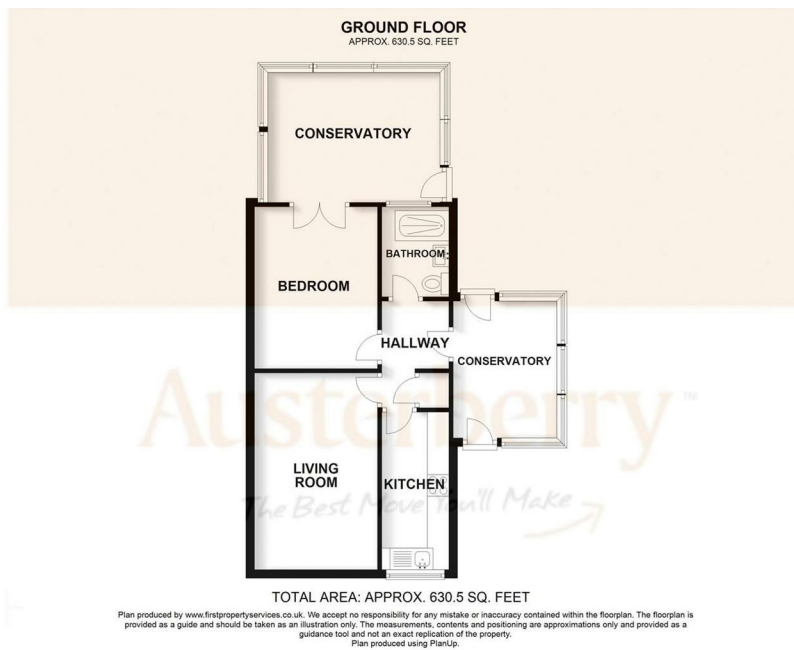

MATERIAL INFORMATION

Tenure - Freehold
Council Tax Band - A

PLEASE NOTE

- * These sales particulars have been prepared as a general guide and are not to be relied upon as part of the contract for sale. Room sizes should not be relied upon for carpets and furnishings.
- Floor plans (where provided) are intended as a guide to layout only and are not to scale.
- We have not carried out a detailed survey nor tested the services, appliances and specific fittings.
- We would be happy to make referrals for financial and legal services if required. At no time are you obligated to use any of the services we recommend. We work with a panel of mortgage brokers and we expect to receive a payment of up to £100 (inc VAT) as a referral fee for financial services. We also work with a panel of various solicitors and we expect to receive a payment of up to £150 (inc VAT) as a referral fee for legal services.

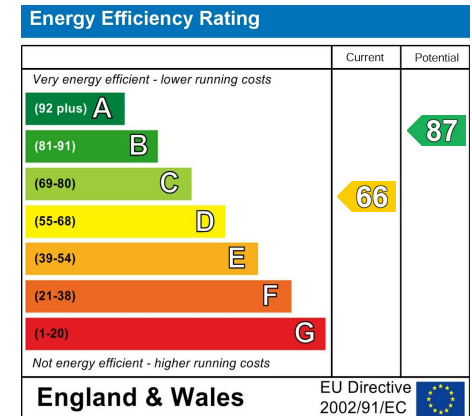

To arrange a viewing or for any further information, please contact Austerberry on 01782 594595 or e-mail enquiries@austerberry.co.uk

Austerberry[™]
the best move you'll make