



**1 Bed
Apartment - Studio
located in**

**Offers In The Region Of
£149,995**



briggs & mortimer
HYBRID

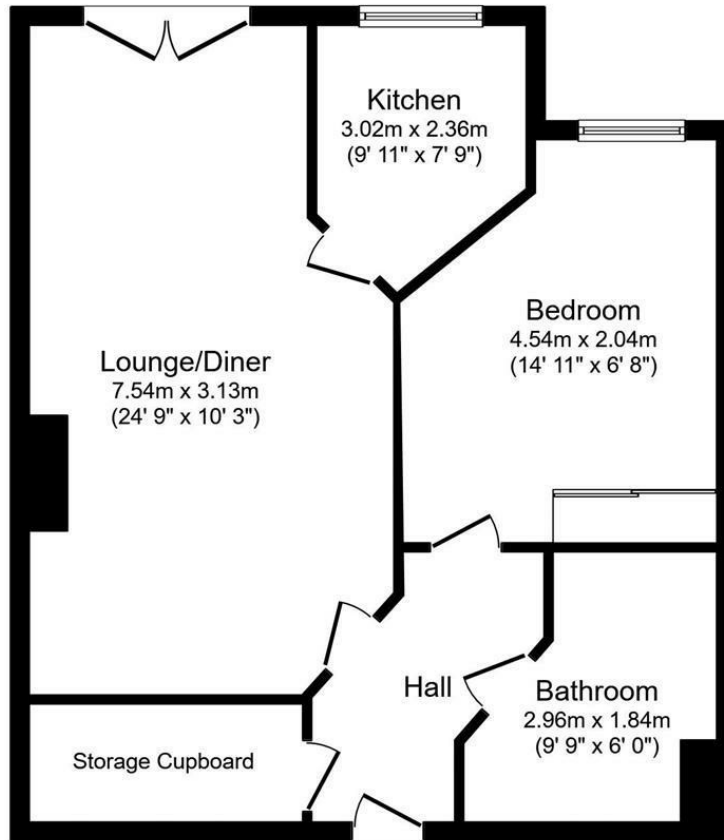

First Floor Plan

Total floor area 67.0 sq. m. (721 sq. ft.) approx

This plan is for illustration purposes only and may not be representative of the property. Plan not to scale.

Printed Contact Details...

DIRECTIONS

CONTACT

20 Market Hill
Royston
SG89JG

E: sales@briggsandmortimer.co.uk
T: 01763242626
<https://www.briggsandmortimer.co.uk/>

| Energy Efficiency Rating | | |
|---|---------|-----------|
| | Current | Potential |
| Very energy efficient - lower running costs | | |
| (92 plus) A | | |
| (81-91) B | | |
| (69-80) C | | |
| (55-68) D | | |
| (39-54) E | | |
| (21-38) F | | |
| (1-20) G | | |
| Not energy efficient - higher running costs | | |
| England & Wales <small>EU Directive 2002/91/EC</small> | | |