



Westminster Gardens

Marsham Street, Westminster, SW1P 4JG

£1,500 Per Week



Floor Plan

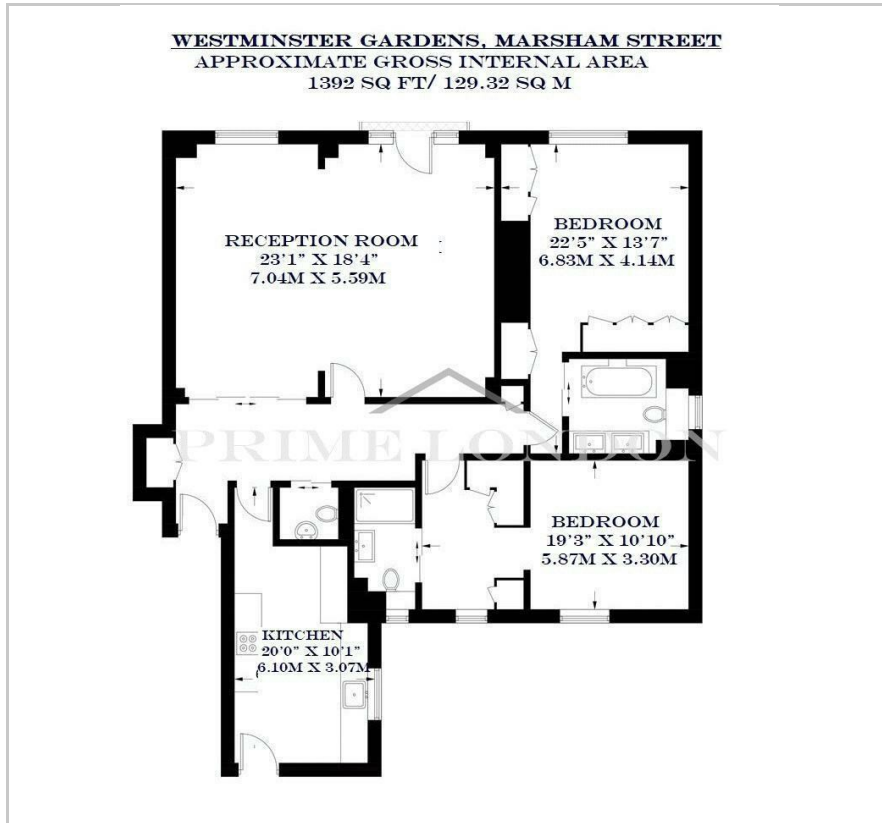

Area Map



Energy Efficiency Graph

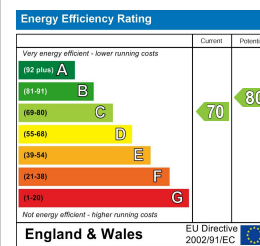

Viewing

By appointment. Contact us on 0207 052 1075 if you wish to arrange a viewing appointment for this property, or require further information.

- Large two bedroom ■ 1,392 sq ft / 129.32 sq m apartment
- Beautifully interior designed ■ Communal roof terrace and fully furnished
- Off street parking ■ 24 hour concierge

This beautifully interior designed and fully furnished 1,392 sq ft / 129.32 sqm two bedroom apartment in the prestigious Westminster Gardens (a lovely Art Deco building in sought after Westminster area and just a stone's throw away from the Palace of Westminster and Westminster Abbey) is available to rent through Prime London.

Situated on the fifth floor (with the building enjoying the conveniences of a lift) the apartment comprises a generous open plan living room and dining area with Juliette balcony, spacious master bedroom with bespoke fitted wardrobes and ensuite marble bathroom, a second large double bedroom with a private study or dressing area and a further en suite bathroom.

Down the hallway you will find a separate guest WC as well as the family sized kitchen which is separate from the reception, and offers modern built-in appliances, granite work tops and ample storage. Residents of the building will further benefit from the use of a communal roof terrace, unallocated off street parking and 24 hour concierge.



These particulars, whilst believed to be accurate are set out as a general outline only for guidance and do not constitute any part of an offer or contract. Intending purchasers should not rely on them as statements of representation of fact, but must satisfy themselves by inspection or otherwise as to their accuracy. No person in this firm's employment has the authority to make or give any representation or warranty in respect of the property.