

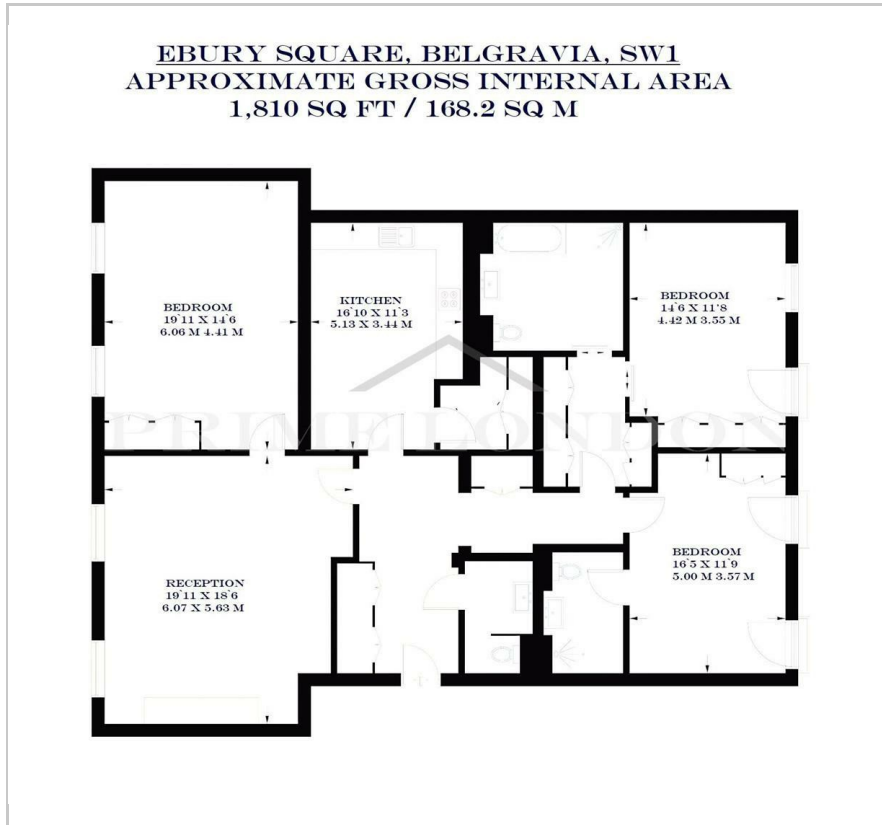

Ebury Square  
Belgravia, SW1W 9AH  
£4,615 Per Week

## Floor Plan



## Area Map

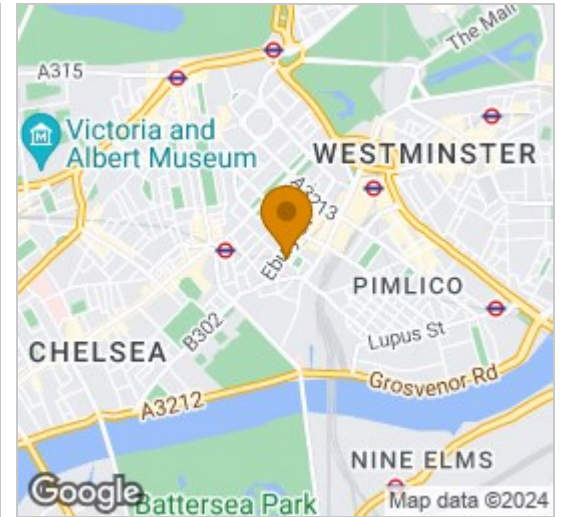

## Energy Efficiency Graph



## Viewing

By appointment. Contact us on 0207 052 1075 if you wish to arrange a viewing appointment for this property, or require further information.

- Elegant three bedroom ▪ 1,810 sq ft / 168.2 sq m apartment
- Moments from Victoria ▪ Secure parking Station
- Residents' gym and spa ▪ 24 hour concierge

This beautiful contemporary three bedroom apartment, set in this prestigious Belgravia development Ebury Square, is available for short term rent through Prime London.

The property also comes with secure parking. This raised ground floor property is finished to the highest specification and comprises of a bright reception room boasting elegant décor and space for dining, as well as floor to ceiling windows flooding the room with natural light. The well-appointed kitchen features a wealth of storage and modern fixtures, including a separate utility room. The principal bedroom features an en suite bathroom with a shower and a luxurious walk-through wardrobe, whilst two further bedrooms (one en suite) offer spacious accommodation with stylish built-in wardrobes and shelving. In addition, the property has a guest cloakroom, whilst the building offers use of the lift and concierge service.

Ebury Square is a prestigious development located in Belgravia, known for its village-like feel, fine restaurants and boutiques. This modern block provides a 24 hour concierge service, secure underground parking, valet parking, lift, and a private resident's gym. Situated approximately 0.4 miles from both Victoria Station (Victoria, District and Circle lines) and Sloane Square (District and Circle lines), Ebury Square offers easy access to all of London and destinations beyond.



These particulars, whilst believed to be accurate are set out as a general outline only for guidance and do not constitute any part of an offer or contract. Intending purchasers should not rely on them as statements of representation of fact, but must satisfy themselves by inspection or otherwise as to their accuracy. No person in this firm's employment has the authority to make or give any representation or warranty in respect of the property.

21 Grosvenor Gardens, Belgravia, London SW1W 0BP | Palace View, 131 Lambeth Road, London SE1 7BT

Tel: 0207 052 1075 | 0207 928 6663 Email: Office@PrimeLondonResidential.com www.PrimeLondonResidential.com