



10

Abbey Orchard Street, Westminster, SW1P 2JP

£1,200 Per Week



2



2



1



C

## Floor Plan

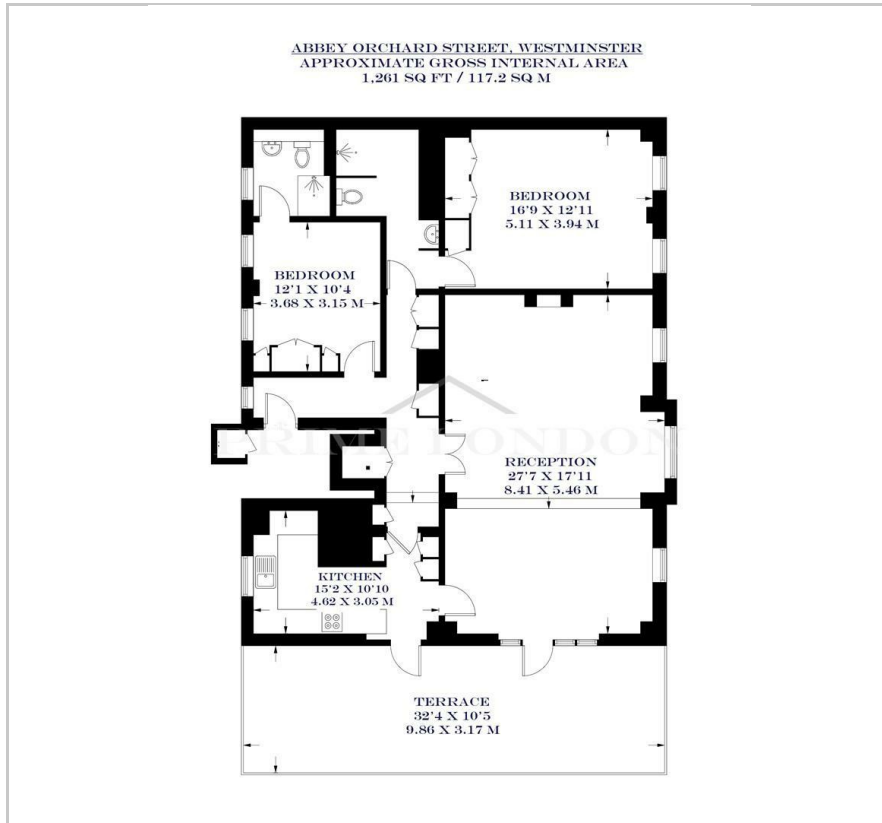

## Area Map



## Energy Efficiency Graph

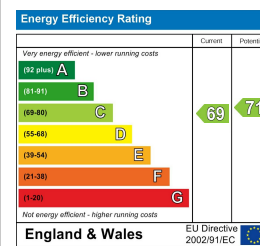

## Viewing

By appointment. Contact us on 0207 052 1075 if you wish to arrange a viewing appointment for this property, or require further information.

- Spacious penthouse apartment
- Sizable south-facing terrace
- Lift access directly into the apartment
- Fully furnished
- 1,272 sq ft (118.20 sq m)
- Equipped with generous built-in storage
- Parking
- Available now

A remarkable and spacious two-bedroom penthouse apartment, spanning 1,272 sq ft (118.20 sq m) and located at 10 Abbey Orchard Street, is available for lease through Prime London.

This exceptional penthouse apartment exudes charm and character, seamlessly blending elegant period design with contemporary fixtures and fittings. The apartment comprises two generously sized double bedrooms, each equipped with ample built-in storage and accompanying ensuite bathrooms. Additionally, it features a reception/dining room, a separate fully-fitted kitchen, and a sizable south-facing terrace. Further enhancing its appeal, the apartment offers lift access directly and garaged parking for one car.

Nestled in the central hub of Westminster, 10 Abbey Orchard Street provides proximity to numerous amenities, restaurants, cafes, and shops in Victoria, Westminster, and Pimlico. Convenient transport links are available, with the Circle & District Lines (St James's Park) and Jubilee Line (Westminster) both situated approximately 0.3 miles away.



These particulars, whilst believed to be accurate are set out as a general outline only for guidance and do not constitute any part of an offer or contract. Intending purchasers should not rely on them as statements of representation of fact, but must satisfy themselves by inspection or otherwise as to their accuracy. No person in this firm's employment has the authority to make or give any representation or warranty in respect of the property.