

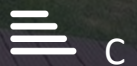

Marina Point

Lensbury Avenue, Imperial Wharf, SW6 2GX

£830 Per Week



Floor Plan

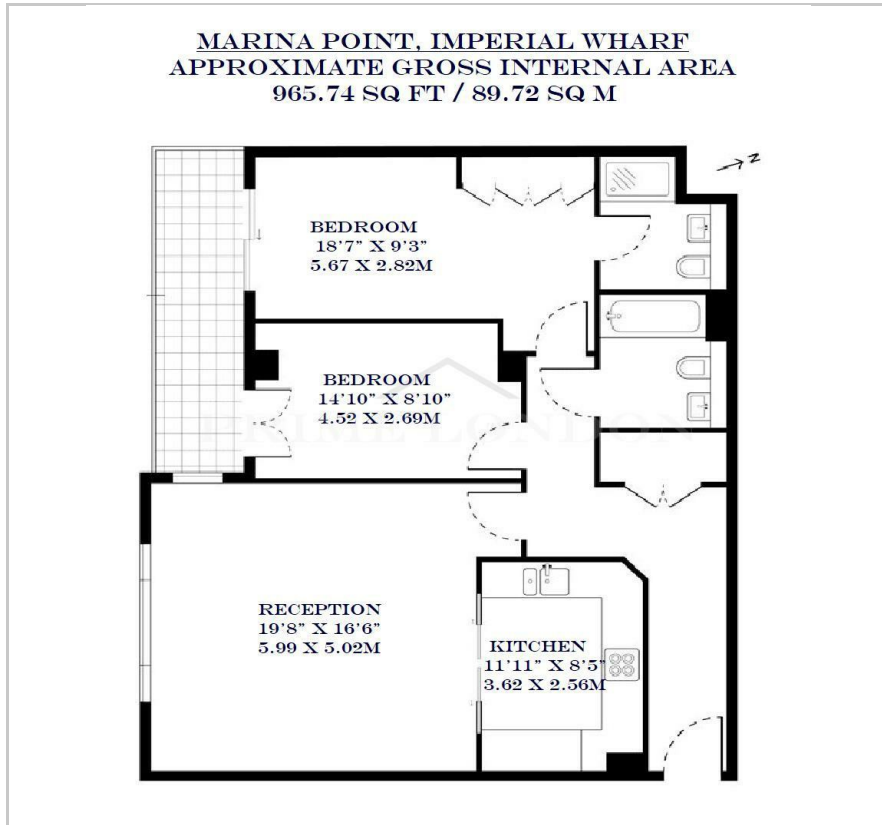

Area Map



Energy Efficiency Graph

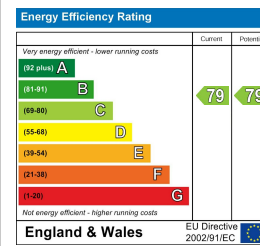

Viewing

By appointment. Contact us on 0207 052 1075 if you wish to arrange a viewing appointment for this property, or require further information.

- Modern two bedroom apartment
- Private terrace
- Next to the River Thames
- Close to Imperial Wharf station and the pier
- Resident's gym
- 24 hour concierge

This spacious and modern two bedroom apartment, featuring a large private balcony overlooking the communal gardens and positioned next to the River Thames, is available to rent through Prime London Residential.

The apartment offers a large living area with contemporary features and wooden flooring, a modern fully fitted semi open plan kitchen, and a large private balcony providing a delightful outdoor space for relaxation. The property further comprises two double bedrooms, two bathrooms (one of which is en suite) and plenty of extra storage space. The development also features a 24-hour concierge and residents' gym.

Imperial Wharf is ideally positioned in close proximity to the River Thames, Imperial Park, and South Park. Residents can easily access a variety of amenities along Wandsworth Bridge Road, and the convenience of Imperial Wharf Station (0.2 miles) and the pier in close proximity adds to the appeal of this property.



These particulars, whilst believed to be accurate are set out as a general outline only for guidance and do not constitute any part of an offer or contract. Intending purchasers should not rely on them as statements of representation of fact, but must satisfy themselves by inspection or otherwise as to their accuracy. No person in this firm's employment has the authority to make or give any representation or warranty in respect of the property.