

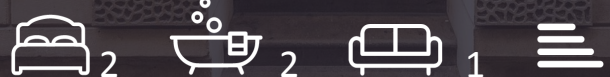

10 -13 Lovat Lane

Monument, EC3R 8DT

£675 Per Week



Floor Plan

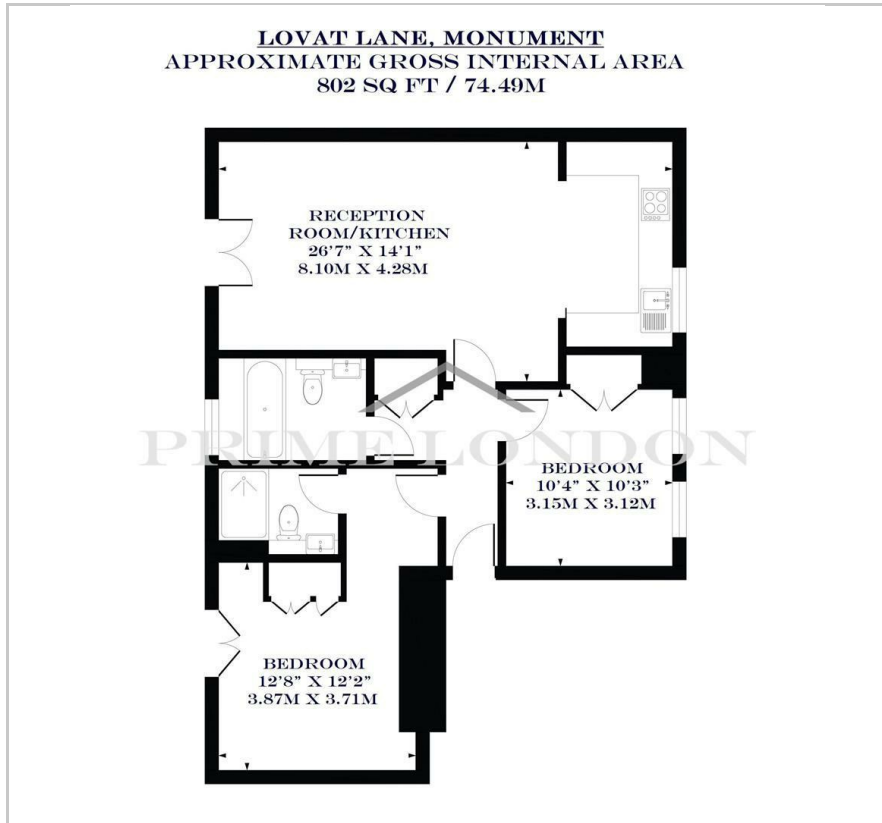

Area Map



Energy Efficiency Graph

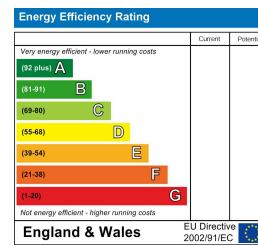

Viewing

Please contact our on 0207 052 1075 if you wish to arrange a viewing appointment for this property or require further information.

- Two bed two bath
- Fully furnished
- On a quiet, cobbled street
- 802 sq ft (74.49 sqm)
- Two Juliette balconies
- Close to Monument Underground

This spacious two bedroom two bathroom apartment, located only moments away from Monument, Tower Hill, and London Bridge, comes fully furnished and is available to rent through Prime London.

The 802 sq ft (74.49 sqm) apartment is in extremely good condition, and benefits from an open plan living and kitchen space and modern fixtures and fittings throughout.

The apartment also has two bathrooms and two Juliette balconies. Situated on a quiet, cobbled street this apartment is nestled away from the hustle and bustle the City offers whilst still be ideally located for City works and commuters alike.



These particulars, whilst believed to be accurate are set out as a general outline only for guidance and do not constitute any part of an offer or contract. Intending purchasers should not rely on them as statements of representation of fact, but must satisfy themselves by inspection or otherwise as to their accuracy. No person in this firm's employment has the authority to make or give any representation or warranty in respect of the property.