

Carlton Mansions

16 York Buildings, London, WC2N 6LS

£646 Per Week

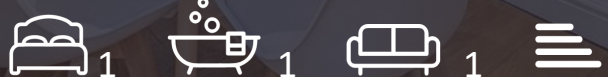

Floor Plan

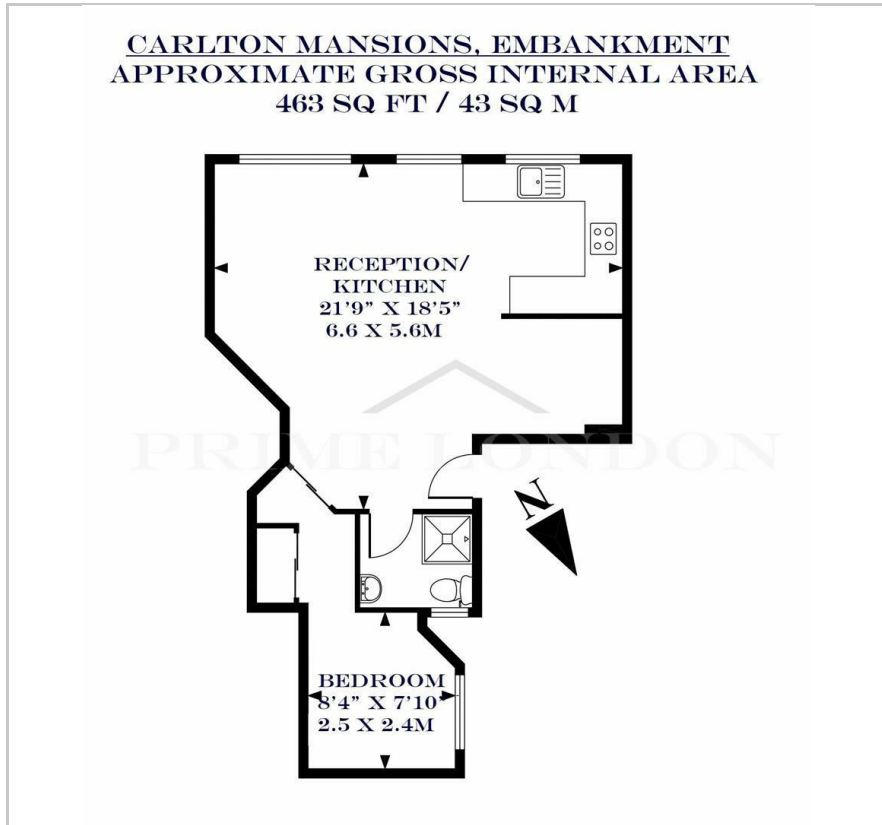

Area Map



Energy Efficiency Graph



Viewing

By appointment. Contact us on 0207 052 1075 if you wish to arrange a viewing appointment for this property, or require further information.

- Beautiful one bedroom flat
- Centrally Located
- Quiet area
- 465 sq ft (43.19 sqm)
- Fully furnished
- Moments from the River Thames and Trafalgar Square



Available now. This one-bedroom apartment, nestled in the charming area of Charing Cross, offers a delightful living experience just a stone's throw away from local cafes and restaurants and is available for a seven-month rent through Prime London. The property boasts a lively living room, a fully equipped kitchen, and a bright bedroom furnished with a queen-size bed and a bathroom. This apartment combines comfort, convenience, and a prime location, making it an excellent choice for those seeking a Central London living experience. Situated just 200 metres from Charing Cross and Embankment tube station, you can access the Bakerloo, Circle, Northern and District Lines, allowing easy and quick access to London's famous streets and landmarks. This area surrounding your property is full of cafes, restaurants, shops, and supermarkets, making it easy to enjoy coffee, lunch, and dinner out within the vibrant area. To further discover London heritage, you can also visit several museums like the British Museum, the Natural History Museum, the Victoria & Albert Museum, the Science Museum, and the Leighton House Museum.



These particulars, whilst believed to be accurate are set out as a general outline only for guidance and do not constitute any part of an offer or contract. Intending purchasers should not rely on them as statements of representation of fact, but must satisfy themselves by inspection or otherwise as to their accuracy. No person in this firm's employment has the authority to make or give any representation or warranty in respect of the property.