



Luke House

Abbey Orchard Street, Westminster, SW1P 2JJ

£1,095 Per Week



Floor Plan

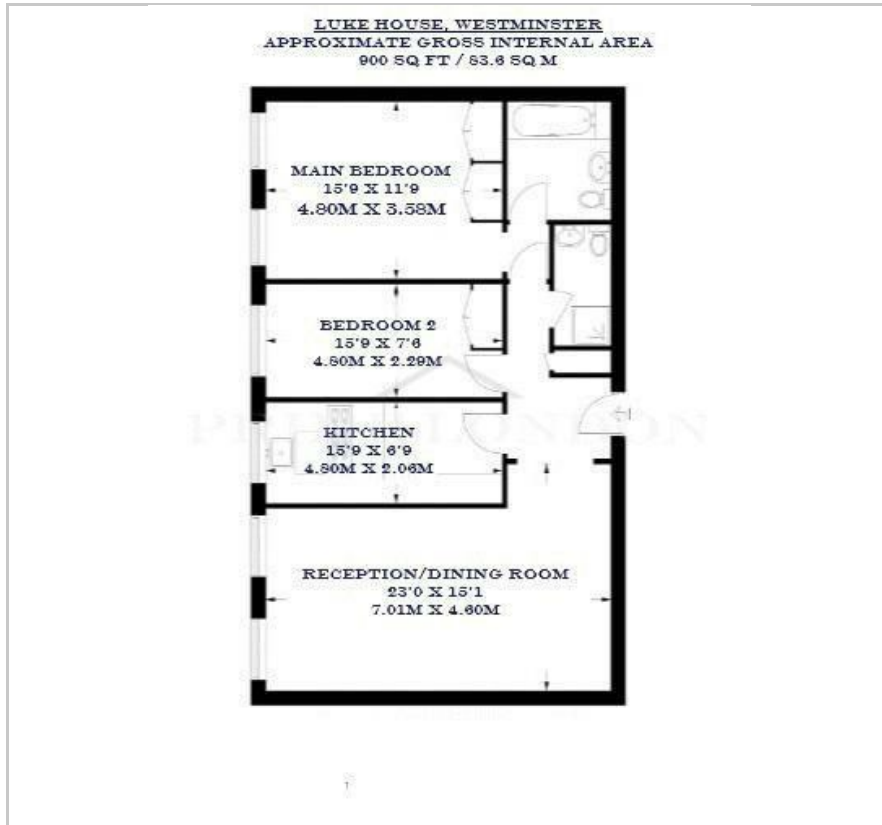

Area Map



Energy Efficiency Graph



Viewing

By appointment. Contact us on 0207 052 1075 if you wish to arrange a viewing appointment for this property, or require further information.

- Two double bedrooms
- Bright and Spacious
- Furnished
- 900 sq ft (83.6 sqm)
- Close to St James Park
- Moments away from Victoria Station



This bright and spacious two bedroom, two bathroom property nestled in the heart of Westminster, is now available for lease through Prime London.

The apartment offers a beautiful interior, featuring an impressive open-plan reception and dining area complemented by a separate kitchen. The apartment comes fully furnished with modern amenities, and includes an ensuite bathroom connected to the master bedroom. Both rooms are presented in impeccable condition. Located in the development of Luke House on Abbey Orchard Street, just off Victoria Street, the property also provides convenient lift access within its secure premises.

The property enjoys an excellent location, being within half a mile of St. James's Park and in close proximity to all the amenities of Westminster and Victoria. This includes a variety of restaurants, shops, and some of London's most iconic landmarks. For transportation, St. James's Park Tube Station (District and Circle lines) and Westminster Tube Station (Jubilee, District, and Circle lines) are both within half a mile. Additionally, Victoria Station, serving the Overground, Victoria, District, and Circle lines, is within a mile of the property. Please note that all distances mentioned are approximate.



These particulars, whilst believed to be accurate are set out as a general outline only for guidance and do not constitute any part of an offer or contract. Intending purchasers should not rely on them as statements of representation of fact, but must satisfy themselves by inspection or otherwise as to their accuracy. No person in this firm's employment has the authority to make or give any representation or warranty in respect of the property.