

Hamilton House

St George Wharf, SW8 2JE

Best Offers Over £1,800,000



Floor Plan

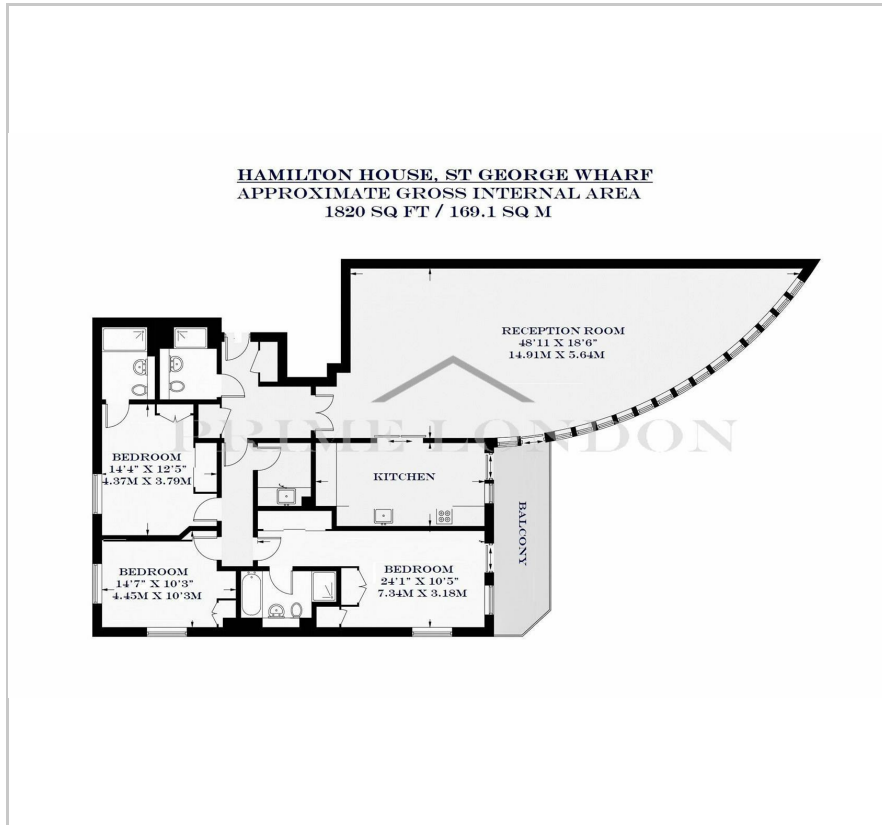

Area Map

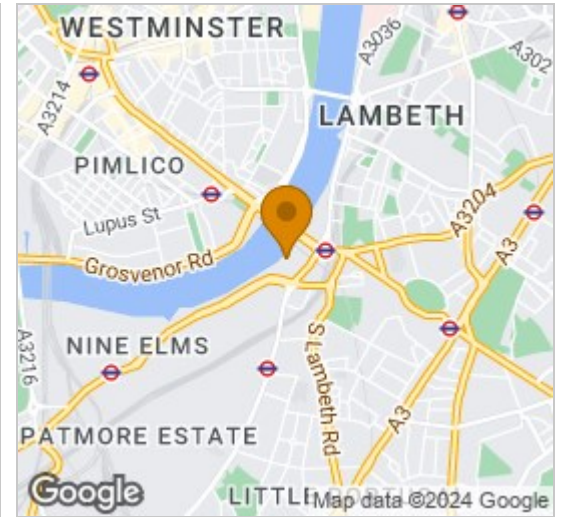

Energy Efficiency Graph

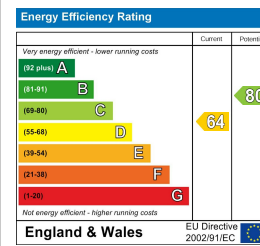

Viewing

By appointment. Contact us on 0207 928 6663 if you wish to arrange a viewing appointment for this property, or require further information.

- Three bed three bath with chain free balcony
- Large living space 1,820 sq ft / 169.1 sq m
- Excellent transport links
- Direct views of the River Thames
- 24 hour concierge



This exceptional larger style three bedroom three bathroom apartment, with spectacular views towards the London Eye, comes beautifully furnished and is available for chain free sale in Hamilton House, St George Wharf through Prime London.

Offering approximately 1,820 sq ft (169.1 sqm) of living space, the apartment comprises master bedroom with en suite bathroom and private balcony, two further double bedrooms (one of which has an en suite), separate family bathroom, utility room, and huge semi-open plan reception with dining area and modern kitchen.

This apartment benefits from the fantastic transport links afforded by this very well kept complex by The River Thames. St George Wharf offers on site riverside bars and restaurants such as Waterfront London, The Riverside, Four Degree and Pop Art Sushi as well as direct access to Vauxhall Underground Station on the Victoria Line. For additional convenience other on site outlets include Tesco Express, Pret a Manger, Hudson's Dry Cleaners, Riverside Medical Centre & Dental Spa and more.

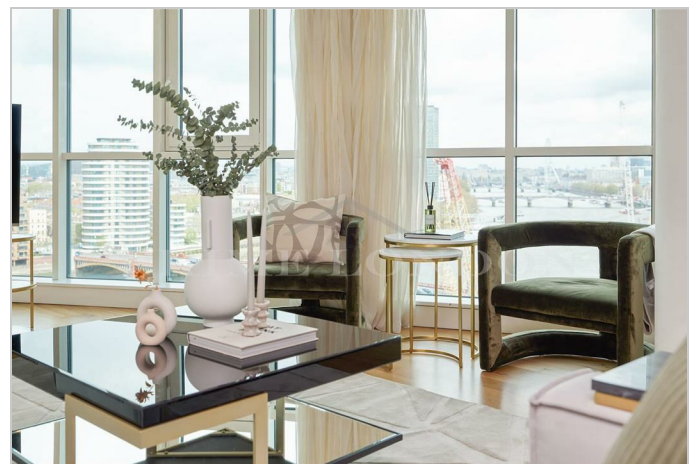

These particulars, whilst believed to be accurate are set out as a general outline only for guidance and do not constitute any part of an offer or contract. Intending purchasers should not rely on them as statements of representation of fact, but must satisfy themselves by inspection or otherwise as to their accuracy. No person in this firm's employment has the authority to make or give any representation or warranty in respect of the property.