



# Whitehouse Apartments

Southbank, SE1 8YP

Asking Price £750,000

2 2 1 C

## Floor Plan

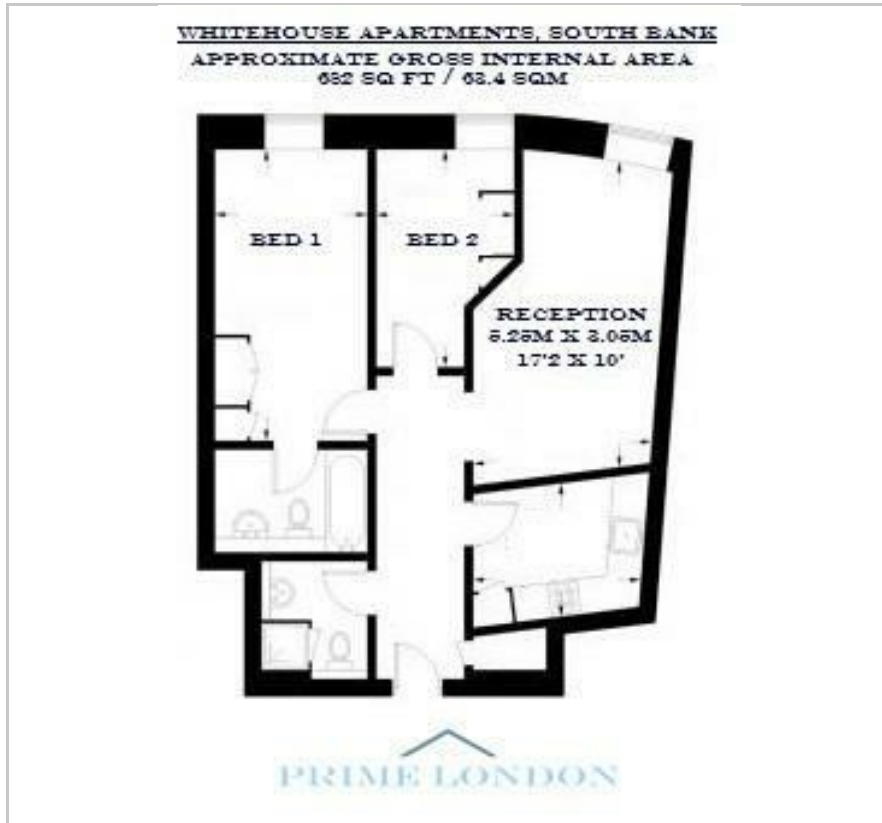

## Area Map



## Energy Efficiency Graph

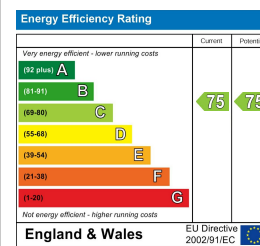

## Viewing

By appointment. Contact us on 0207 928 6663 if you wish to arrange a viewing appointment for this property, or require further information.

- Two bedroom two bathroom
- Chain free
- Facing towards the Royal Festival Hall
- Fully equipped gymnasium, heated swimming pool, steam room and sauna
- Residents' roof terrace
- 24 hour concierge

This front facing two bedroom apartment, with peaceful views towards the Royal Festival Hall, is available for sale through Prime London. The property also comes with a secure parking space and a separate storage unit.

The apartment offers a spacious reception room, fully fitted separate kitchen, two bedrooms (primary with en suite), and separate shower room.

Additionally, residents enjoy exclusive access to the spa and fitness centre complete with fully equipped gymnasium, heated swimming pool, steam room and sauna. The Whitehouse Apartments further features a 24 hour concierge service and communal roof terrace.

Positioned moments from the South Bank, the location offers an array of some of London's finest cultural attractions, restaurants, cafes and shops. Nearby Waterloo station provides superb transport links via the Bakerloo, Jubilee, Northern and Waterloo & City lines.

\*Images and floor plan are of the same style apartment on another floor, and are intended to show example layout only.



These particulars, whilst believed to be accurate are set out as a general outline only for guidance and do not constitute any part of an offer or contract. Intending purchasers should not rely on them as statements of representation of fact, but must satisfy themselves by inspection or otherwise as to their accuracy. No person in this firm's employment has the authority to make or give any representation or warranty in respect of the property.