

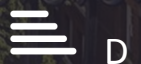

192 Emery Hill Street

Westminster, SW1P 1PN

£565 Per Week

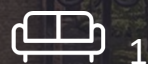

Floor Plan

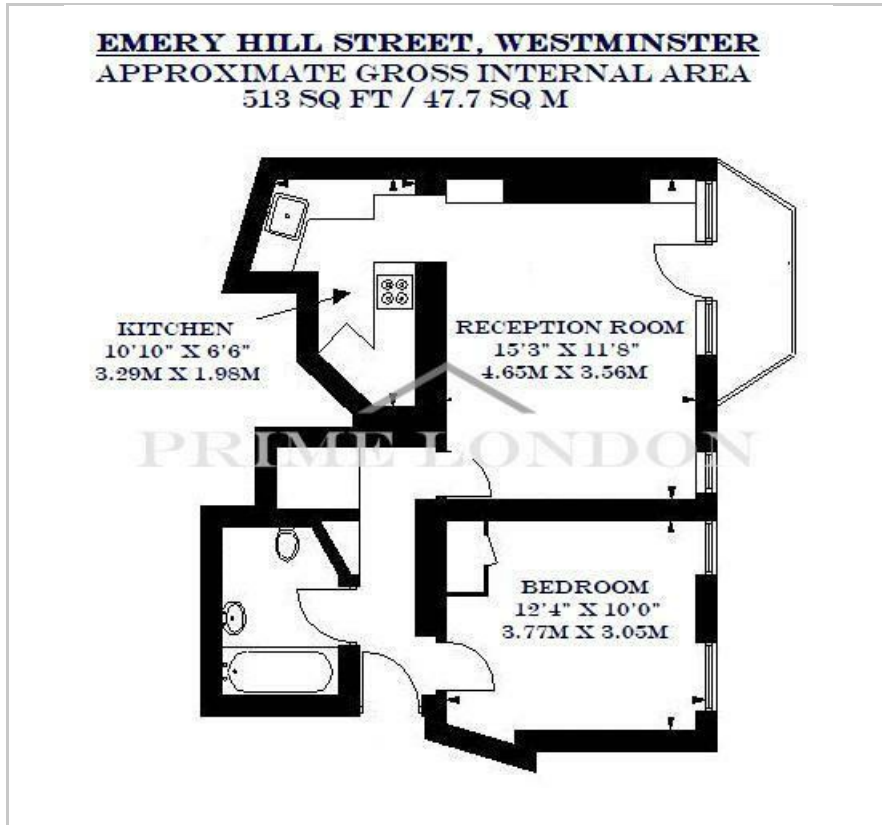

Area Map



Energy Efficiency Graph

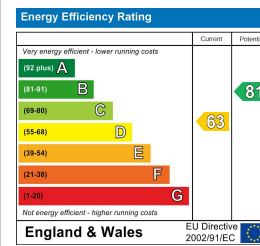

Viewing

By appointment. Contact us on 0207 928 6663 if you wish to arrange a viewing appointment for this property, or require further information.

- Classic British mansion block
- 513 sq ft (47.7 sqm)
- Lift within building
- Large south east facing balcony



This charming apartment set within a classic British mansion block, situated on a higher floor (with Lift) and offering wonderful south facing leafy views across Westminster, is available for lease through Prime London.

The spacious property comprises a well-proportioned reception room with a generous balcony surrounded by a wrought iron balustrade, flooding the apartment with natural light.

The kitchen is semi open plan coming off the reception and is fully fitted. As you enter the property you will find the three piece family bathroom to the left, and an ample double bedroom with fitted storage.

High ceilings throughout and immaculate common parts with an abundance of period charm add to a sense of grandeur making this an exceptional apartment.

Emery Hill Street is a residential tree lined road flanked on either side by red brick late Victorian mansion buildings. The famous Westminster Cathedral lies at the centre with a wide selection of shops, bars and countless restaurants along the lively and extensively redeveloped area around Victoria station.

The surrounding transport links are superb with three tube lines (Circle, District and Victoria) as well as mainline connections and the Gatwick Express all within Victoria Station. The Houses of Parliament and St. James's Park are all close by with a further tube station at Westminster for Jubilee line connections.



These particulars, whilst believed to be accurate are set out as a general outline only for guidance and do not constitute any part of an offer or contract. Intending purchasers should not rely on them as statements of representation of fact, but must satisfy themselves by inspection or otherwise as to their accuracy. No person in this firm's employment has the authority to make or give any representation or warranty in respect of the property.