

Blenheim House

Crown Square, One Tower Bridge, SE1 2SF

Asking Price £750,000



Floor Plan

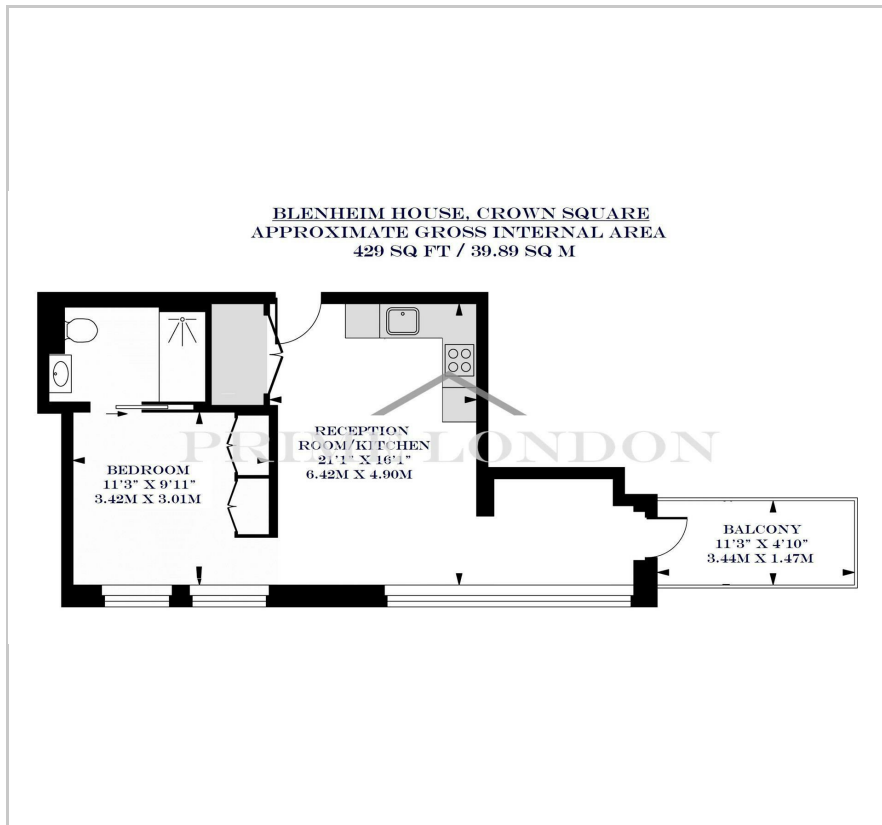

Area Map

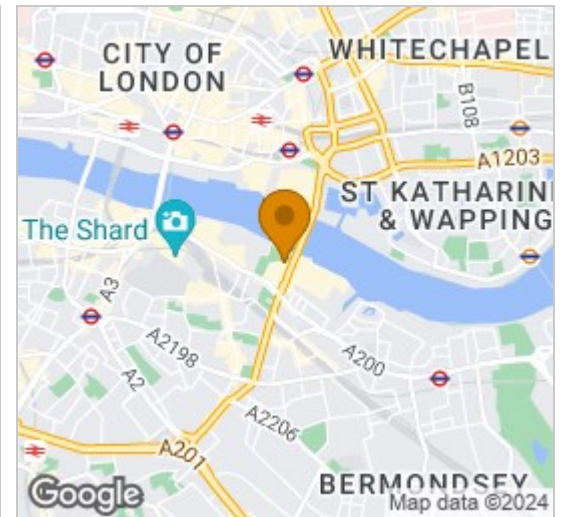

Energy Efficiency Graph



Viewing

By appointment. Contact us on 0207 928 6663 if you wish to arrange a viewing appointment for this property, or require further information.

- High-end finishes
- Private balcony
- Pool, spa and gym facility
- 429 sq ft / 39.89sqm
- State of the art integration
- 999 year leasehold



A stunning 429 sq ft / 39.89sqm studio apartment in the prestigious One Tower Bridge is available for chain free sale through Prime London. One Tower Bridge is situated on one of the last great riverside sites in London.

Just moments from the City it offers the ultimate in 5-star luxury living experiences. Each apartment has been individually considered to ensure every demand of contemporary luxury living is met (being designed by Conran and Partners).

Apartments benefit from state of the art integrated systems using the very latest in smart home technology, underfloor heating throughout, comfort cooling to principal rooms, ergonomically planned designer kitchens and individual finishes.

The development itself offers a residents only health club including pool, spa and gym facility, private courtyard garden, business lounge and virtual golf.



These particulars, whilst believed to be accurate are set out as a general outline only for guidance and do not constitute any part of an offer or contract. Intending purchasers should not rely on them as statements of representation of fact, but must satisfy themselves by inspection or otherwise as to their accuracy. No person in this firm's employment has the authority to make or give any representation or warranty in respect of the property.