

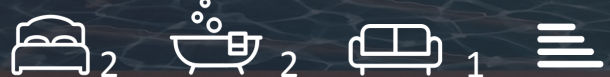

Phoenix Court

Kennington Lane, Oval Village, SE11 5QU

Offers In Excess Of £1,000,000



Floor Plan

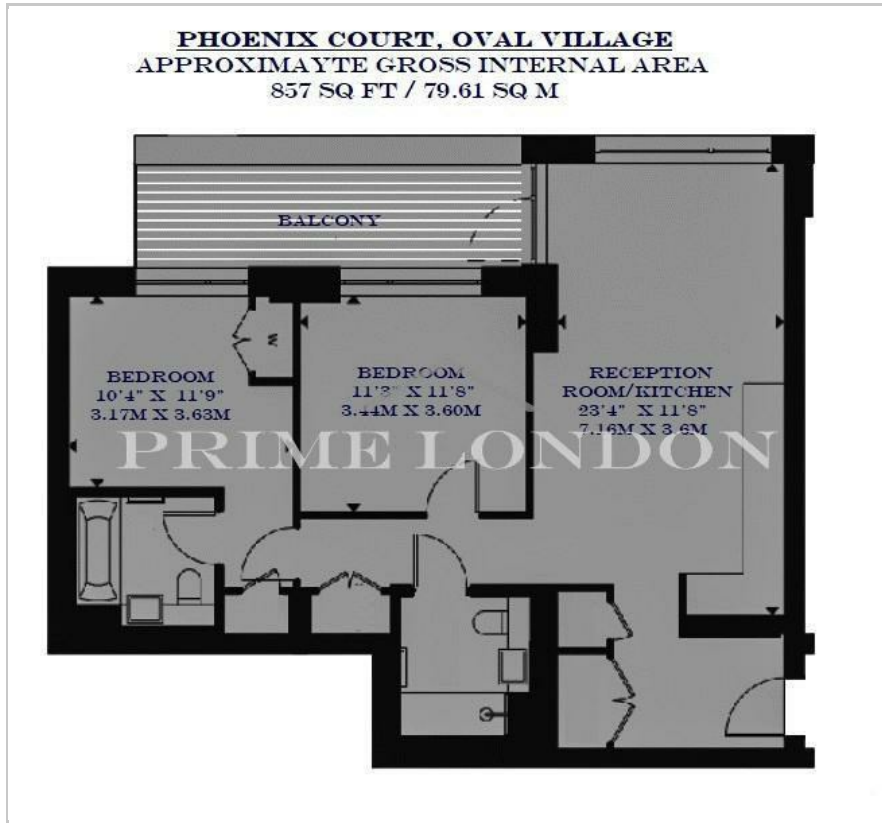

Area Map



Energy Efficiency Graph

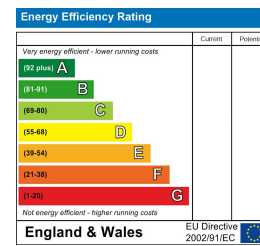

Viewing

Please contact our on 0207 928 6663 if you wish to arrange a viewing appointment for this property or require further information.

- Brand new two bedroom ▪ 857 sq ft / 79.61 sq m apartment
- Large private balcony ▪ Close to several excellent transport links
- Residents' gym and ▪ 24 hour concierge swimming pool



This brand new and expertly crafted two bedroom apartment, set within the extremely well received new development Oval Village, is available for sale through Prime London. Finished to an excellent standard throughout, this modern 857 sq ft / 79.61 sq m apartment comprises a spacious open plan kitchen and reception room with generous floor to ceiling windows, wooden flooring and comfort cooling throughout, a large private balcony, two well designed double bedrooms - one of which has an en suite bathroom, and a further modern and stylish family bathroom. Resident facilities also include a first class 24 hour concierge, on-site gym and swimming pool, and roof gardens showcasing excellent city views. Oval Village is located between Zones 1 & 2, on the border of prime central London. Built on the site of the historic Oval Gasworks - just a 7 to 10 minute walk from Vauxhall (Victoria Line & Southwestern Railway), Oval (Northern Line) and Kennington (Northern Line) stations - Oval Village is an exciting collection of apartments that has all the charm, character and community of English village life, without losing the buzz of the city. Oval Village is an oasis of calm in the heart of London: a village in the city. Oval and its surrounding area, is a place with tree-lined streets and tranquil parks. A place to meet friends, family or neighbours across its lively mosaic of new bars, cafes, shops and art galleries. However, the City can be easily reached with Oxford Circus, London Bridge and Bank accessible via a 10 minute tube journey. *Images are of show flat or computer generated and are only intended to show example finishes of the property



These particulars, whilst believed to be accurate are set out as a general outline only for guidance and do not constitute any part of an offer or contract. Intending purchasers should not rely on them as statements of representation of fact, but must satisfy themselves by inspection or otherwise as to their accuracy. No person in this firm's employment has the authority to make or give any representation or warranty in respect of the property.