



The Tower

One St George Wharf, SW8 2BW

Asking Price £2,200,000

3 2 1

Floor Plan

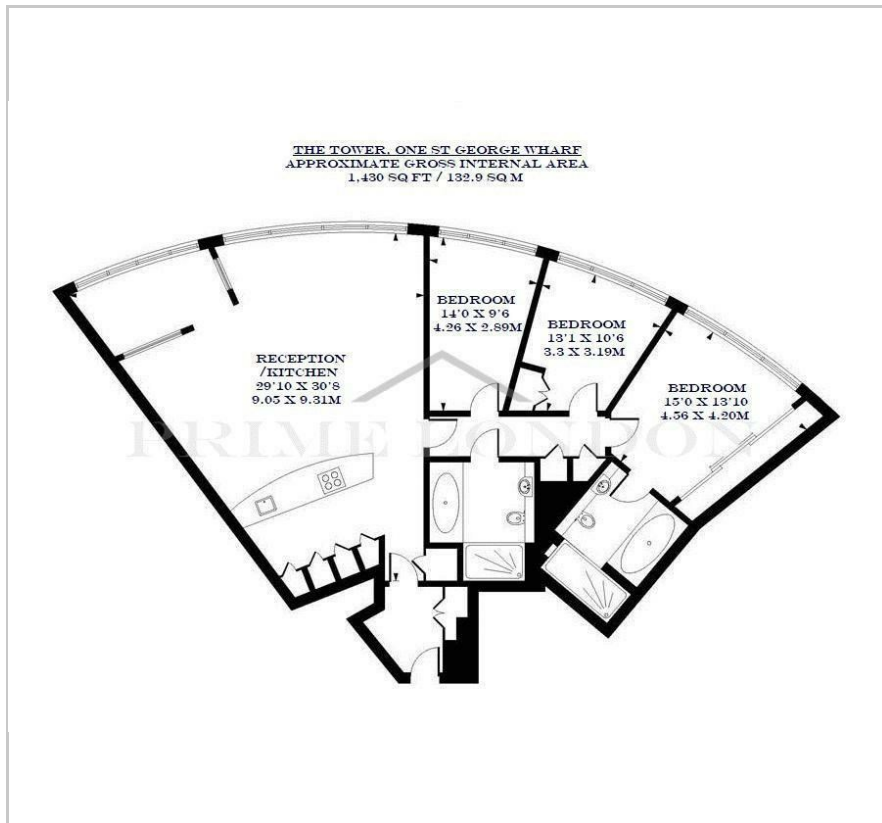

Area Map

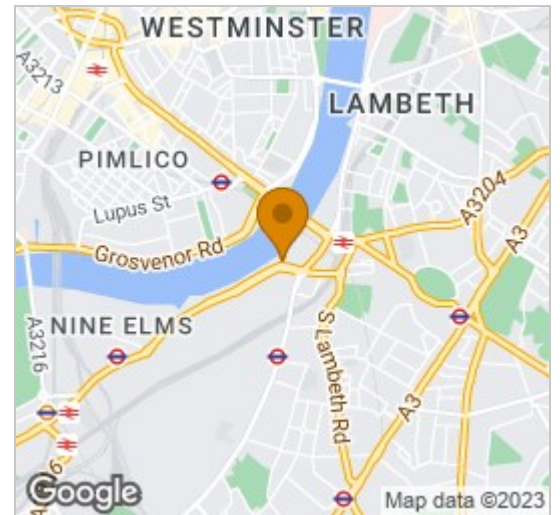

Energy Efficiency Graph

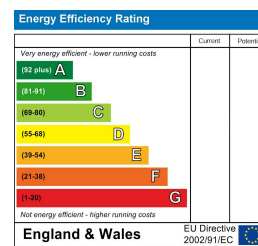

Viewing

Please contact our on 0207 928 6663 if you wish to arrange a viewing appointment for this property or require further information.

- Excellent panorama from the 27th floor
- 1 x Valet parking
- 24 hour concierge service
- Private meeting rooms and professional catering facilities
- 1,430 sq ft / 132.9 sq m
- Luxury Gym, Swimming Pool and Spa facilities
- Residents only Cinema
- Highly secure gated development

With an excellent panorama from the 27th floor, and with extensive lateral space totalling some 1,430 sq ft (132.9 sqm), this bright three bedroom apartment with valet parking is available for chain free sale through Prime London. The apartment offers a fully integrated kitchen with Miele appliances, high specification bathrooms with exquisite tiling and fittings, comfort cooling, touch panel controls, recessed lighting and automated winter garden.

Amenities at The Tower include front door concierge service with valet parking, first floor gym, pool and sauna facilities as well as a private cinema. St George Wharf offers on site riverside bars and restaurants such as Waterfront London, The Riverside, Four Degree and Pop Art Sushi. For additional convenience other on site outlets include Tesco Express, Pret a Manger, Hudson's Dry Cleaners, Riverside Medical Centre, Dental Spa and more.



These particulars, whilst believed to be accurate are set out as a general outline only for guidance and do not constitute any part of an offer or contract. Intending purchasers should not rely on them as statements of representation of fact, but must satisfy themselves by inspection or otherwise as to their accuracy. No person in this firm's employment has the authority to make or give any representation or warranty in respect of the property.