



Aiskew Grove, Fairfield, Stockton-On-Tees, TS19 7RB

An outstanding DETACHED BUNGALOW which has been completely transformed over the past 3 years. This was already a good sized property but the garage has been converted to give a larger kitchen and a dining area and, together with other carefully planned layout changes, now offers a large, stylish bungalow which is bright and spacious.

The generous entrance hall is entered via a composite double glazed door and initially leads to the wonderful refitted kitchen, with contemporary fitted units featuring integrated oven, microwave, induction hob, washer, dishwasher and fridge/freezer. The large lounge has double doors leading to a conservatory. Both of the double bedrooms have en-suites - one with showpiece freestanding bath/pillar tap, and the other with a huge 800 x 1800 shower with rainfall fitting. Additionally there is a large separate WC, off the entrance hall. The bungalow is immaculately presented, demonstrating attention to detail throughout and with too many upgrades to list. The recent work includes a complete new roof covering and a new block paved drive which extends over much of the front garden, providing ample parking space. The west facing rear garden is designed with low maintenance in mind and has a very large shed. There is combi gas central heating and uPVC double glazing.

The property is situated in an ever popular location close to shops, schools and bus routes. Viewings are essential to appreciate the quality on offer.

£310,000

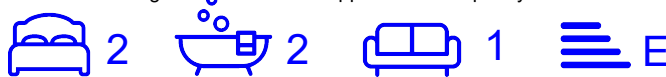

Aiskew Grove, Fairfield, Stockton-On-Tees, TS19 7RB

HALL

KITCHEN/DINING

17'2" x 21'9" (5.23m x 6.63m)

LOUNGE

12'4" x 21'9" (3.76m x 6.63m)

CONSERVATORY

9'3" x 7'1" (2.82m x 2.16m)

WC

3'11" (1.19m)

BEDROOM ONE

13'9" x 9'6" (4.19m x 2.90m)

ENSUITE

7'4" x 9'6" (2.24m x 2.90m)

BEDROOM TWO

8'9" x 13'11" (2.67m x 4.24m)

BATHROOM

8'7" x 5'6" (2.62m x 1.68m)



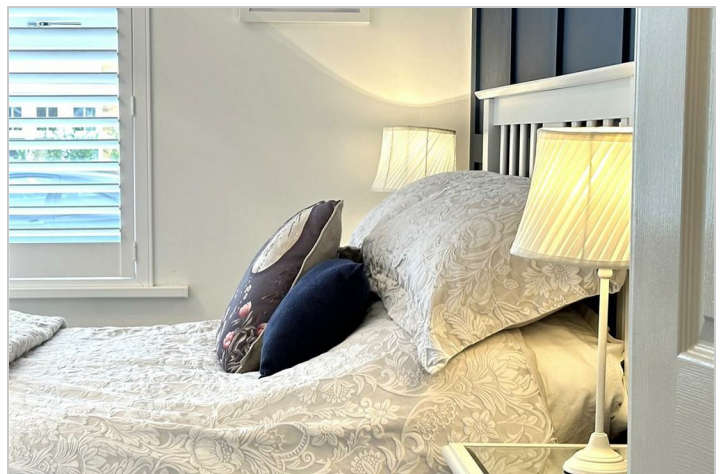

Map

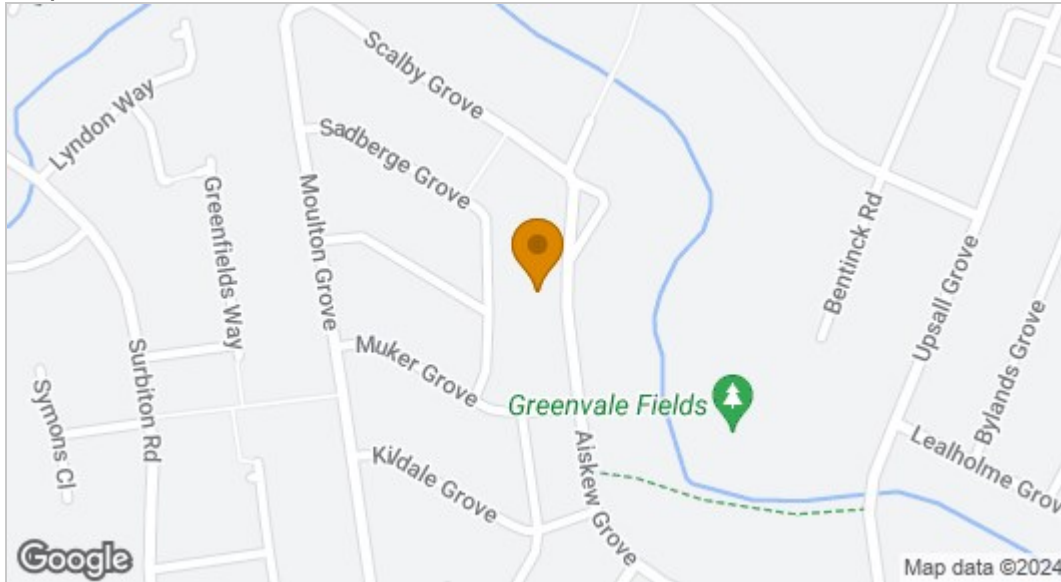

EPC graph

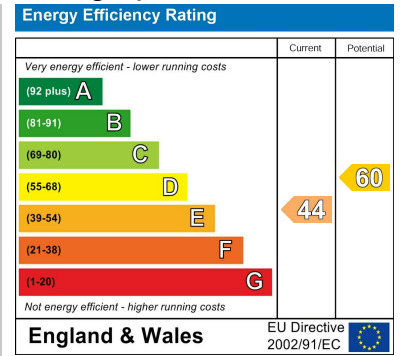

Floor Plan

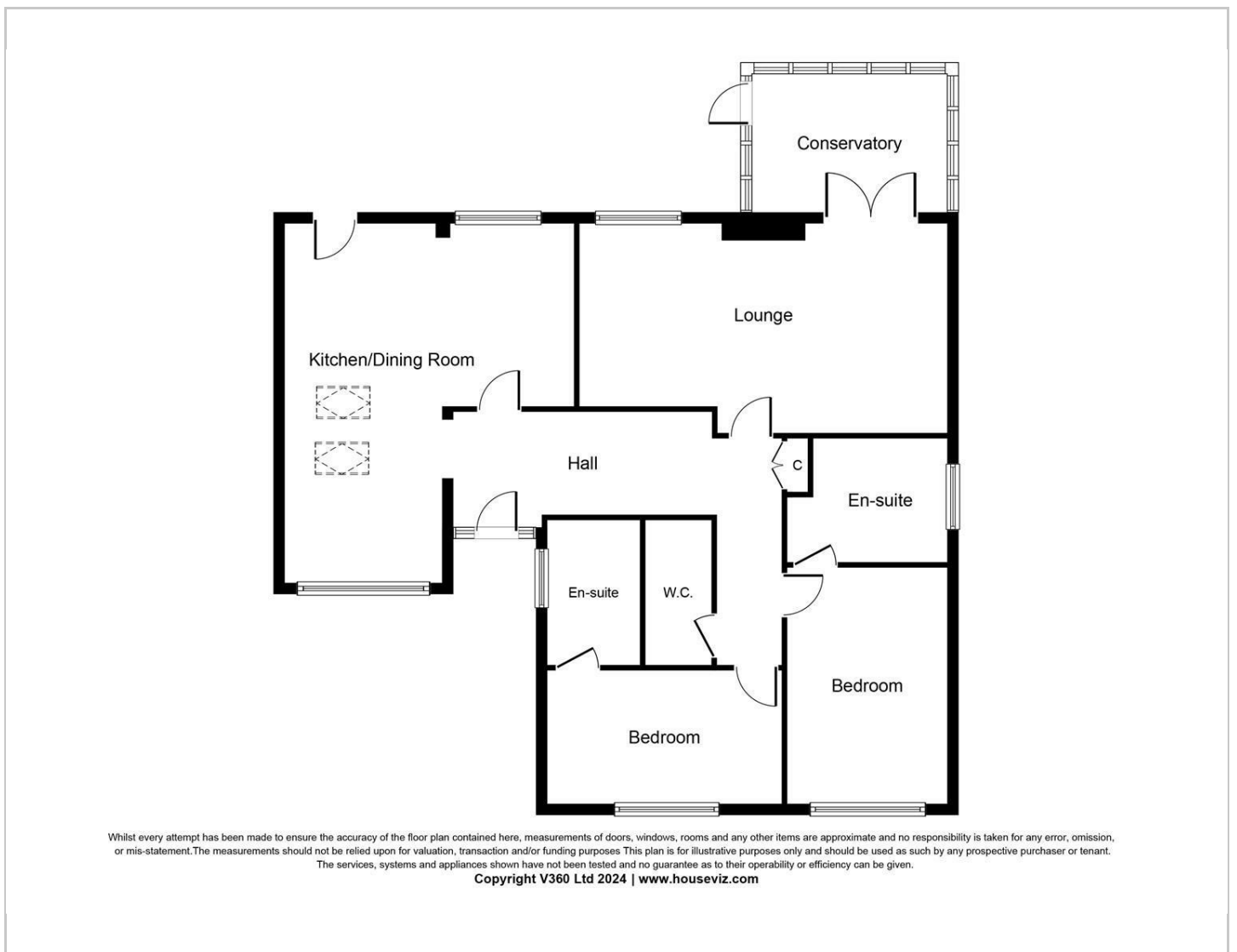

VIEWING

Please contact us on 01642 615657 if you wish to arrange a viewing or would like more information.

These particulars, whilst believed to be accurate are set out as a general outline only for guidance and do not constitute any part of an offer or contract. Intending purchasers should not rely on them as statements of representation of fact, but must satisfy themselves by inspection or otherwise as to their accuracy. No person in this firm's employment has the authority to make or give any representation or warranty in respect of the property.

17 Bishop Street, Stockton on Tees, TS18 1SY

Tel: 01642 615657 Email: stockton@gowlandwhite.co.uk <https://www.gowlandwhite.co.uk/>