



Forest Park, Stillington, Stockton-On-Tees, TS21 1NW

SPACIOUS DETACHED HOUSE situated in a cul de sac within the Village of Stillington, benefiting from a South facing rear garden which is not directly overlooked, and is within walking distance of the Forest Park Nature Reserve.

This property will ideally suit a growing family and provides well apportioned and versatile family living space. The entrance hall with cloakroom/wc provides access to a lounge with bow window to the front, focal fireplace and double doors into the dining room which has French doors leading out to the rear garden. The kitchen is fitted with a good range of units including electric oven, gas hob and a pantry. Located on the first floor is the master bedroom with en-suite, three further double bedrooms, two with fitted wardrobes and a Jack and Jill en-suite, in addition to a family bathroom.

To the front aspect is a lawned garden and double driveway leading to the integral single garage, providing extra parking space or storage. The enclosed South facing rear garden offers a high level of privacy and provides lawn with borders and shrubs, generous paved patio area, and timber garden shed. The Village of Stillington offers a Primary School, Village shop, Post Office, Health Centre and Church.

Stillington lies close to Stockton on Tees and Sedgefield, is surrounded by open countryside, has a local bus service which runs through the Village, and there is easy access to the A1(M) and A19 with good transport links for commuting.

Offers In The Region Of £250,000



Forest Park, Stillington, Stockton-On-Tees, TS21 1NW

ENTRANCE HALL

CLOAKROOM/WC

5'1" x 2'11" (1.55 x 0.89)

LOUNGE

15'9" x 10'7" (4.80 x 3.23)

DINING ROOM

10'7" x 10'6" (3.23 x 3.20)

KITCHEN

15'0" x 10'5" (4.57 x 3.18)

FIRST FLOOR LANDING

BEDROOM ONE

14'2" x 10'11" (4.32 x 3.33 (4.31 x 3.32))

EN-SUITE

6'8" x 6'2" (2.03 x 1.88)

BEDROOM TWO

14'2" x 8'6" (4.32 x 2.59)

'JACK N JILL' EN-SUITE

6'6" x 5'9" (1.98 x 1.75)

BEDROOM THREE

10'1" x 8'11" (3.07 x 2.72)

BEDROOM FOUR

9'1" x 8'8" (2.77 x 2.64)

BATHROOM

6'9" x 6'2" (2.06 x 1.88)





Map



EPC graph

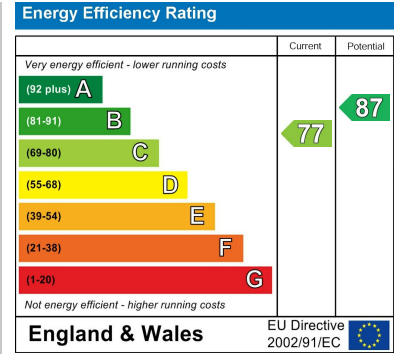

Floor Plan

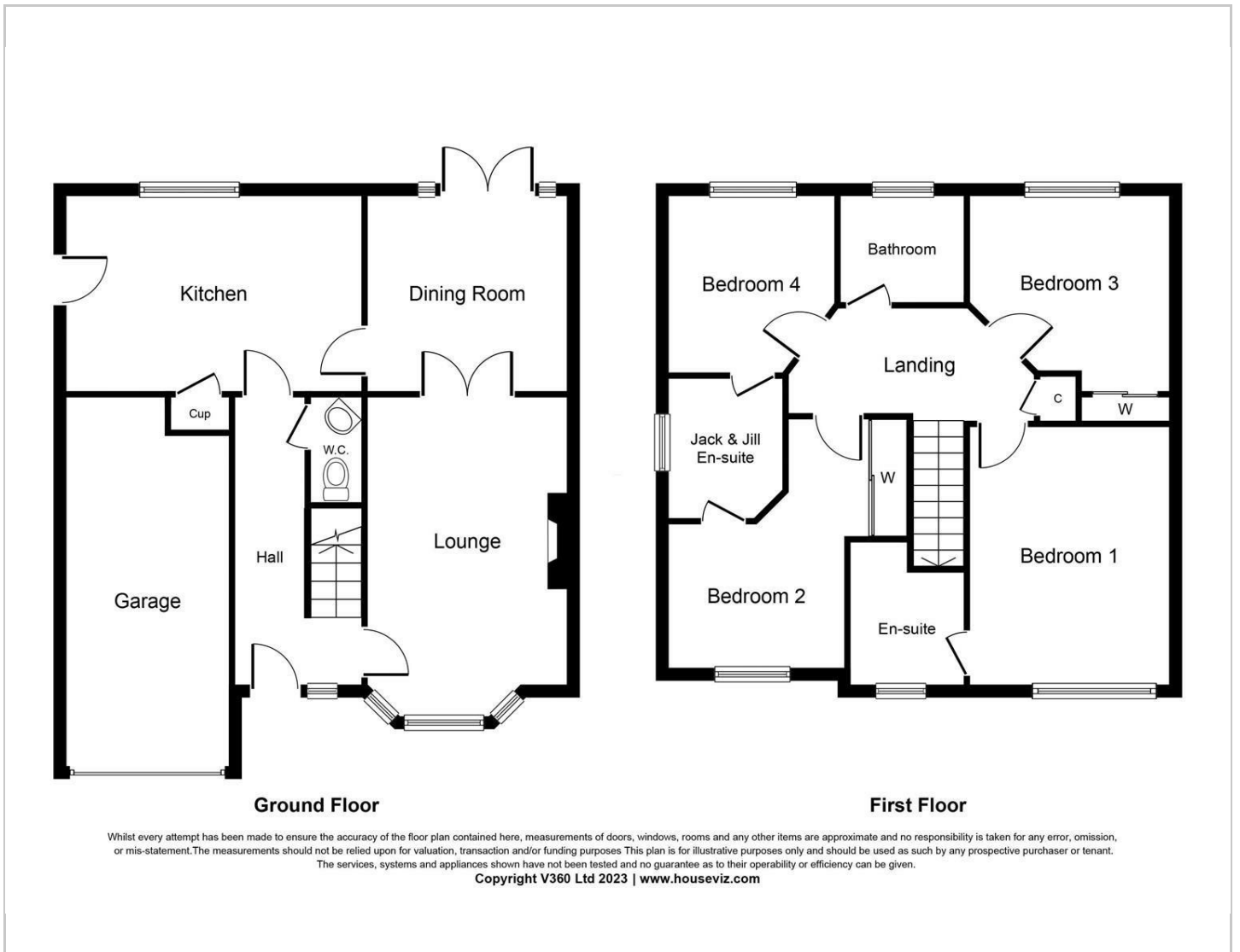

VIEWING

Please contact us on 01642 615657 if you wish to arrange a viewing or would like more information.

These particulars, whilst believed to be accurate are set out as a general outline only for guidance and do not constitute any part of an offer or contract. Intending purchasers should not rely on them as statements of representation of fact, but must satisfy themselves by inspection or otherwise as to their accuracy. No person in this firm's employment has the authority to make or give any representation or warranty in respect of the property.