



Greens Grove, Hartburn, Stockton-On-Tees, TS18 5AW

This stunning semi detached bungalow is offered for sale with NO ONWARD CHAIN and is located in a sought after cul-de-sac in the heart of Hartburn where a range of local shops, amenities and public transport links are available close by.

IMMACULATELY PRESENTED, the accommodation is gas centrally heated and UPVC double glazed throughout. The property comprises; welcoming hallway, lounge, fitted kitchen with integrated oven and hob, conservatory, modern shower room, 2 double bedrooms, with one featuring built-in mirrored wardrobes.

Externally the bungalow is partially block paved to the front providing off road parking for approximately three cars and an additional detached single garage, offering extra storage space or further off-road parking. The enclosed garden to the rear is SOUTH FACING and low maintenance.

Asking Price £170,000



Greens Grove, Hartburn, Stockton-On-Tees, TS18 5AW

ENTRANCE HALL

LOUNGE

11'10" x 15'10" (3.61 x 4.83 (3.60 x 4.82))

KITCHEN

10'2" x 8'6" (3.10 x 2.59)

CONSERVATORY

5'7" x 12'9" (1.70 x 3.89)

BEDROOM ONE

11'9" x 11'10" (3.58 x 3.61)

BEDROOM TWO

9'1" x 8'4" (2.77 x 2.54)

SHOWER ROOM

7'0" x 6'3" (2.13 x 1.91)





Map



EPC graph

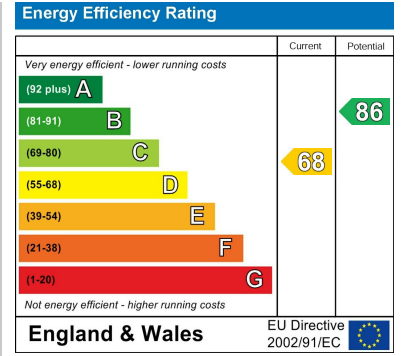

Floor Plan

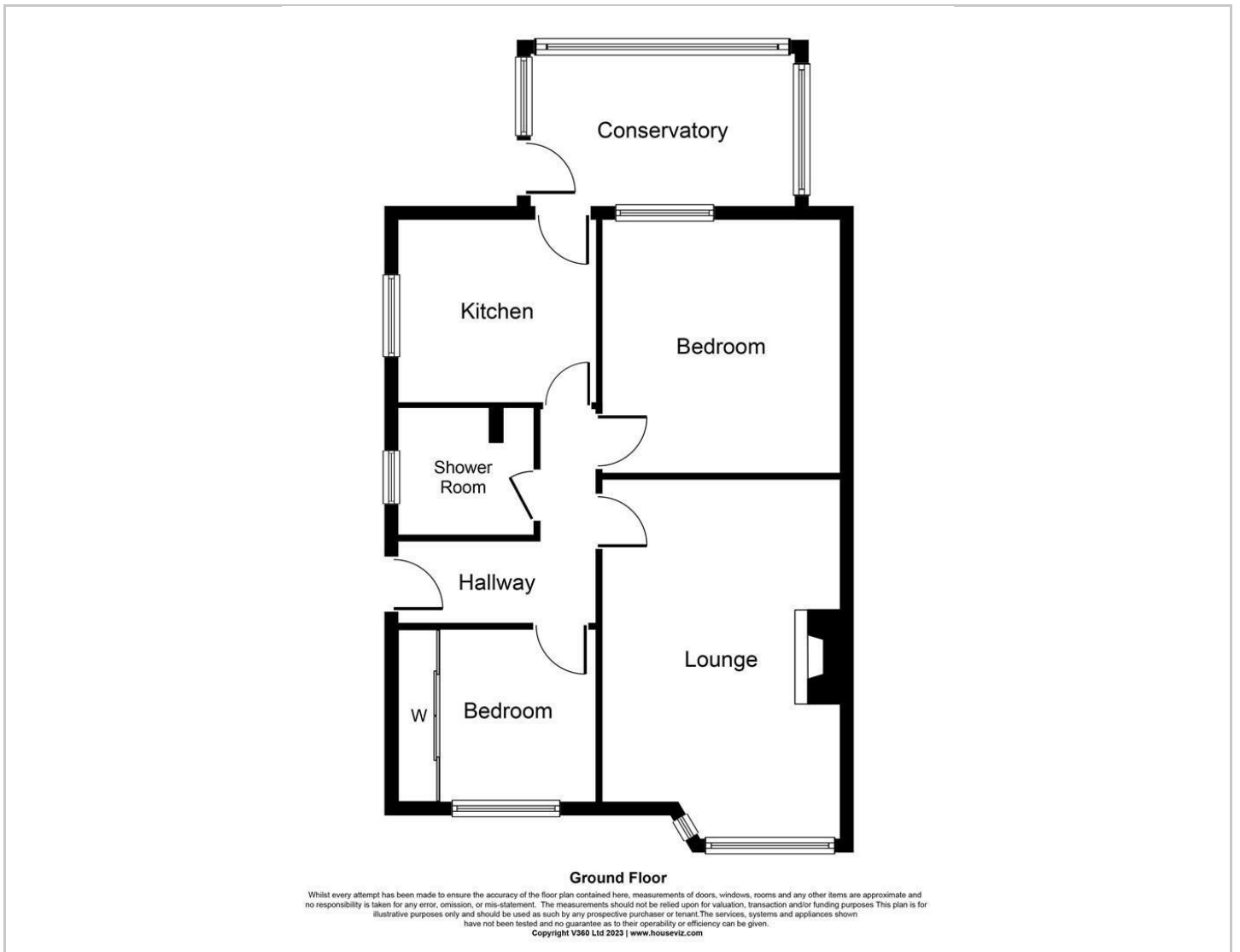

VIEWING

Please contact us on 01642 615657 if you wish to arrange a viewing or would like more information.

These particulars, whilst believed to be accurate are set out as a general outline only for guidance and do not constitute any part of an offer or contract. Intending purchasers should not rely on them as statements of representation of fact, but must satisfy themselves by inspection or otherwise as to their accuracy. No person in this firm's employment has the authority to make or give any representation or warranty in respect of the property.

17 Bishop Street, Stockton on Tees, TS18 1SY

Tel: 01642 615657 Email: stockton@gowlandwhite.co.uk <https://www.gowlandwhite.co.uk/>