



Yarm Road, Eaglescliffe, Stockton-On-Tees, TS16 0DP

Offered for sale with NO ONWARD CHAIN, this well presented one bedroom GROUND FLOOR apartment is likely to appeal to a variety of buyers including investors, first time buyers and anyone looking to downsize. Situated within a period property conversion, the apartment is within walking distance to Yarm High Street, local amenities and offers excellent access to commuting routes.

The property comprises of entrance hallway, open plan lounge/kitchen with integrated fridge/freezer, dishwasher, hob and oven, bedroom, bathroom and a practical utility cupboard.

Externally there is a large communal garden with mature shrubs and seating areas. There is also parking available for residents to the front.

Asking Price £120,000



Yarm Road, Eaglescliffe, Stockton-On-Tees, TS16 0DP

HALLWAY

LOUNGE/KITCHEN
14'6" x 11'3" (4.42m x 3.43m)

BEDROOM
11'9" x 10'7" (3.58m x 3.23m)

BATHROOM
10'6" x 6'0" (3.20m x 1.83m)



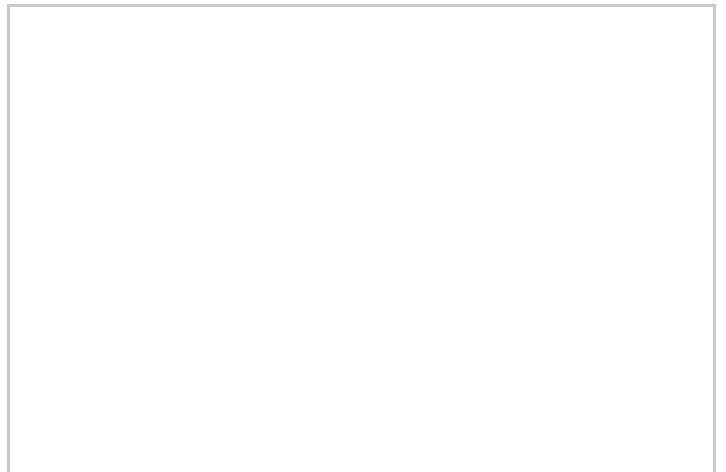
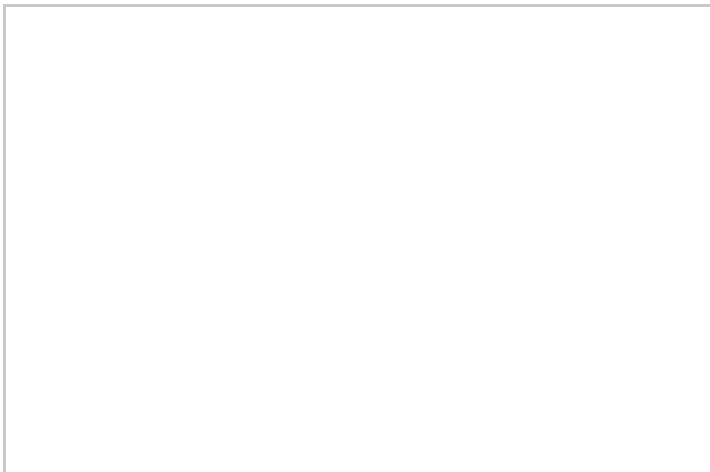

Map

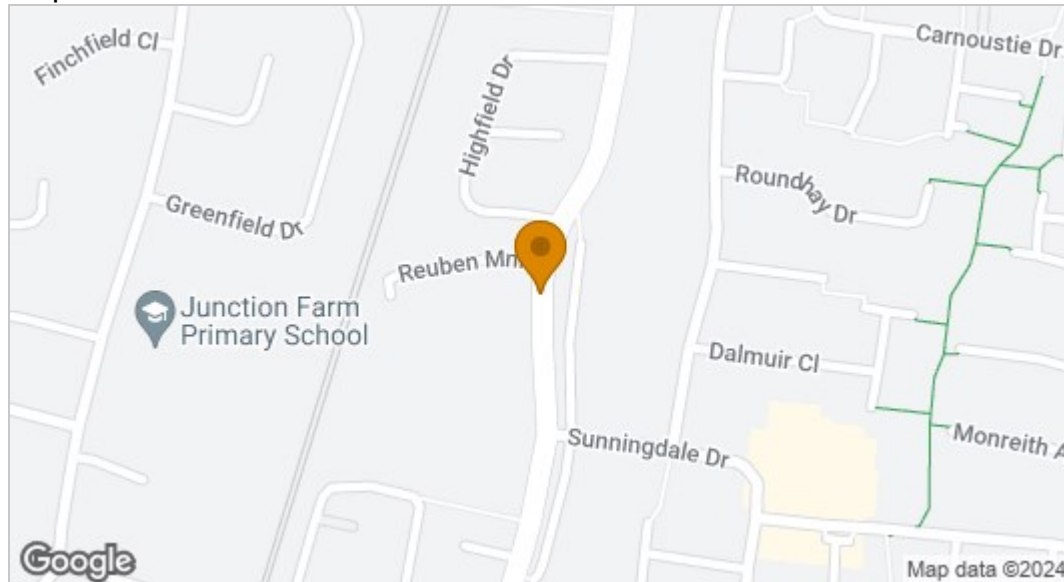

EPC graph

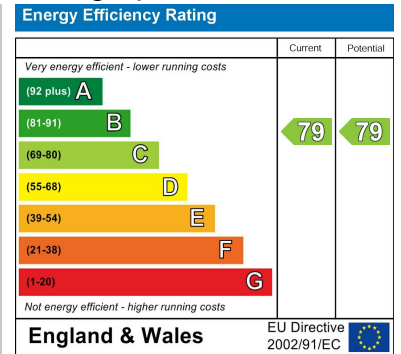

Floor Plan

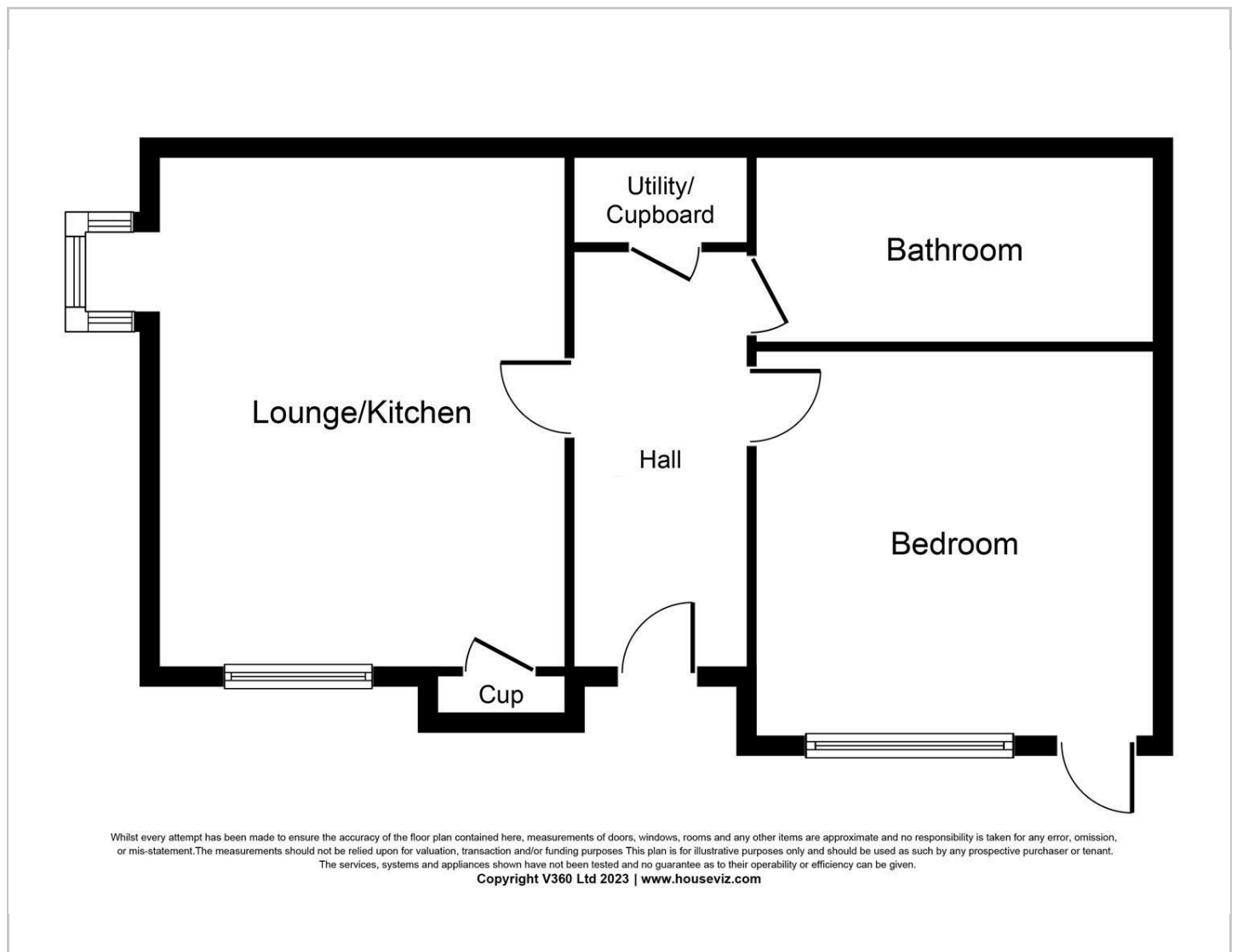

VIEWING

Please contact us on 01642 248248 if you wish to arrange a viewing or would like more information.

These particulars, whilst believed to be accurate are set out as a general outline only for guidance and do not constitute any part of an offer or contract. Intending purchasers should not rely on them as statements of representation of fact, but must satisfy themselves by inspection or otherwise as to their accuracy. No person in this firm's employment has the authority to make or give any representation or warranty in respect of the property.