



Springfield Close, Eaglescliffe, Stockton-On-Tees, TS16 0EW

Offered for sale with the advantage of NO ONWARD CHAIN this SPACIOUS DETACHED BUNGALOW is nicely positioned in a cul de sac on a generous corner plot position, and located on the popular Orchard Estate development in Eaglescliffe. Springfield Close is conveniently positioned within a short distance of Orchard Shops and Tesco Supermarket, and within walking distance of Allens West Train Station providing access to various locations around the North East. There is easy access to Yarm High Street which offers an excellent range of shopping facilities, cafes, bars and restaurants. Internally the accommodation comprises entrance porch, hallway, lounge with patio doors opening out to the rear, kitchen/dining fitted with a range of white units and door into the conservatory. There are two double bedrooms and a bathroom/wc fitted with a suite including walk in bath with shower fitting. Outside the property sits on a good sized site with low maintenance gardens to the front, side and rear. There is a driveway to the front providing off road parking and leading to the garage offering secured parking space or storage.

Offers In The Region Of £250,000



Springfield Close, Eaglescliffe, Stockton-On-Tees, TS16 0EW

ENTRANCE PORCH

HALL

KITCHEN/DINING

18'0" x 8'6" (5.49 x 2.59)

CONSERVATORY

8'9" x 8'7" (2.67 x 2.62 (2.66 x 2.61))

LOUNGE

18'0" x 13'2" (5.49 x 4.01)

BEDROOM ONE

12'9" x 10'10" (3.89 x 3.30)

BEDROOM TWO

10'10" x 10'5" (3.30 x 3.18)

BATHROOM/WC

7'11" x 5'6" (2.41 x 1.68)

GARAGE

16'8" x 8'6" (5.08 x 2.59)



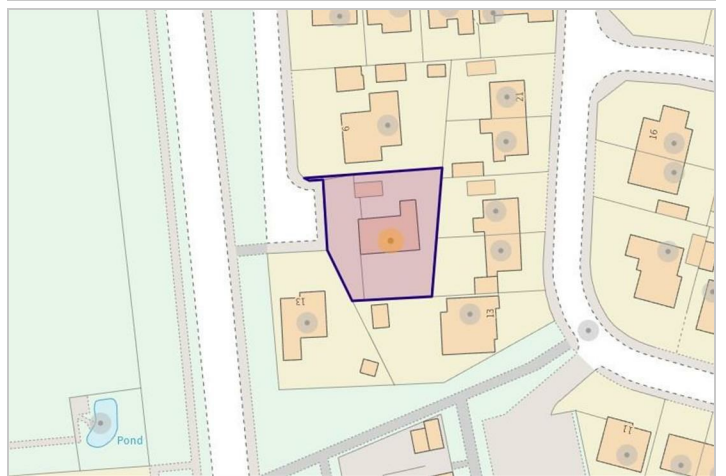

Map



EPC graph

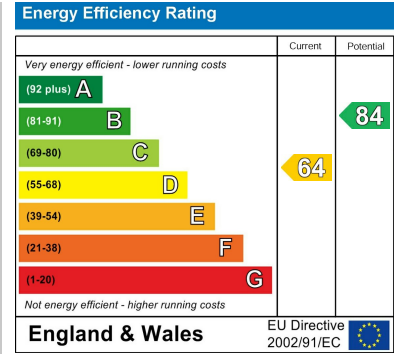

Floor Plan

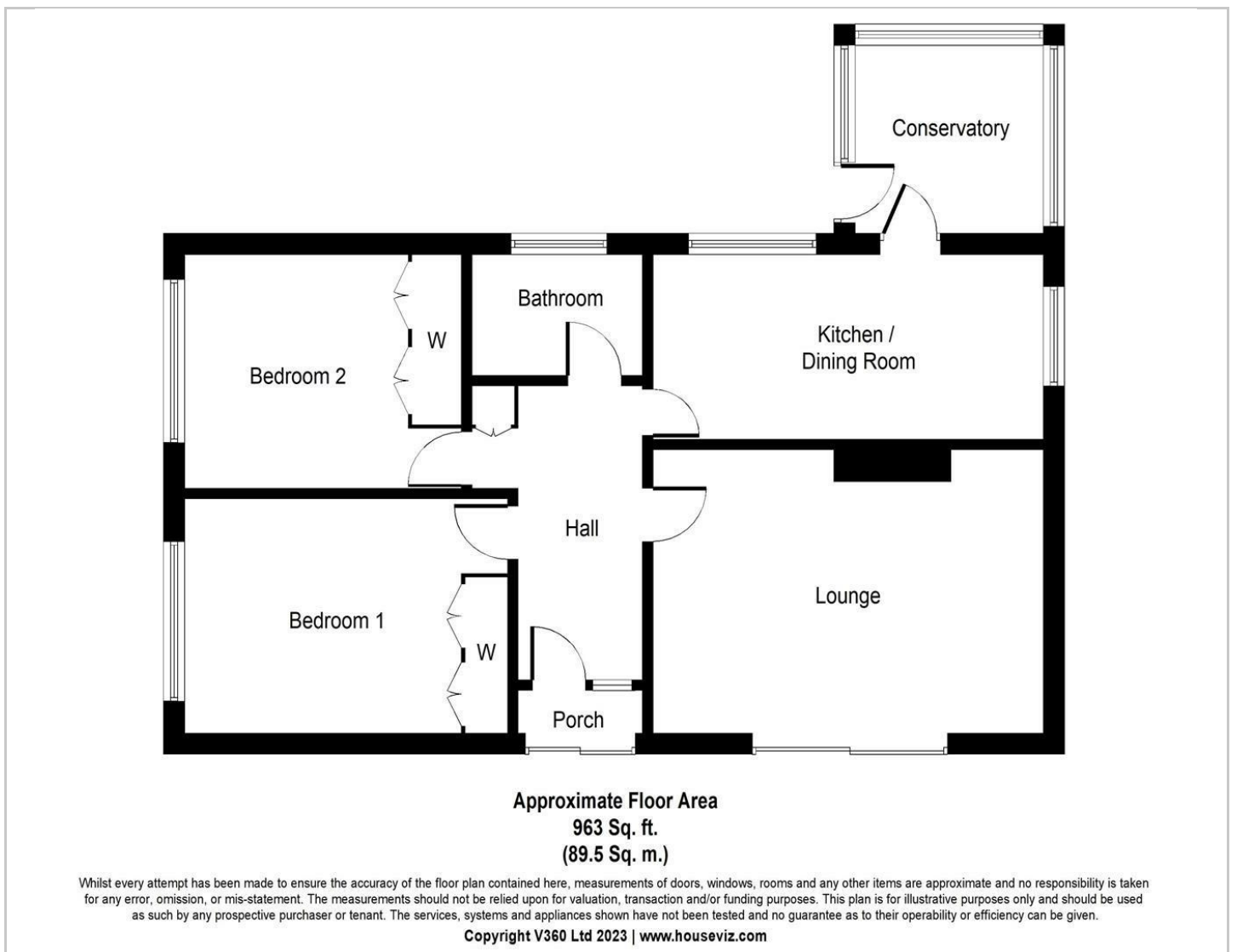

VIEWING

Please contact us on 01642 248248 if you wish to arrange a viewing or would like more information.

These particulars, whilst believed to be accurate are set out as a general outline only for guidance and do not constitute any part of an offer or contract. Intending purchasers should not rely on them as statements of representation of fact, but must satisfy themselves by inspection or otherwise as to their accuracy. No person in this firm's employment has the authority to make or give any representation or warranty in respect of the property.