

FOR  
SALE



14 Knightswood, Hampton Dene, Hereford HR1 1UZ

Offers Over £269,000 - Freehold

22, Broad Street, Hereford, HR4 9AP 01432 355455 [hereford@flintandcook.co.uk](mailto:hereford@flintandcook.co.uk)



## PROPERTY SUMMARY

A 3-bedroom semi-detached house situated in a highly sought-after residential location with driveway parking, garage, gas central heating and double glazing, well presented, and enclosed south facing rear garden.

## POINTS OF INTEREST

- *3 bedroom semi detached house*
- *Driveway parking & garage*
- *Sought after residential location*
- *Ideal family home!!*
- *Enclosed south facing rear garden*
- *Must be viewed*



## ROOM DESCRIPTIONS

### uPVC entrance door into

#### Entrance Hall

Tiled floor, radiator, smoke alarm, gas central heating thermostat, carpeted stairs leading up and doors to

#### Living Room

Wooden flooring, radiator, understairs storage cupboard, bay window to front, door to storage cupboard and door through to

#### Kitchen/Dining Room

Matching wall and base units with ample worksurfaces, 1½ bowl sink and drainer unit, 5-ring gas hob with electric double oven with extractor over, integrated fridge and freezer and space for washing machine, breakfast bar, window to the rear garden, window and door into the

#### Conservatory

Wooden flooring, windows and sliding door into the rear garden.

#### Downstairs WC

Tiled floor, low flush WC, wash hand-basin, radiator, window to the side aspect and cupboard housing the gas central heating boiler.

#### First floor landing

Fitted carpet, loft hatch with loft ladder, smoke alarm and doors to

#### Bedroom 1

Wooden flooring, radiator and window to the rear garden.

#### Bedroom 2

Wooden flooring, radiator, window to the front aspect and built-in storage cupboards.

#### Bedroom 3

Wooden flooring, radiator and window to the front aspect.

### Bathroom

Suite comprising panelled bath with mains fitment shower over, vanity wash hand-basin, low flush WC, tiled floor, tiled surround, heated towel rail, recessed spotlighting, extractor and window to the side aspect.

### Outside

To the front of the property there is a concrete driveway with parking for several vehicles leading to the garage electric roller door with access to the rear garden. The remainder of the front garden is laid with gravel and chippings for low maintenance with a range of plants and shrubs. To the rear of the property there is a low maintenance southfacing garden with a paved patio area - perfect for entertaining with the remainder of the garden laid to gravel. There is a rear access door into the garage. Outside tap.

### General information

#### Services

Mains water, electricity, drainage and gas are connected. Telephone (subject to transfer regulations). Gas-fired central heating.

#### Outgoings

Council tax band C - payable 2023/24 £1957.66

Water and drainage - rates are payable/metered supply.

#### Money laundering regulations

Prospective purchasers will be asked to produce identification, address verification and proof of funds at the time of making an offer.

### Ground Floor

Approx. 44.8 sq. metres (482.6 sq. feet)

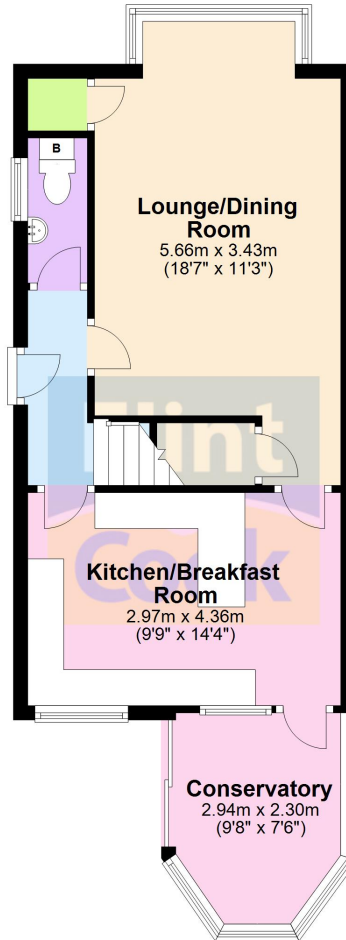

### First Floor

Approx. 37.6 sq. metres (405.1 sq. feet)



### Garage

Approx. 12.2 sq. metres (131.4 sq. feet)

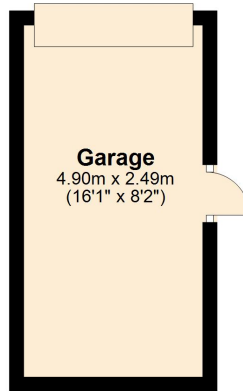

Total area: approx. 94.7 sq. metres (1019.1 sq. feet)

This plan is for illustrative purposes only  
Plan produced using PlanUp.

These particulars are prepared for the guidance only of prospective purchasers. They are intended to give a fair and overall description of the property and do not constitute the whole or any part of an offer or contract. Any information contained herein (whether in text, plans or photographs) is given in good faith but should not be relied upon as being a statement or representation of fact. Any plans provided by the agents and/or with the sales particulars are intended for guidance purposes only; we cannot guarantee the accuracy and scale of any plans, and they do not form any part of the sales contract. Nothing in these particulars shall be deemed to be a statement that the property is in good condition or otherwise nor that any services or facilities are in good working order. Any movable contents, fixtures and fittings, (whether wired or not) referred to in these property particulars (including any shown in the photographs) are, unless the particulars say otherwise, excluded from the sale. In the event that the buyer proposes to purchase any movable contents or include them in any offer for the property, the buyer cannot in any respect imply any such inclusion from the property particulars. Any areas, measurements or distances referred to herein are approximate only and may be subject to amendment. It should not be assumed that the property has all necessary planning, building regulation or other consents and these matters must be verified by an intending purchaser. The information in these particulars is given without responsibility on the part of the agents or their clients and neither the agents nor their employees have any authority to make or give any representations or warranties whatever in relation to this property.

**Flint & Cook Privacy Statement:** We take your privacy very seriously. Your data will not be shared with any other parties without your express permission. Our Data protection Policy can be read in full on the Flint & Cook website, [www.flintandcook.co.uk](http://www.flintandcook.co.uk)

| Energy Efficiency Rating                    |          | Current                 | Potential   |
|---|----------|-------------------------|---|
| Very energy efficient - lower running costs |          |                         |   |
| (92+)                                       | <b>A</b> |                         | <b>86</b>   |
| (81-91)                                     | <b>B</b> |                         |   |
| (69-80)                                     | <b>C</b> |                         |   |
| (55-68)                                     | <b>D</b> |                         |   |
| (39-54)                                     | <b>E</b> |                         |   |
| (21-38)                                     | <b>F</b> |                         | <b>72</b>   |
| (1-20)                                      | <b>G</b> |                         |   |
| Not energy efficient - higher running costs |          |                         |   |
| England, Scotland & Wales                   |          | EU Directive 2002/91/EC |  |