

FOR  
SALE



20 Blakemore Close, Hereford HR2 7HZ

£92,500 - Leasehold

22, Broad Street, Hereford, HR4 9AP 01432 355455 [hereford@flintandcook.co.uk](mailto:hereford@flintandcook.co.uk)

## PROPERTY SUMMARY

A first floor flat in popular residential location with one bedroom, lounge, kitchen, bathroom, double glazing, electric heating, allocated parking, garden.

## POINTS OF INTEREST

- *First floor flat*
- *1.5 miles from the City centre*
- *Allocated parking & gardens*
- *NO ONWARD CHAIN*
- *Electric heating*
- *Double glazing*
- *Viewing advised*
- *Close to amenities*



## ROOM DESCRIPTIONS

### **Entrance door leads into the**

#### **Entrance Hall**

With electric heater, fuse board, fitted carpet and staircase leading to the first floor.

#### **Landing**

With door leading into the

#### **Hallway**

Wooden flooring, electric heater, loft hatch, smoke alarm and door to the

#### **Living Room**

Wooden flooring, 2 electric heaters, double glazed window and opening into the

#### **Kitchen**

Vinyl flooring, matching wall and base units with ample worksurfaces, single sink with mixer tap over, 4-ring electric hob and electric oven, tiled splashbacks, double glazed window, pantry-style cupboard, under-counter space for fridge and washing machine.

#### **Bedroom**

Wooden flooring, electric heater, double glazed window and built-in wardrobes and cupboard space.

#### **Bathroom**

Suite comprising panelled bath with electric shower over, low level WC, pedestal wash hand-basin, vinyl flooring extractor fan.

#### **Outside**

The property has the benefit of allocated parking and use of a rear garden.

#### **Tenure & Possession**

Leasehold with 141 years remaining.

Service charge and Ground rent payable £200 per annum – vacant possession on completion.

## First Floor

Approx. 34.8 sq. metres (374.9 sq. feet)

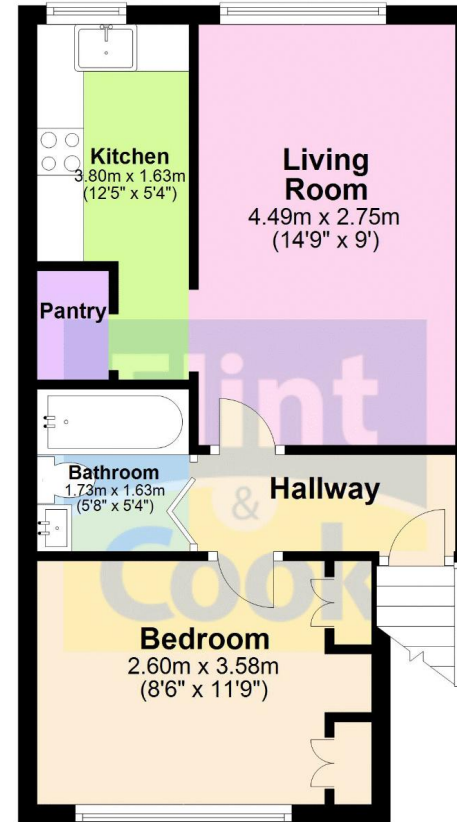

## Ground Floor

Approx. 2.3 sq. metres (24.4 sq. feet)

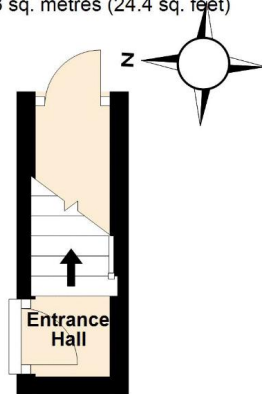

Total area: approx. 37.1 sq. metres (399.2 sq. feet)

This plan is for illustrative purposes only  
Plan produced using PlanUp.

These particulars are prepared for the guidance only of prospective purchasers. They are intended to give a fair and overall description of the property and do not constitute the whole or any part of an offer or contract. Any information contained herein (whether in text, plans or photographs) is given in good faith but should not be relied upon as being a statement or representation of fact. Any plans provided by the agents and/or with the sales particulars are intended for guidance purposes only; we cannot guarantee the accuracy and scale of any plans, and they do not form any part of the sales contract. Nothing in these particulars shall be deemed to be a statement that the property is in good condition or otherwise nor that any services or facilities are in good working order. Any movable contents, fixtures and fittings, (whether wired or not) referred to in these property particulars (including any shown in the photographs) are, unless the particulars say otherwise, excluded from the sale. In the event that the buyer proposes to purchase any movable contents or include them in any offer for the property, the buyer cannot in any respect imply any such inclusion from the property particulars. Any areas, measurements or distances referred to herein are approximate only and may be subject to amendment. It should not be assumed that the property has all necessary planning, building regulation or other consents and these matters must be verified by an intending purchaser. The information in these particulars is given without responsibility on the part of the agents or their clients and neither the agents nor their employees have any authority to make or give any representations or warranties whatever in relation to this property.

**Flint & Cook Privacy Statement:** We take your privacy very seriously. Your data will not be shared with any other parties without your express permission. Our Data protection Policy can be read in full on the Flint & Cook website, [www.flintandcook.co.uk](http://www.flintandcook.co.uk)

| Energy Efficiency Rating                    |           |                         |
|---|-----------|-------------------------|
|   | Current   | Potential               |
| Very energy efficient - lower running costs |           |                         |
| (92+)<br><b>A</b>                           |           | <b>80</b>               |
| (81-91)<br><b>B</b>                         |           |                         |
| (69-80)<br><b>C</b>                         |           |                         |
| (55-68)<br><b>D</b>                         |           |                         |
| (39-54)<br><b>E</b>                         | <b>60</b> |                         |
| (21-38)<br><b>F</b>                         |           |                         |
| (1-20)<br><b>G</b>                          |           |                         |
| Not energy efficient - higher running costs |           |                         |
| England, Scotland & Wales                   |           |                         |
|   |           | EU Directive 2002/91/EC |