

Energy Efficiency Rating		Current	Potential
Very energy efficient - lower running costs			
(92 plus) A		82	82
(81-91) B			
(69-80) C			
(55-68) D			
(39-54) E			
(21-38) F			
(1-20) G			

Environmental Impact (CO ₂) Rating		Current	Potential
Very environmentally friendly - lower CO ₂ emissions			
(92 plus) A			
(81-91) B			
(69-80) C			
(55-68) D			
(39-54) E			
(21-38) F			
(1-20) G			

Chamberlayne Road, London, NW10 3ND

**Offers In Excess Of
£550,000**
Subject to Contract

- Two double bedroom, one of which has fitted wardrobes
- Bright sizable reception room with fine hessian wallpaper
- Corian fitted kitchen with marble splash back
- Fully tiled family bathroom
- Oak fitted wood flooring
- In the heart of Kensal Rise

We have endeavoured to supply this information as accurate as possible. Before making an offer, buying or renting this property please seek independent or professional advice.



Tel: +44 (0)2 8960 9988
Fax: +44 (0)2 8960 9989

Email: mail@warwickstateagency.co.uk
warwickstateagents.tv | warwickstateagents.co.uk

69 Chamberlayne Road, London NW10 3ND
Tel: +44 (0)20 8960 9988 Fax: +44 (0)20 8960 9989

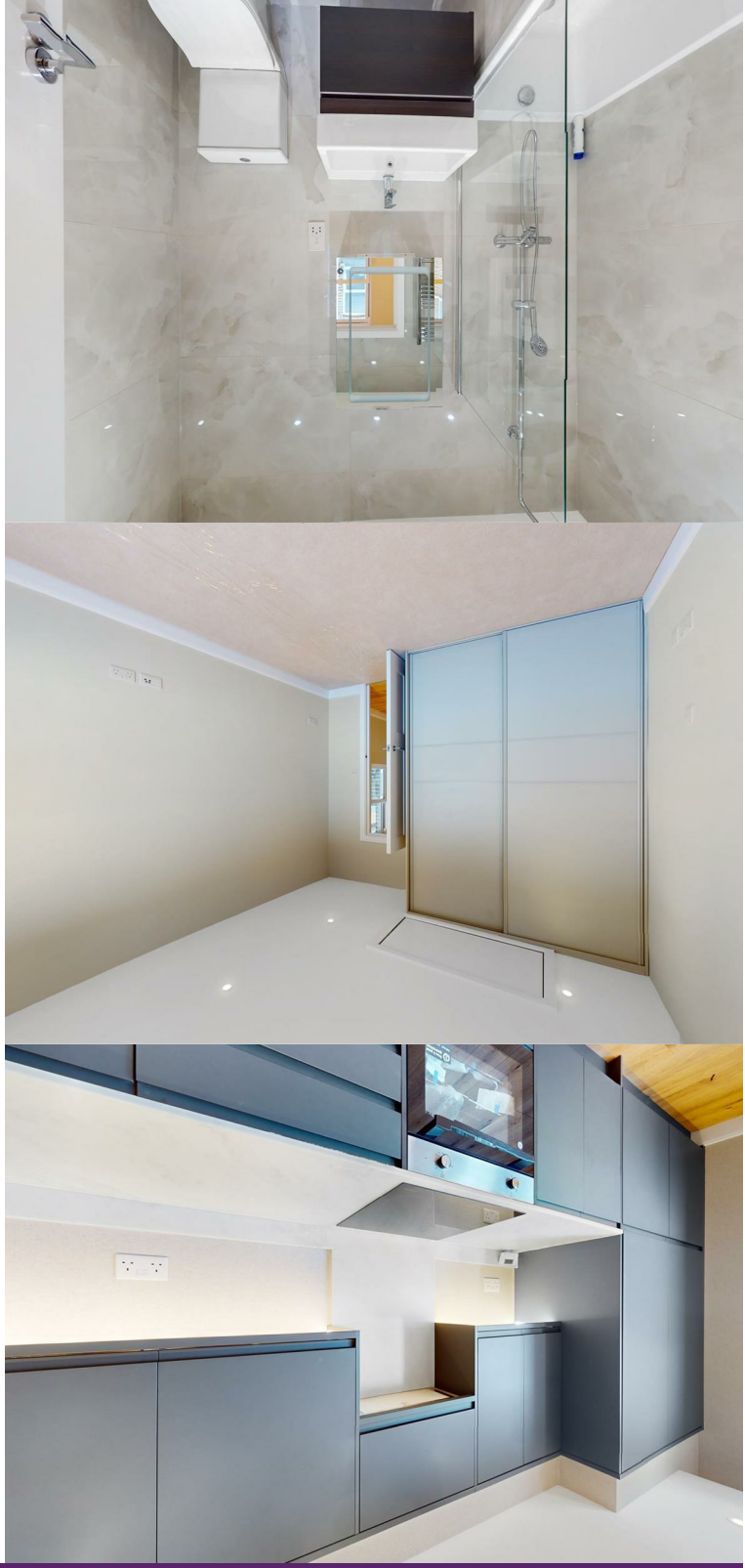

Chamberlayne Road, NW10 3ND

Development of five luxury apartments over three floors... architecturally designed two double bedrooms finished to a high specification. Accessed via video entry-phone intercom from street level with marble worktops and bespoke fitted wardrobes in the main bedrooms. In the heart of this buzzing, trendy metropolis, with good transport links and a variety of bars/cafes and restaurants at your fingertips.

The properties range from 622 sq ft up to 747 sq ft of split-level living/entertaining space with low voltage lighting and double-glazed sash windows throughout. Sizeable reception rooms with dining area, with stylish fine hessian wallpaper, integrated appliances in a fully fitted contemporary style Corian kitchen and oak wooden flooring, fully tiled with large marble style slabs in the bathrooms, and carpets in the bedrooms, creating a warm and tranquil atmosphere.

Flat 3, 69-71 Chamberlayne Road, London, NW10 3ND

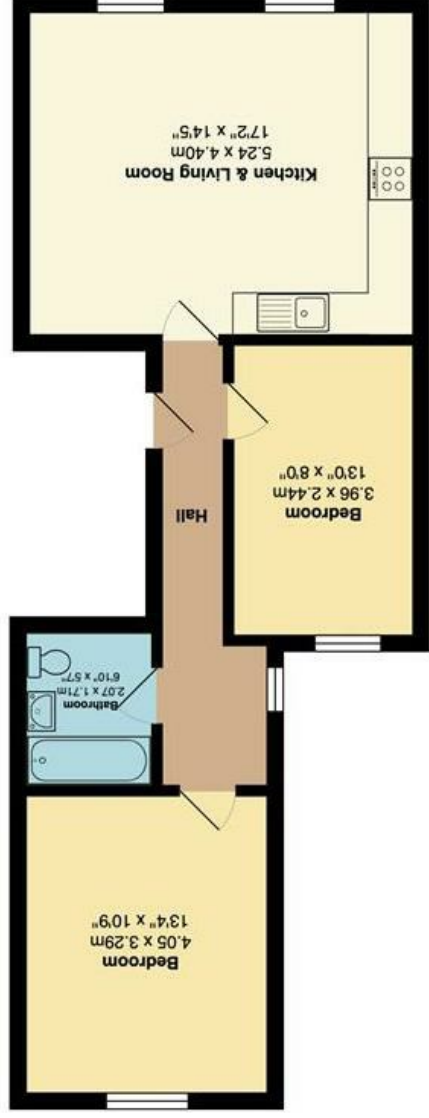

Total Area: 57.8 m² ... 622 ft²

All measurements are approximate and for display purposes only

69 Chamberlayne Road, London NW10 3ND
 Email: mail@warwickestateagency.co.uk
 warwickestateagents.tv | warwickestateagents.co.uk
 Tel: +44 (0)20 8960 9988 Fax: +44 (0)20 8960 9989

Tel: +44 (0)2 8960 9988
 Fax: +44 (0)2 8960 9989

