

Energy Efficiency Rating	
	Potential
Very energy efficient - lower running costs	
(92 plus) A	
(81-91) B	
(69-80) C	
(55-68) D	
(39-54) E	
(21-38) F	
(1-20) G	

Environmental Impact (CO ₂) Rating	
	Potential
Very environmentally friendly - lower CO ₂ emissions	
(92 plus) A	
(81-91) B	
(69-80) C	
(55-68) D	
(39-54) E	
(21-38) F	
(1-20) G	

We have endeavoured to supply this information as accurate as possible. Before making an offer, buying or renting this property please seek independent or professional advice.

Banister Road, Queens Park, W10 4AR

£2,150 PCM

Subject to Contract

- Two double bedrooms
- Granite worktops in kitchen
- Solid Oak floorings throughout * Lift
- Video entryphone
- Full length windows in sizable reception
- Two modern en suite bathrooms
- Central courtyards
- Low voltage lighting



Tel: +44 (0)2 8960 9988
Fax: +44 (0)2 8960 9989

Email: mail@warwickstateagency.co.uk
warwickstateagents.tv | warwickstateagents.co.uk

69 Chamberlayne Road, London NW10 3ND
Tel: +44 (0)20 8960 9988 Fax: +44 (0)20 8960 9989



Tel: +44 (0)2 8960 9988
Fax: +44 (0)2 8960 9989

Email: mail@warwickestateagency.co.uk
warwickestateagents.tv | warwickestateagents.co.uk
69 Chamberlayne Road, London NW10 3ND
Tel: +44 (0)20 8960 9988 Fax: +44 (0)20 8960 9989



Banister Road, W10 4AR

Warehouse style apartment... offering a spacious, well-proportioned two double bedroom property, on the second floor of this modern, gated development with lift access, featuring seating in a central courtyard with wood paneled walkways on steel beams.

The property offers floor-to-ceiling windows in a sizable reception room with industrial-style high ceilings, Granite work surfaces in the kitchen with integrated appliances, two en suite modern bathrooms, and additional benefits include solid oak flooring throughout. Fantastic location, in close proximity to an assortment of bars/cafes and restaurants. A stone's throw from Kensal Green (Bakerloo Line) tube, Kensal Rise Overland station, and Ladbroke Grove & Portobello market is close at hand.

Available 8 March 2023



BANISTER ROAD, W10
TOTAL APPROX. FLOOR AREA 661 SQ.FT. (61.4 SQ.M.)

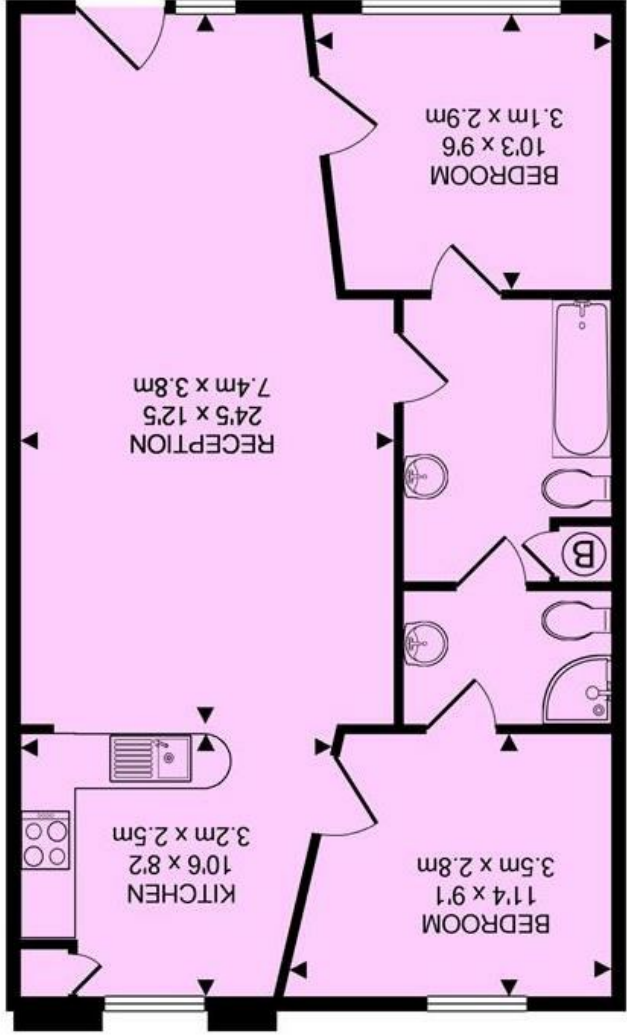

SECOND FLOOR

All measurements walls, doors, windows, fittings and their appliances, their size and locations are shown conventionally and are approximate only and cannot be regarded as being a representation either by the seller or his agent nor zentuvo
www.zentuvo.co.uk

