



## 30 Broadlands Holiday Park & Marina Marsh Road Oulton Broad, Lowestoft, NR33 9JY

£70,000



The property comprises of 2 double bedrooms, bedroom furniture and storage, the kitchen features a glass hob and built in electric oven and an under counter fridge. The spacious lounge, offers a sofa, flat screen television, dining table and chairs with patio doors leading on to the gated decking area, overlooking Oulton Broad. The bathroom has a suite of a hand basin, W.C and stand alone shower. The property is fully insulated and all windows and doors are Upvc double glazed.

Offered on a 125 year lease, (commenced 01/06/2016, 117 Years remaining) and 12 months of the year holiday home usage.

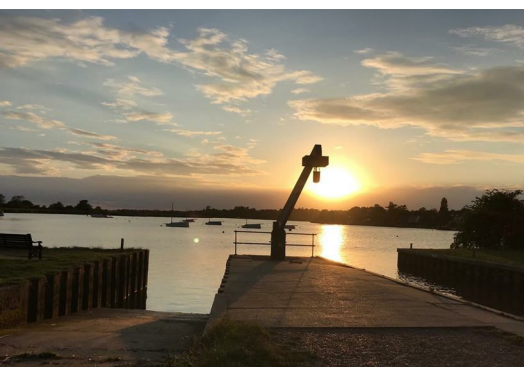

Lounge/Diner 15'1" x 13'6" (4.62 x 4.14)

Kitchen 6'9" x 6'7" (2.07 x 2.02)

Bedroom 1 10'6" x 10'1" (3.22 x 3.08)

Bedroom 2 10'6" x 9'7" (3.21 x 2.94)

Shower Room/W.C 6'7" x 5'2" (2.01 x 1.59)

### Services & Charges

Ground Rent: £3207.32 + vat P.A

Service Charge: £994.11 + vat P.A

Leasehold - 125 Years From 2016

Council Tax Band A

Electric: billed as used per quarter

### Area Map

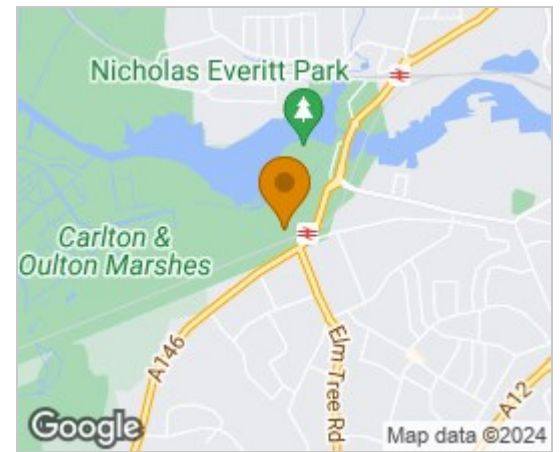

### Floor Plans

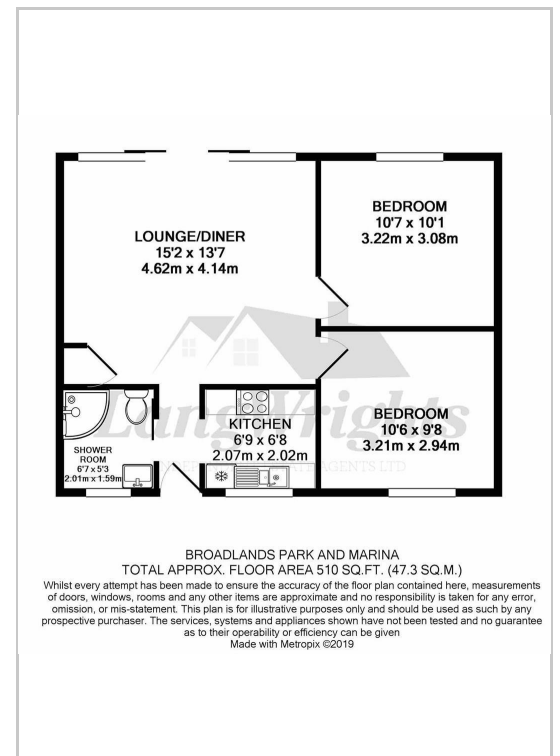

### Energy Efficiency Graph

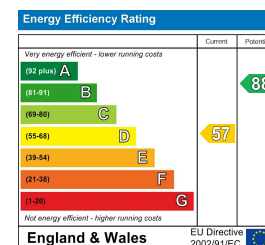

#### Disclaimer

These particulars are issued on an understanding that all negotiations shall be conducted through Messrs. Aldreds. Please note: Messrs. Aldreds for themselves and for the vendors or lessors of this property whose agents they are given notice that: 1. Particulars are set out as a general outline only for guidance of intending purchasers or lessees, and do not constitute nor constitute part of, an offer or contract. 2. All descriptions, dimensions, references to condition and necessary permissions for use and occupation, and other details are given without responsibility and any intending purchasers or tenants should not rely on them as statements or representations of fact but must satisfy themselves by inspection or otherwise as to the correctness of each of them. 3. No person in the employment of Messrs. Aldreds has any authority to make or give any representation or warranty whatever in relation to this property. 4. If you are proposing to visit the property and are travelling some distance please check with Aldreds on the issue of availability prior to travelling. 5. Aldreds Property Consultants and associated services may offer additional services to the prospective purchaser for which they will be entitled to receive a commission.

Aldreds are pleased to be working with Mortgage Advice Bureau. They're an award-winning mortgage broker with over 1,400 advisers across the UK, and have access to over 12,000 mortgage products from over 90 lenders. Aldreds Estate Agents Ltd receive a commission of £200 on each completed case. Your home may be repossessed if you do not keep up repayments on your mortgage. There may be a fee for mortgage advice. The actual amount you pay will depend upon your circumstances. The fee is up to 1%, but a typical fee is 0.3% of the amount borrowed. Mortgage Advice Bureau is a trading name of Mortgage Seeker Limited which is an appointed representative of Mortgage Advice Bureau Limited and Mortgage Advice Bureau (Derby) Limited which are authorised and regulated by the Financial Conduct Authority. Mortgage Seeker Limited Registered Office: Lovewell Blake, Sixty Six North Quay, Great Yarmouth, Norfolk, NR30 1HE. Registered in England Number: 03721415. 6. Potential purchasers should check with their providers that the broadband and mobile phone coverage they would require is available.

143 London Road North, Lowestoft, Suffolk, NR32 1NE

Tel: 01502 565432 Email: [lowestoft@aldreds.co.uk](mailto:lowestoft@aldreds.co.uk) <https://www.aldreds.co.uk/>

Registered in England Reg. No. 08945751 Registered Office: 66 North Quay, Great Yarmouth, Norfolk NR30 1HE Directors: Mark Duffield B.S.c. FRICS. Dan Crawley MNAEA Paul Lambert MNAEA