



18 Waterside Holiday Park

Corton, Lowestoft, NR32 5HS

£80,000



This fully furnished and very well presented holiday villa benefits a 45 year lease and Upvc double glazing throughout. The villa comprises open plan living with the kitchen area. Ceramic hob with electric oven under, integrated washing machine and fridge. A modern bathroom suite comprising panel bath, low level W.C. pedestal sink. On the first floor there are 2 double bedrooms and 1 single, cupboards, storage options and a balcony off the main bedroom to enjoy elevated peace and tranquility. Outside there is a spacious gated, wraparound decking area to enjoy summer dining and socialising. With many beautiful surroundings and exciting attractions and with a main route bus stop at the park entrance, the popular resorts of Southwold, Lowestoft, Gorleston and Great Yarmouth are easily accessible so you will never be short of something to do. On site facilities include a heated covered swimming pool, refurbished bar and restaurant, amusements, launderette and more! With all these options of things to do, there is guaranteed fun for all the family all year round.



Lounge/Diner 15'8" x 14'5" (4.8 x 4.4)

Kitchen 5'10" x 6'10" (1.8 x 2.1)

Bathroom 5'10" x 7'6" (1.8 x 2.3)

Bedroom 1 11'1" x 9'2" (3.4 x 2.8)

Bedroom 2 9'10" x 8'2" (3.0 x 2.5)

Bedroom 3 6'10" x 6'2" (2.1 x 1.9)

Services & Charges

Ground Rent: £1748.18 (inc. VAT)

Service Charge: £3,261.91 (inc VAT) (Includes water rates & buildings insurance)

Electricity: as used (billed quarterly)

Council Tax: Band A (billed by East Suffolk Council)

Leasehold

Mains Water Electricity and Drainage

Area Map



Floor Plans

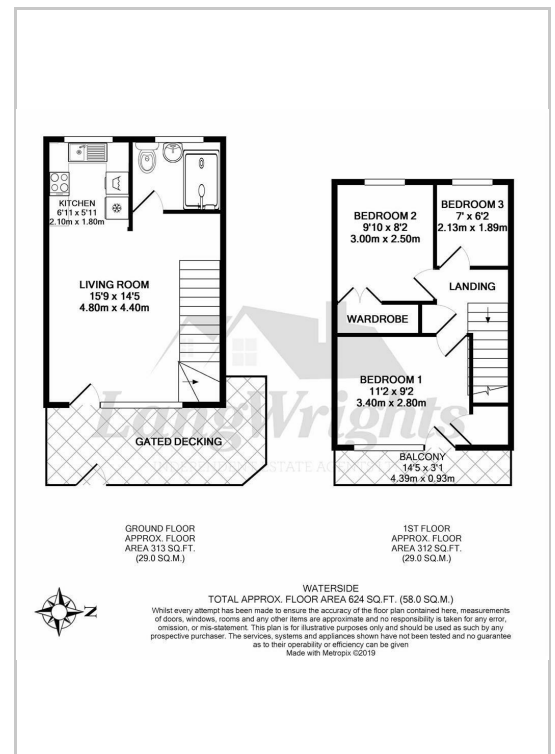

Energy Efficiency Graph

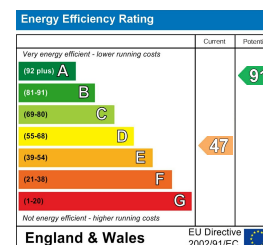

Disclaimer

These particulars are issued on an understanding that all negotiations shall be conducted through Messrs. Aldreds. Please note: Messrs. Aldreds for themselves and for the vendors or lessors of this property whose agents they are given notice that: 1. Particulars are set out as a general outline only for guidance of intending purchasers or lessees, and do not constitute nor constitute part of, an offer or contract. 2. All descriptions, dimensions, references to condition and necessary permissions for use and occupation, and other details are given without responsibility and any intending purchasers or tenants should not rely on them as statements or representations of fact but must satisfy themselves by inspection or otherwise as to the correctness of each of them. 3. No person in the employment of Messrs. Aldreds has any authority to make or give any representation or warranty whatever in relation to this property. 4. If you are proposing to visit the property and are travelling some distance please check with Aldreds on the issue of availability prior to travelling. 5. Aldreds Property Consultants and associated services may offer additional services to the prospective purchaser for which they will be entitled to receive a commission.

Aldreds are pleased to be working with Mortgage Advice Bureau. They're an award-winning mortgage broker with over 1,400 advisers across the UK, and have access to over 12,000 mortgage products from over 90 lenders. Aldreds Estate Agents Ltd receive a commission of £200 on each completed case. Your home may be repossessed if you do not keep up repayments on your mortgage. There may be a fee for mortgage advice. The actual amount you pay will depend upon your circumstances. The fee is up to 1%, but a typical fee is 0.3% of the amount borrowed. Mortgage Advice Bureau is a trading name of Mortgage Seeker Limited which is an appointed representative of Mortgage Advice Bureau Limited and Mortgage Advice Bureau (Derby) Limited which are authorised and regulated by the Financial Conduct Authority. Mortgage Seeker Limited Registered Office: Lovewell Blake, Sixty Six North Quay, Great Yarmouth, Norfolk, NR30 1HE. Registered in England Number: 03721415. 6. Potential purchasers should check with their providers that the broadband and mobile phone coverage they would require is available.

143 London Road North, Lowestoft, Suffolk, NR32 1NE
Tel: 01502 565432 Email: lowestoft@aldreds.co.uk <https://www.aldreds.co.uk/>

Registered in England Reg. No. 08945751 Registered Office: 66 North Quay, Great Yarmouth, Norfolk NR30 1HE Directors: Mark Duffield B.S.c. FRICS. Dan Crawley MNAEA Paul Lambert MNAEA