



Thatch End Boathouse Lane

Oulton Broad, Lowestoft, NR32 3PP

£125,000



*** LAND WITH BROADS FRONTAGE & LARGE THATCHED RIVER CABIN & MOORINGS *** Aldreds are delighted to offer this freehold plot of land located in Boathouse Lane. The land fronts on to the Broads with moorings along the key headings for up to 4 boats. There is also the benefit of a substantial 2 Storey Thatched Roof Riverside Cabin being ideal for a variety of uses. There is a WC and shower room within the cabin. Please note mains drains and power are not available in Boathouse Lane therefore the cabin has been powered via a generator. ** EARLY VIEWING A MUST **



Riverside Cabin 17'10" x 17'11" (5.46 x 5.47)

The Riverside Cabin is set over 2 floors with solid timber windows offering beautiful views over the Broads. The cabin is accessed via the double front doors. To the far rear there is a shower room with toilet and sink. This cabin could be suitable for a variety of uses. The former owners have built in some day beds and living space.

The Moorings

The land fronts Oulton Broad with solid key headings and pontoon giving the options for mooring several boats.

The Land

This generous plot is accessed via double gates leading off Boathouse Lane with full vehicular access along the unmade private road. The land is laid to grass leading down to the Broads frontage and slipway.

Area Map

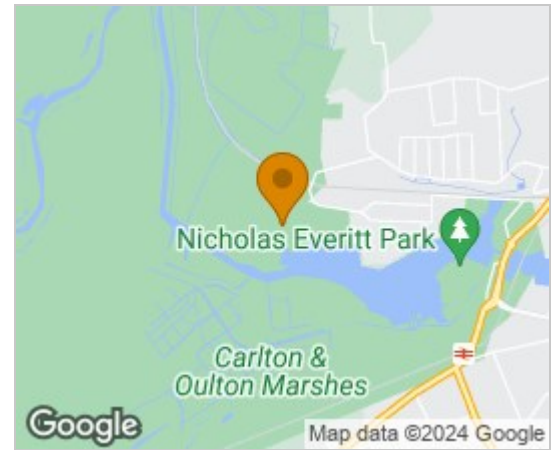

Floor Plans

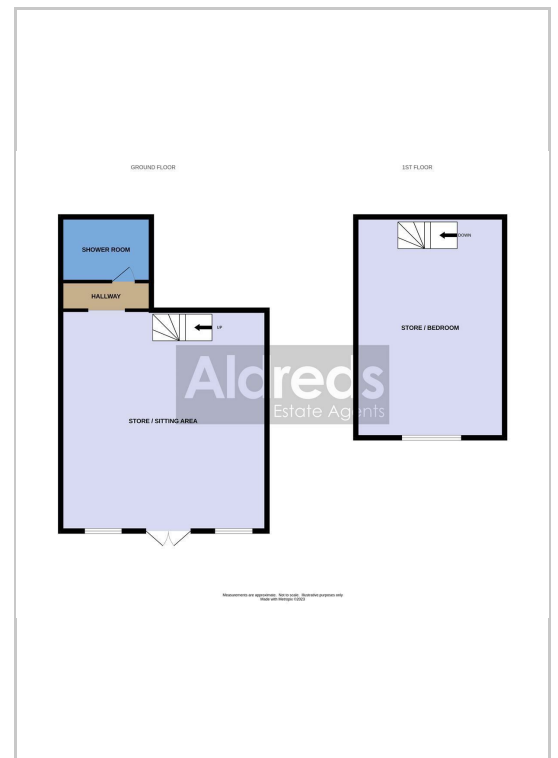

Energy Efficiency Graph

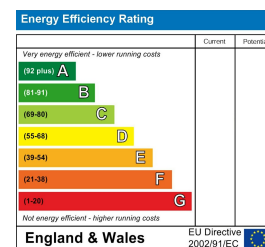

Disclaimer

These particulars are issued on an understanding that all negotiations shall be conducted through Messrs. Aldreds. Please note: Messrs. Aldreds for themselves and for the vendors or lessors of this property whose agents they are given notice that: 1. Particulars are set out as a general outline only for guidance of intending purchasers or lessees, and do not constitute nor constitute part of, an offer or contract. 2. All descriptions, dimensions, references to condition and necessary permissions for use and occupation, and other details are given without responsibility and any intending purchasers or tenants should not rely on them as statements or representations of fact but must satisfy themselves by inspection or otherwise as to the correctness of each of them. 3. No person in the employment of Messrs. Aldreds has any authority to make or give any representation or warranty whatever in relation to this property. 4. If you are proposing to visit the property and are traveling some distance please check with Aldreds on the issue of availability prior to traveling. 5. Aldreds Property Consultants and associated services may offer additional services to the prospective purchaser for which they will be entitled to receive a commission.

Aldreds are pleased to be working with Mortgage Advice Bureau. They're an award-winning mortgage broker with over 1,400 advisers across the UK, and have access to over 12,000 mortgage products from over 90 lenders. Aldreds Estate Agents Ltd receive a commission of £200 on each completed case. Your home may be repossessed if you do not keep up repayments on your mortgage. There may be a fee for mortgage advice. The actual amount you pay will depend upon your circumstances. The fee is up to 1%, but a typical fee is 0.3% of the amount borrowed. Mortgage Advice Bureau is a trading name of Mortgage Seeker Limited which is an appointed representative of Mortgage Advice Bureau Limited and Mortgage Advice Bureau (Derby) Limited which are authorised and regulated by the Financial Conduct Authority. Mortgage Seeker Limited Registered Office: Lovewell Blake, Sixty Six North Quay, Great Yarmouth, Norfolk, NR30 1HE. Registered in England Number: 372141. 6. Potential purchasers should check with their providers that the broadband and mobile phone coverage they would require is available.

143 London Road North, Lowestoft, Suffolk, NR32 1NE
Tel: 01502 565432 Email: lowestoft@aldreds.co.uk <https://www.aldreds.co.uk/>

Registered in England Reg. No. 08945751 Registered Office: 66 North Quay, Great Yarmouth, Norfolk NR30 1HE Directors: Mark Duffield B.S.c. FRICS. Dan Crawley MNAEA Paul Lambert MNAEA