



6a Beach Farm Arbor Lane

Pakefield, Lowestoft, NR33 7BD

£65,000



Aldreds are pleased to offer this 1 bed roomed mobile home with full residential use situated on the very popular Beach Farm Park being within a very short walk of the Pakefield beach, seafront and promenade. This mobile home is presented to an immaculate standard throughout with quality fixtures and fittings, with all integral kitchen appliances included in the asking price. The accommodation includes entrance hall, large open plan lounge/kitchen/dining area, quality fitted bathroom and bedroom with fitted wardrobes. To the outside there is a modern veranda with plenty of outside space including a driveway for 2 cars and outside gardens providing ample space for outdoor furniture. Set at a very realistic and affordable asking price. Early viewing is strongly recommended.



Open Plan Lounge/Kitchen Dining Area 15'4" x 9'2" (4.69 x 2.80)

Fitted carpet, coved ceiling, double aspect windows, fire place, Upvc door leading to veranda.

Kitchen/Dining Area

Timber effect vinyl flooring, full range of modern fitted kitchen units including a full range of integral appliances including fridge/freezer, washing machine, electric oven, matching 4 burner gas hob, stainless steel splash back, extraction cooker hood, stainless steel sink with single drainer, Upvc window, radiator, ample space for dining table and chairs.

Inner Hallway

Fitted carpet, Upvc door leading to the veranda.

Bedroom 9'1" x 9'2" (2.79 x 2.80)

Fitted carpet, full range of fitted wardrobes, coved ceiling, Upvc window, radiator, full length airing cupboard.

Bathroom

Timber effect vinyl flooring, white bathroom suite comprising of shower over a panel bath, pedestal sink, low level W.C, part tiled walls, radiator, Upvc window, coved ceiling, extractor fan.

Outside

There is a modern raised veranda providing ample space for outside seating, shingled driveway providing off road parking. To the side and rear there is a shingled patio garden providing further space for outside furniture, modern metal storage shed.

Outgoings

Site Fees approx. £160pcm

Freehold Mobile Home But Subject To Beach Farms Site Rules And Fees

Fully Residential Use

Area Map



Floor Plans

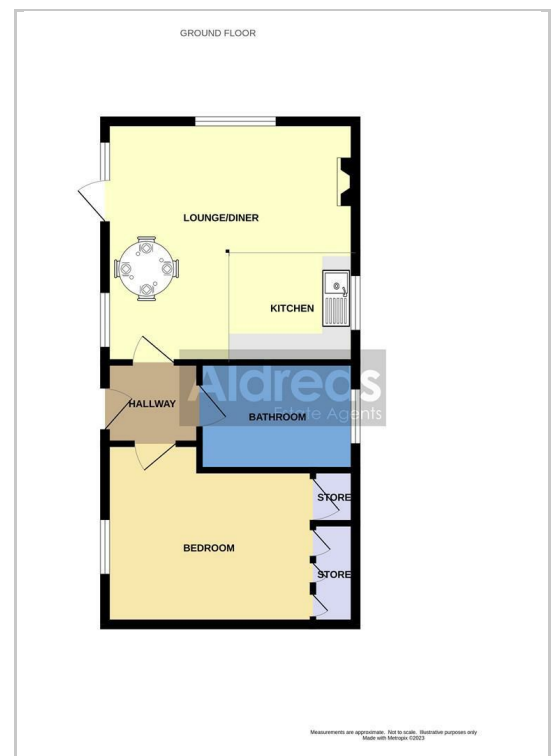

Energy Efficiency Graph

Disclaimer

These particulars are issued on an understanding that all negotiations shall be conducted through Messrs. Aldreds. Please note: Messrs. Aldreds for themselves and for the vendors or lessors of this property whose agents they are given notice that: 1. Particulars are set out as a general outline only for guidance of intending purchasers or lessees, and do not constitute nor constitute part of, an offer or contract. 2. All descriptions, dimensions, references to condition and necessary permissions for use and occupation, and other details are given without responsibility and any intending purchasers or tenants should not rely on them as statements or representations of fact but must satisfy themselves by inspection or otherwise as to the correctness of each of them. 3. No person in the employment of Messrs. Aldreds has any authority to make or give any representation or warranty whatever in relation to this property. 4. If you are proposing to visit the property and are traveling some distance please check with Aldreds on the issue of availability prior to traveling. 5. Aldreds Property Consultants and associated services may offer additional services to the prospective purchaser for which they will be entitled to receive a commission.

Aldreds are pleased to be working with Mortgage Advice Bureau. They're an award-winning mortgage broker with over 1,400 advisers across the UK, and have access to over 12,000 mortgage products from over 90 lenders. Aldreds Estate Agents Ltd receive a commission of £200 on each completed case. Your home may be repossessed if you do not keep up repayments on your mortgage. There may be a fee for mortgage advice. The actual amount you pay will depend upon your circumstances. The fee is up to 1%, but a typical fee is 0.3% of the amount borrowed. Mortgage Advice Bureau is a trading name of Mortgage Seeker Limited which is an appointed representative of Mortgage Advice Bureau Limited and Mortgage Advice Bureau (Derby) Limited which are authorised and regulated by the Financial Conduct Authority. Mortgage Seeker Limited Registered Office: Lovewell Blake, Sixty Six North Quay, Great Yarmouth, Norfolk, NR30 1HE. Registered in England Number: 372141. 6. Potential purchasers should check with their providers that the broadband and mobile phone coverage they would require is available.

143 London Road North, Lowestoft, Suffolk, NR32 1NE

Tel: 01502 565432 Email: lowestoft@aldreds.co.uk <https://www.aldreds.co.uk/>

Registered in England Reg. No. 08945751 Registered Office: 66 North Quay, Great Yarmouth, Norfolk NR30 1HE Directors: Mark Duffield B.S.c. FRICS. Dan Crawley MNAEA Paul Lambert MNAEA