



24 Gresham Close

Gorleston, Great Yarmouth, NR31 7DY

£325,000



## 24 Gresham Close

Gorleston, Great Yarmouth, NR31 7DY

A spacious and well presented three bedroom detached bungalow sitting on the very popular Gresham Close. The property offers an entrance hall, lounge, conservatory, kitchen, three bedrooms and a shower room. Driveway leading to a tandem garage. Gas central heating and sealed unit double glazing. Gardens to front & rear.

### Entrance Hall

Entrance door, storage cupboard, loft access.

### Lounge

14'2" x 11'7" plus recess (4.33 x 3.54 plus recess)

Radiator, door to kitchen, bi folding doors to conservatory.

### Conservatory

12'1" x 7'8" (3.7 x 2.35)

Brick based with sealed unit double glazing, door to side, double glazed French doors to garden.

### Kitchen

14'9" x 6'3" (4.52 x 1.91)

Base units with worktops, double glazed window to rear aspect, double glazed window to side aspect, gas cooker point, storage cupboard housing both the plumbing for washing machine & wall mounted gas boiler, sink with drainer.

### Bedroom 1

15'5" x 12'11" (4.7 x 3.94)

Double glazed window to front aspect, radiator.

### Bedroom 2

10'5" x 10'0" (3.2 x 3.06)

Double glazed window to side aspect, radiator.

### Bedroom 3

12'11" x 4'5" (3.94 x 1.37)

Double glazed window to front aspect, double glazed window to side aspect, radiator.





### Shower Room

Shower in cubicle, hand basin, low level WC, tiled walls, opaque double glazed window to side aspect, heated towel rail.

### Outside

To the front there is a shingle garden. Driveway to tandem length garage (8.6m x 2.55m) with up & over door and power & light. To the rear there is a lawned garden with decked patio, vegetable patch and greenhouse.

### Tenure

Freehold.

### Services

Mains water, electricity, gas, drainage

### Council Tax

Band C

### EPC

D Rating - 64

### Location

Gorleston on Sea is a coastal town 2 miles from Great Yarmouth centre and has a varied selection of local shops \* Golf Course \* Modern District hospital \* Schools for all ages \* Library \* Regular bus services to the main shopping areas and a sandy beach.

### Directions

From the Gorleston office head south along the High Street, at the traffic lights turn right into Church Lane, at the roundabout turn left into Middleton Road, at the next roundabout turn right into Lowestoft Road, at the next traffic lights turn right into Brasenose Avenue, turn right in to Gresham Close.

Ref G18044/04/24



## Floor Plan

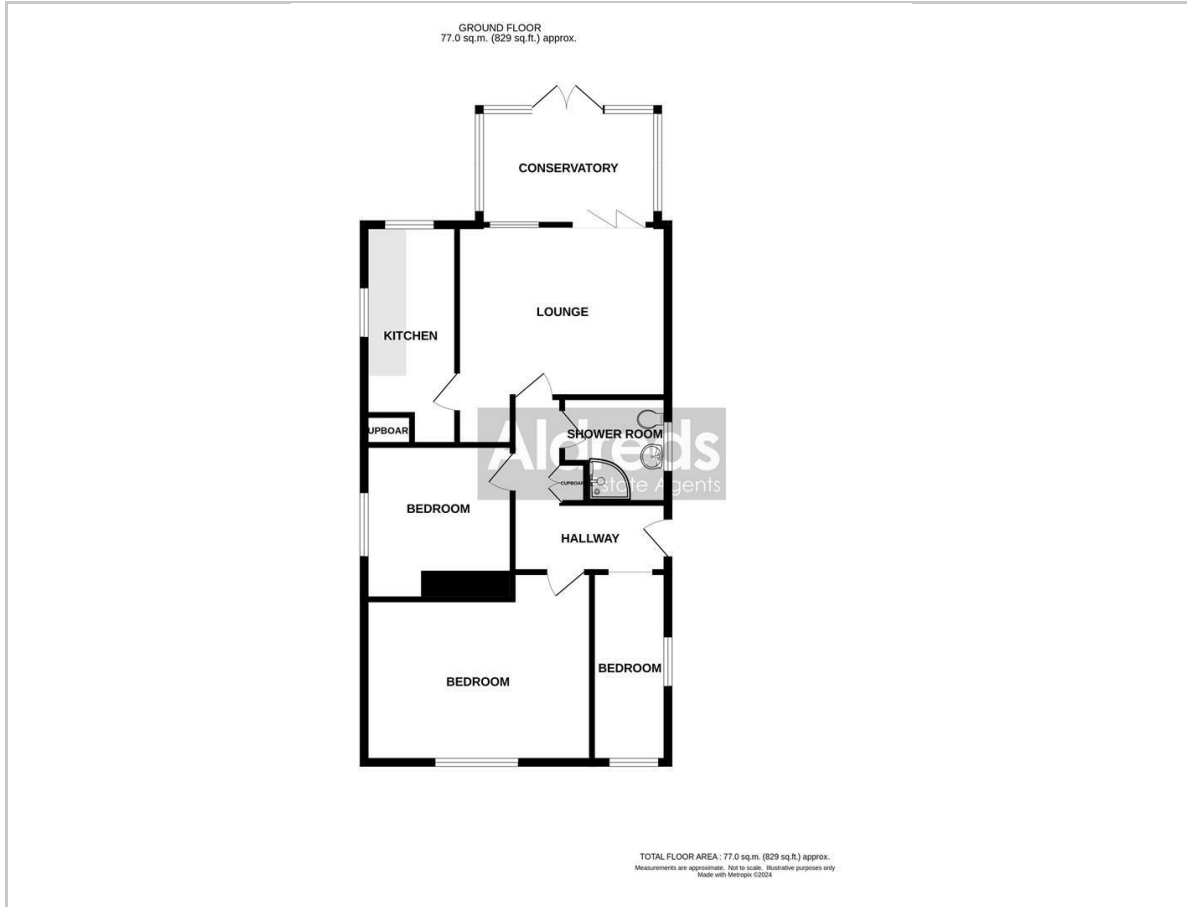

## Area Map

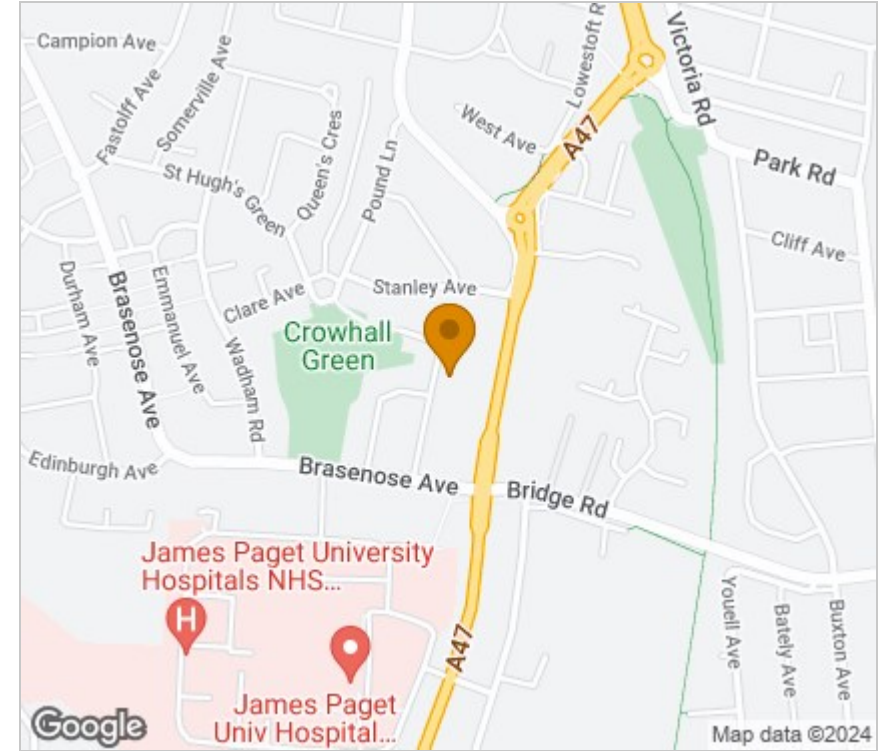

## Energy Efficiency Graph

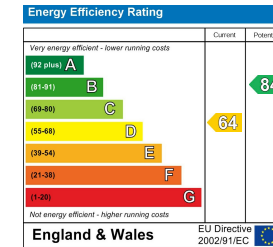

## Viewing

Please contact our Aldreds Gorleston Office on 01493 664600 if you wish to arrange a viewing appointment for this property or require further information.

### Disclaimer

These particulars are issued on an understanding that all negotiations shall be conducted through Messrs. Aldreds. Please note: Messrs. Aldreds for themselves and for the vendors or lessors of this property whose agents they are given notice that: 1. Particulars are set out as a general outline only for guidance of intending purchasers or lessees, and do not constitute nor constitute part of, an offer or contract. 2. All descriptions, dimensions, references to condition and necessary permissions for use and occupation, and other details are given without responsibility and any intending purchasers or tenants should not rely on them as statements or representations of fact but must satisfy themselves by inspection or otherwise as to the correctness of each of them. 3. No person in the employment of Messrs. Aldreds has any authority to make or give any representation or warranty whatever in relation to this property. 4. If you are proposing to visit the property and are travelling some distance please check with Aldreds on the issue of availability prior to travelling. 5. Aldreds Property Consultants and associated services may offer additional services to the prospective purchaser for which they will be entitled to receive a commission.

Aldreds are pleased to be working with Mortgage Advice Bureau. They're an award-winning mortgage broker with over 1,400 advisers across the UK, and have access to over 12,000 mortgage products from over 90 lenders. Aldreds Estate Agents Ltd receive a commission of £200 on each completed case. Your home may be repossessed if you do not keep up repayments on your mortgage. There may be a fee for mortgage advice. The actual amount you pay will depend upon your circumstances. The fee is up to 1%, but a typical fee is 0.3% of the amount borrowed. Mortgage Advice Bureau is a trading name of Mortgage Seeker Limited which is an appointed representative of Mortgage Advice Bureau Limited and Mortgage Advice Bureau (Derby) Limited which are authorised and regulated by the Financial Conduct Authority. Mortgage Seeker Limited Registered Office: Lovewell Blake, Sixty Six North Quay, Great Yarmouth, Norfolk, NR30 1HE. Registered in England Number: 03721415. 6. Potential purchasers should check with their providers that the broadband and mobile phone coverage they would require is available.

149 High Street, Gorleston, Norfolk, NR31 6RB  
Tel: 01493 664600 Email: [gorleston@aldreds.co.uk](mailto:gorleston@aldreds.co.uk) <https://www.aldreds.co.uk/>

Registered in England Reg. No. 08945751 Registered Office: 66 North Quay, Great Yarmouth, Norfolk NR30 1HE Directors: Mark Duffield B.S.c. FRICS. Dan Crawley MNAEA Paul Lambert MNAEA