



3 Charter Close

Gorleston, Great Yarmouth, NR31 7LD

£140,000



3 Charter Close

Gorleston, Great Yarmouth, NR31 7LD

A mature ex local authority two bedroom mid terrace house with driveway and garden. The property has an entrance hall, lounge, kitchen/diner, landing, two bedrooms and a bathroom. Sealed unit double glazing.

Entrance Hall

Door to front, stairs rising to landing.

Lounge

10'10" x 10'5" (3.32 x 3.2)

Double glazed window to front aspect.

Kitchen

16'6" x 9'11" (5.05 x 3.04)

Base units with worktops, double glazed window to rear aspect, electric cooker point, double glazed window to rear aspect.

Landing

Loft access.

Bedroom 1

13'5" x 9'1" (4.1 x 2.78)

Storage cupboard, airing cupboard, double glazed window to front aspect.

Bedroom 2

10'4" x 9'11" (3.15 x 3.03)

Double glazed window to rear aspect, built in wardrobes.

Bathroom

6'7" x 5'6" (2.02 x 1.68)

Panel bath, hand basin, low level WC, part tiled walls, opaque double glazed window to rear aspect.

Outside

Driveway to front. To the rear there is a lawned garden with bushes and shrubs. Brick shed.





Tenure

Freehold

Services

Mains water electricity, drainage.

Council Tax

Band A

EPC

Rating TBC

Location

Gorleston-on-Sea is a coastal town 2 miles from Great Yarmouth centre and has a varied selection of local shops * Golf Course * Modern District hospital * Schools for all ages * Library * Regular bus services to the main shopping areas and a sandy beach.

Directions

From the Gorleston office head South along the High Street, at the traffic lights turn right into Church Lane, continue over the roundabout and turn left at the next set of traffic lights into Magdalen Way, turn right in to Trinity Avenue, turn left into St. Anne's Crescent, Charter Close can be found on the left opposite the Old People's bungalows.

Ref G18018/03/24



Floor Plan

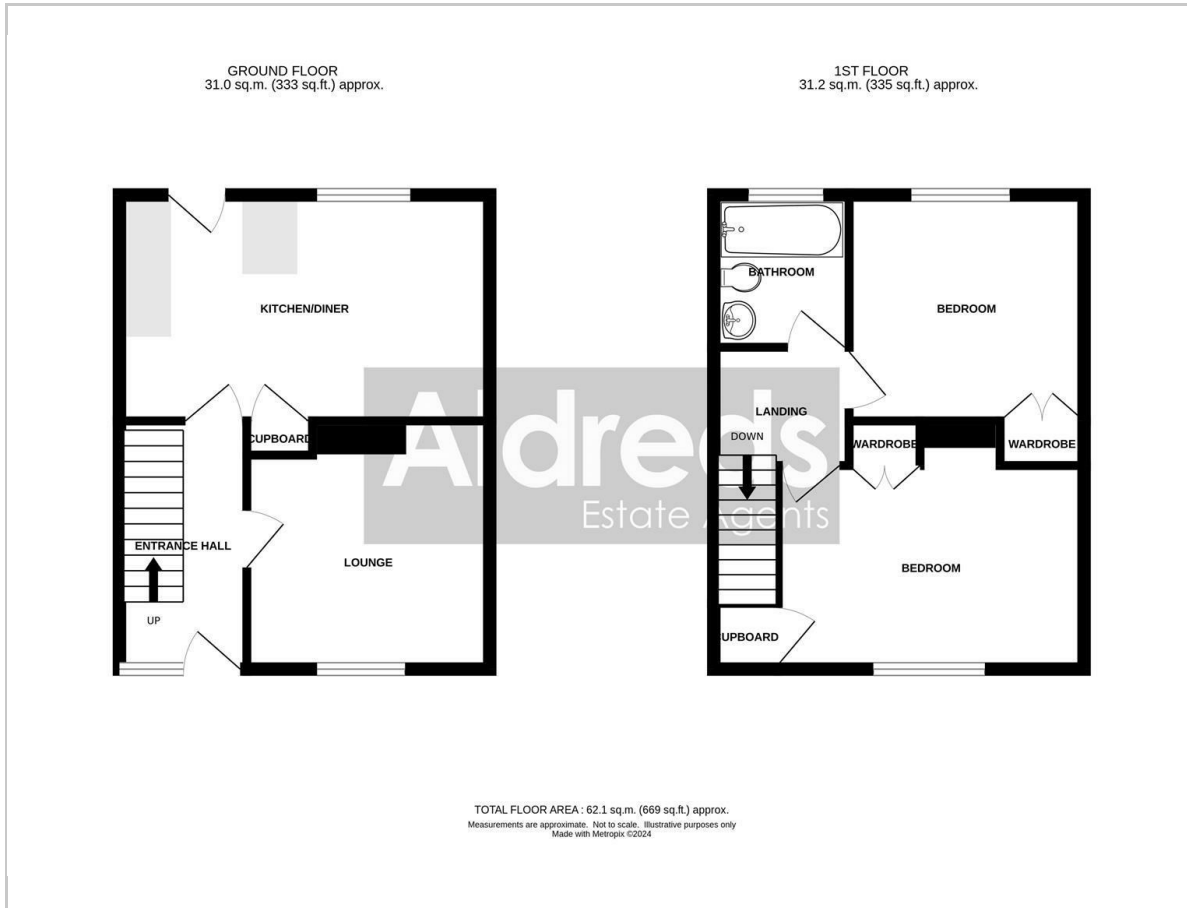

Area Map



Viewing

Please contact our Aldreds Gorleston Office on 01493 664600 if you wish to arrange a viewing appointment for this property or require further information.

Disclaimer

These particulars are issued on an understanding that all negotiations shall be conducted through Messrs. Aldreds. Please note: Messrs. Aldreds for themselves and for the vendors or lessors of this property whose agents they are given notice that: 1. Particulars are set out as a general outline only for guidance of intending purchasers or lessees, and do not constitute nor constitute part of, an offer or contract. 2. All descriptions, dimensions, references to condition and necessary permissions for use and occupation, and other details are given without responsibility and any intending purchasers or tenants should not rely on them as statements or representations of fact but must satisfy themselves by inspection or otherwise as to the correctness of each of them. 3. No person in the employment of Messrs. Aldreds has any authority to make or give any representation or warranty whatever in relation to this property. 4. If you are proposing to visit the property and are travelling some distance please check with Aldreds on the issue of availability prior to travelling. 5. Aldreds Property Consultants and associated services may offer additional services to the prospective purchaser for which they will be entitled to receive a commission.

Aldreds are pleased to be working with Mortgage Advice Bureau. They're an award-winning mortgage broker with over 1,400 advisers across the UK, and have access to over 12,000 mortgage products from over 90 lenders. Aldreds Estate Agents Ltd receive a commission of £200 on each completed case. Your home may be repossessed if you do not keep up repayments on your mortgage. There may be a fee for mortgage advice. The actual amount you pay will depend upon your circumstances. The fee is up to 1%, but a typical fee is 0.3% of the amount borrowed. Mortgage Advice Bureau is a trading name of Mortgage Seeker Limited which is an appointed representative of Mortgage Advice Bureau Limited and Mortgage Advice Bureau (Derby) Limited which are authorised and regulated by the Financial Conduct Authority. Mortgage Seeker Limited Registered Office: Lovewell Blake, Sixty Six North Quay, Great Yarmouth, Norfolk, NR30 1HE. Registered in England Number: 03721415. 6. Potential purchasers should check with their providers that the broadband and mobile phone coverage they would require is available.

Energy Efficiency Graph

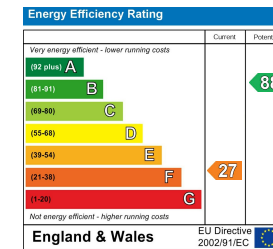

149 High Street, Gorleston, Norfolk, NR31 6RB
Tel: 01493 664600 Email: gorleston@aldreds.co.uk <https://www.aldreds.co.uk/>

Registered in England Reg. No. 08945751 Registered Office: 66 North Quay, Great Yarmouth, Norfolk NR30 1HE Directors: Mark Duffield B.S.c. FRICS. Dan Crawley MNAEA Paul Lambert MNAEA