

**Aldreds**  
Estate Agents



16 Noel Close

Hopton-on-Sea, Great Yarmouth, NR31 9RT

Offers In Excess Of £230,000



## 16 Noel Close

Hopton-on-Sea, Great Yarmouth, NR31 9RT

With a conservatory to the rear, Aldreds are pleased to offer this spacious two bedroom detached bungalow. The property offers an entrance hall, lounge, kitchen, conservatory, inner hallway, two bedrooms and a shower room. Gas central heating and sealed unit double glazing. Gardens to front & rear and a driveway leading to a garage. The property is offered with no upward chain.

### Entrance Hall

Storage cupboard, entrance door.

### Lounge

15'7" plus bay x 14'8" max 11'0" min (4.77 plus bay x 4.48 max 3.36 min)

Double glazed window to front aspect, radiator.

### Kitchen

10'11" x 7'10" (3.35 x 2.41)

Base & wall units with worktops, sink with drainer, wall gas boiler, gas hob, electric oven, plumbing for washing machine, door to conservatory.

### Conservatory

10'1" x 8'11" (3.08 x 2.74)

Brick based with sealed unit double glazing, door to garden.

### Inner Hallway

Loft access, storage cupboard.

### Bedroom 1

12'0" x 8'10" plus wardrobe space (3.68 x 2.7 plus wardrobe space)

Built in wardrobe, double glazed window to front aspect, radiator.

### Bedroom 2

9'0" x 8'5" (2.75 x 2.57)

Double glazed window to rear aspect, radiator.

### Shower Room

6'10" x 5'9" (2.1 x 1.76)

Flat floor shower, hand basin, low level WC, opaque double glazed window to rear aspect, radiator.





### Outside

To the front of the property there is a driveway leading to a garage with separate side entrance. The garage has an up & over door and benefits from power & light. To the rear there is a lawned garden with brick patio. Second side alley with front entrance gate to front of property.

### Tenure

Freehold

### Services

Mains water, electricity, gas, drainage.

### Council Tax

Band B

### Location

Part of the beautiful south Norfolk coast, Hopton-on-Sea is a village and seaside resort found on the east coast of Norfolk just 5 miles south of Great Yarmouth and 3 miles north of Lowestoft in Suffolk. Hopton-on-Sea is perhaps best known for being the host of the World Indoor Bowls Championships offering a well catered for tourist industry, visitors and locals alike can enjoy the village amenities which include leisure facilities, pubs and restaurants, primary school, village hall, church, post office and local shops. Bus links provide access to the Cathedral City of Norwich, Great Yarmouth and Lowestoft.

### Directions

Leave Gorleston heading south on the A47, at the Hopton-on-Sea roundabout turn left, at the T junction turn left into Lowestoft Road, continue past the playing field turning right into Noel Close where the property can be found on the left.

### EPC

D Rating 67 - potential 84

Ref 17992/01/24



## Floor Plan

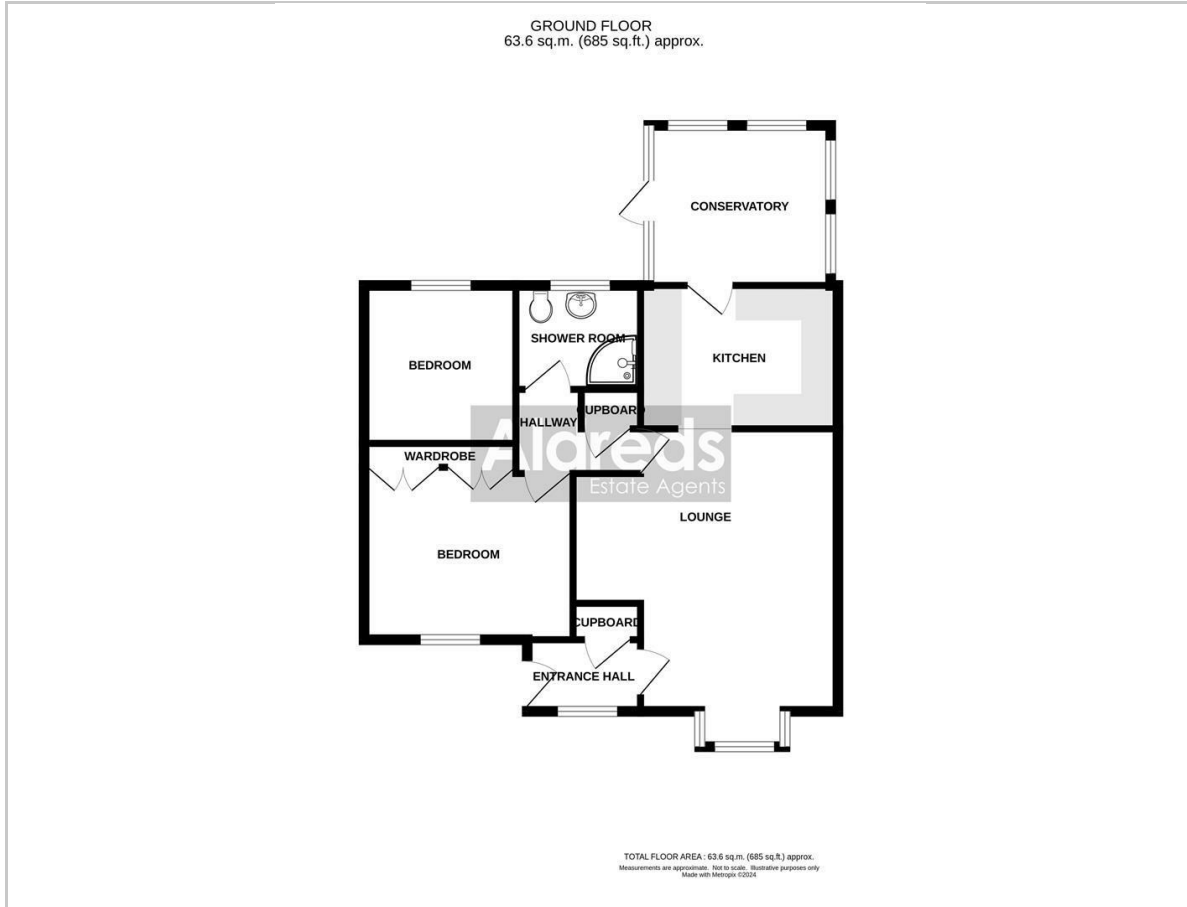

## Area Map

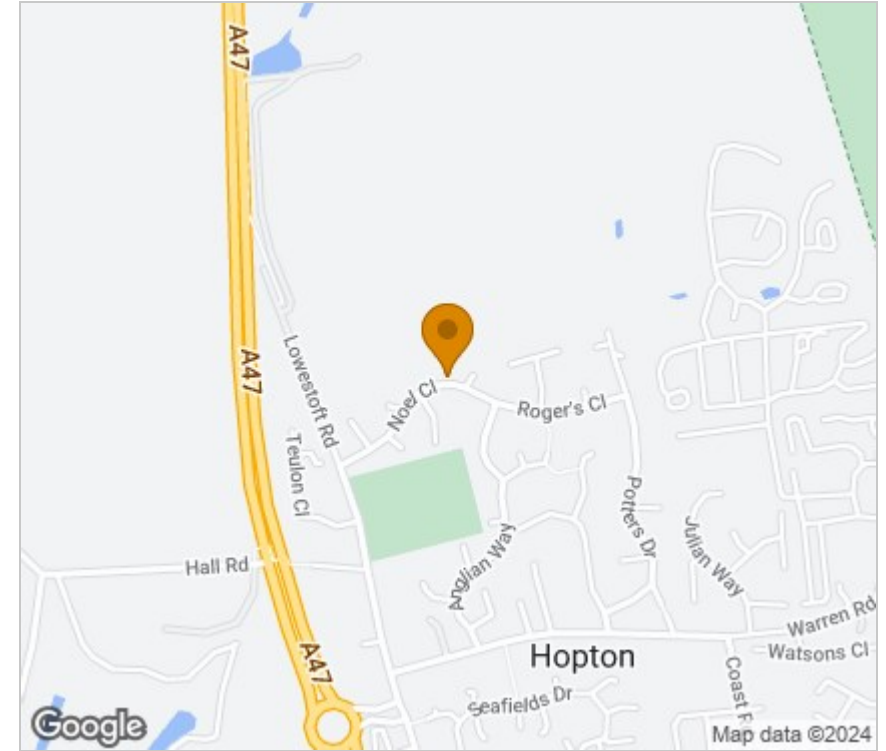

## Energy Efficiency Graph

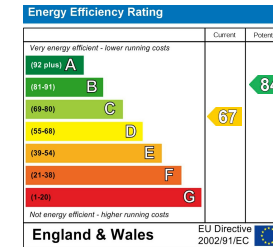

## Viewing

Please contact our Aldreds Gorleston Office on 01493 664600 if you wish to arrange a viewing appointment for this property or require further information.

### Disclaimer

These particulars are issued on an understanding that all negotiations shall be conducted through Messrs. Aldreds. Please note: Messrs. Aldreds for themselves and for the vendors or lessors of this property whose agents they are given notice that: 1. Particulars are set out as a general outline only for guidance of intending purchasers or lessees, and do not constitute nor constitute part of, an offer or contract. 2. All descriptions, dimensions, references to condition and necessary permissions for use and occupation, and other details are given without responsibility and any intending purchasers or tenants should not rely on them as statements or representations of fact but must satisfy themselves by inspection or otherwise as to the correctness of each of them. 3. No person in the employment of Messrs. Aldreds has any authority to make or give any representation or warranty whatever in relation to this property. 4. If you are proposing to visit the property and are travelling some distance please check with Aldreds on the issue of availability prior to travelling. 5. Aldreds Property Consultants and associated services may offer additional services to the prospective purchaser for which they will be entitled to receive a commission.

Aldreds are pleased to be working with Mortgage Advice Bureau. They're an award-winning mortgage broker with over 1,400 advisers across the UK, and have access to over 12,000 mortgage products from over 90 lenders. Aldreds Estate Agents Ltd receive a commission of £200 on each completed case. Your home may be repossessed if you do not keep up repayments on your mortgage. There may be a fee for mortgage advice. The actual amount you pay will depend upon your circumstances. The fee is up to 1%, but a typical fee is 0.3% of the amount borrowed. Mortgage Advice Bureau is a trading name of Mortgage Seeker Limited which is an appointed representative of Mortgage Advice Bureau Limited and Mortgage Advice Bureau (Derby) Limited which are authorised and regulated by the Financial Conduct Authority. Mortgage Seeker Limited Registered Office: Lovewell Blake, Sixty Six North Quay, Great Yarmouth, Norfolk, NR30 1HE. Registered in England Number: 03721415. 6. Potential purchasers should check with their providers that the broadband and mobile phone coverage they would require is available.

149 High Street, Gorleston, Norfolk, NR31 6RB  
Tel: 01493 664600 Email: [gorleston@aldreds.co.uk](mailto:gorleston@aldreds.co.uk) <https://www.aldreds.co.uk/>

Registered in England Reg. No. 08945751 Registered Office: 66 North Quay, Great Yarmouth, Norfolk NR30 1HE Directors: Mark Duffield B.S.c. FRICS. Dan Crawley MNAEA Paul Lambert MNAEA