

**Aldreds**  
Estate Agents



Windrush South Road

Hemsby, Great Yarmouth, NR29 4JH

£350,000



3



2



2



C

## Windrush South Road

Hemsby, Great Yarmouth, NR29 4JH

**\*CHAIN FREE\*** A fantastic modern and spacious three bedroom (designed as four bedroom) detached bungalow sitting in the popular coastal village. The property offers an entrance hall, lounge, kitchen/dining room, master bedroom with ensuite, two further bedrooms and a family bathroom. Oil central heating and sealed unit double glazing. Outside there are gardens to front & rear and a driveway leading to a garage.

### Entrance Hall

Tiled floor, loft access, entrance door to side.

### Lounge

19'1" x 14'7" (5.84 x 4.45)

Double glazed French doors to rear garden, double glazed window to side aspect, two radiators.

### Kitchen/Diner

26'6" x 13'0" max 9'8" min (8.1 x 3.98 max 2.95 min)

Base & wall units with worktops, double glazed window to rear aspect, door to side, radiator, sink with drainer, tiled floor, part tiled walls, plumbing for washing machine, electric hob, electric oven, airing cupboard.

### Master Bedroom

13'11" x 11'3" (4.26 x 3.44)

Double glazed window to front aspect, radiator, door to

### Ensuite Shower Room

Shower in cubicle, low level WC, hand basin, part tiled walls, opaque double glazed window to side aspect.

### Bedroom 2

15'8" x 9'10" (4.8 x 3)

Double glazed window to front aspect, double glazed window to side aspect, radiator.

### Bedroom 3

12'2" x 9'10" (3.73 x 3)

Double glazed window to side aspect, radiator.





### Bathroom

9'8" x 8'0" (2.97 x 2.46)

Part tiled walls, freestanding bath, hand basin, low level WC, part tiled walls, opaque double glazed window to side aspect, radiator.

### Outside

To the front of the property there is a driveway leading to garage, the garage has power and light. Oil tank. To the rear of the property there is a well kept approx. south facing garden which is laid to lawn with a paved patio.

### Tenure

Freehold

### Council Tax

Band C

### Services

Mains water, electricity, drainage

### Location

Hemsby is a coastal village approximately 7 miles north of Great Yarmouth. There is a variety of shops, post office, medical centre, first school with older children attending the middle and high schools in Martham, a school bus service link, regular bus service to and from Great Yarmouth. The beaches are one of the major draws of Hemsby, with miles of sandy coastline. Large sand dunes form a natural barrier between the beach and the village behind it. Hemsby is split into two parts: Hemsby Village and Hemsby Beach. Hemsby Village is mainly the residential area located about a mile inland. Kings Way this is also the main location for buses into Great Yarmouth and Martham.

### Directions

From the Yarmouth office head north along the A149 Caister Road, continue past the Yarmouth Stadium, at the roundabout turn left onto the Caister Bypass, continue over the next roundabout into Jack Chase Way, continue over the next roundabout into Scratby Road, continue into Yarmouth Road, continue into Kings Way, at the mini roundabout turn right into Beach Road, turn right in to St Thomas' Road, turn left in to South Road.

Ref Y12038/04/24



## Floor Plan

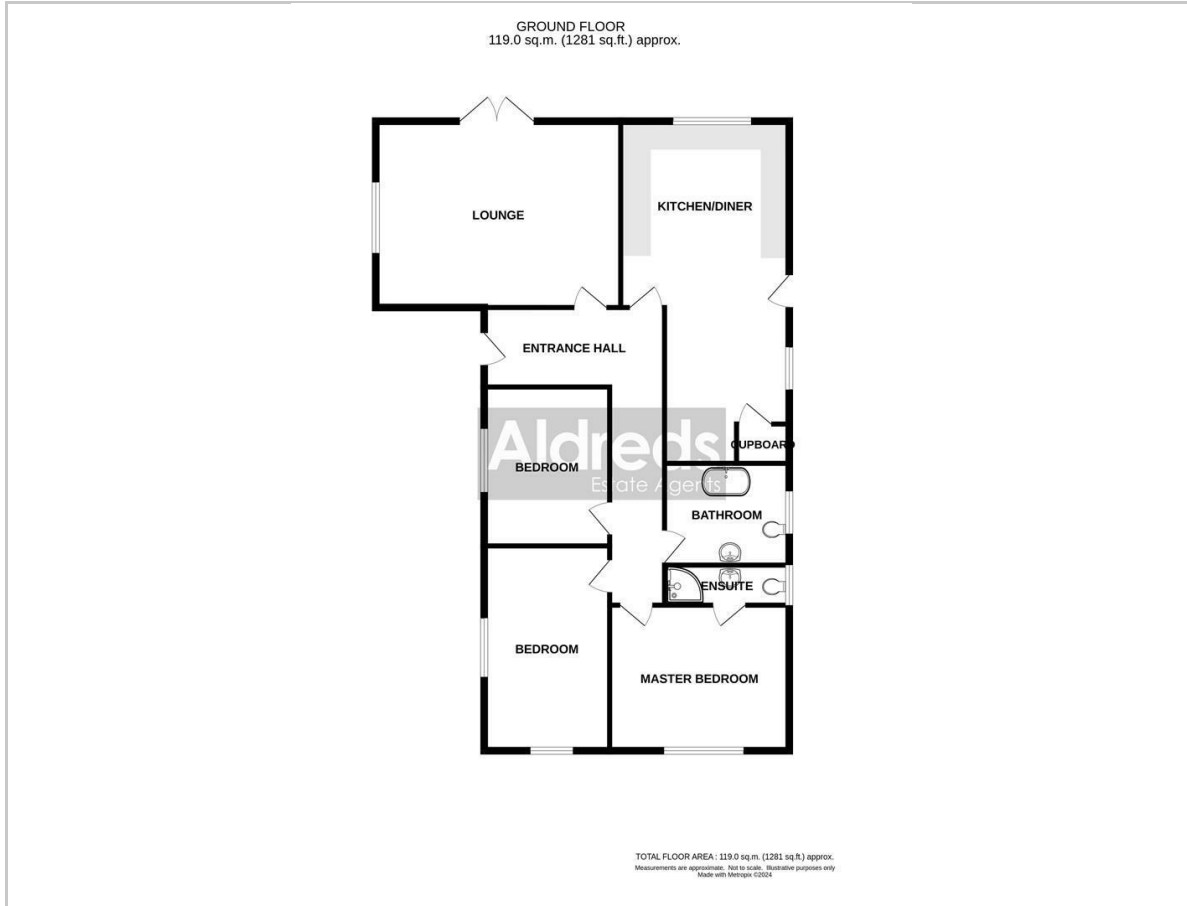

## Viewing

Please contact our Aldreds Great Yarmouth Office on 01493 844891 if you wish to arrange a viewing appointment for this property or require further information.

### Disclaimer

These particulars are issued on an understanding that all negotiations shall be conducted through Messrs. Aldreds. Please note: Messrs. Aldreds for themselves and for the vendors or lessors of this property whose agents they are given notice that: 1. Particulars are set out as a general outline only for guidance of intending purchasers or lessees, and do not constitute nor constitute part of, an offer or contract. 2. All descriptions, dimensions, references to condition and necessary permissions for use and occupation, and other details are given without responsibility and any intending purchasers or tenants should not rely on them as statements or representations of fact but must satisfy themselves by inspection or otherwise as to the correctness of each of them. 3. No person in the employment of Messrs. Aldreds has any authority to make or give any representation or warranty whatever in relation to this property. 4. If you are proposing to visit the property and are travelling some distance please check with Aldreds on the issue of availability prior to travelling. 5. Aldreds Property Consultants and associated services may offer additional services to the prospective purchaser for which they will be entitled to receive a commission.

Aldreds are pleased to be working with Mortgage Advice Bureau. They're an award-winning mortgage broker with over 1,400 advisers across the UK, and have access to over 12,000 mortgage products from over 90 lenders. Aldreds Estate Agents Ltd receive a commission of £200 on each completed case. Your home may be repossessed if you do not keep up repayments on your mortgage. There may be a fee for mortgage advice. The actual amount you pay will depend upon your circumstances. The fee is up to 1%, but a typical fee is 0.3% of the amount borrowed. Mortgage Advice Bureau is a trading name of Mortgage Seeker Limited which is an appointed representative of Mortgage Advice Bureau Limited and Mortgage Advice Bureau (Derby) Limited which are authorised and regulated by the Financial Conduct Authority. Mortgage Seeker Limited Registered Office: Lovewell Blake, Sixty Six North Quay, Great Yarmouth, Norfolk, NR30 1HE. Registered in England Number: 03721415. 6. Potential purchasers should check with their providers that the broadband and mobile phone coverage they would require is available.

## Area Map

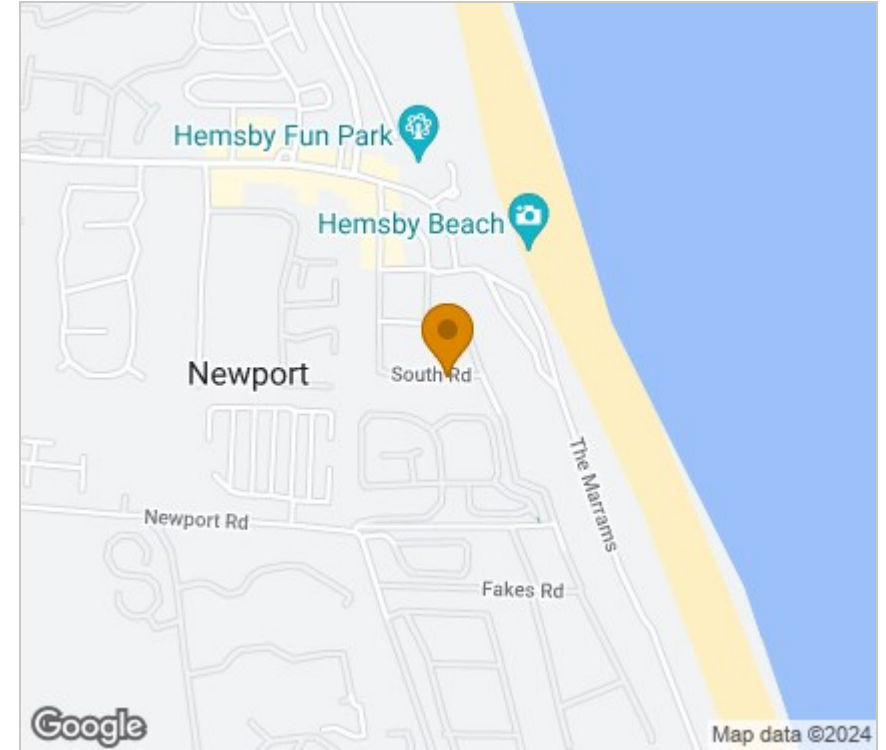

## Energy Efficiency Graph

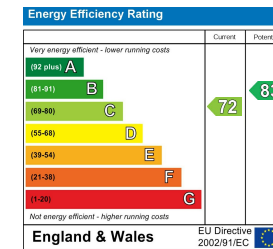

17 Hall Quay, Great Yarmouth, Norfolk, NR30 1HJ  
Tel: 01493 844891 Email: [yarmouth@aldreds.co.uk](mailto:yarmouth@aldreds.co.uk) <https://www.aldreds.co.uk/>

Registered in England Reg. No. 08945751 Registered Office: 66 North Quay, Great Yarmouth, Norfolk NR30 1HE Directors: Mark Duffield B.S.c. FRICS. Dan Crawley MNAEA Paul Lambert MNAEA