



8 Lansdown View

Faulkland, BA3 5UT

£289,950

Launched by our new Midsomer Norton branch! Nestled within the charming Faulkland Village, this delightful three-bedroom semi-detached residence offers a perfect blend of comfort and countryside living. With two reception rooms, good sized bedrooms and a South facing garden this is a great family home.

Fantastic village location
South facing rear garden
Views to front across fields
Two reception rooms
Generously sized throughout
Motivated sellers
Call our Midsomer Norton Branch today!

Viewing

Please contact our Bath Stone Property (MSN) Office on 01761 360144 if you wish to arrange a viewing appointment for this property or require further information.



3



1



2



E

Floor Plan

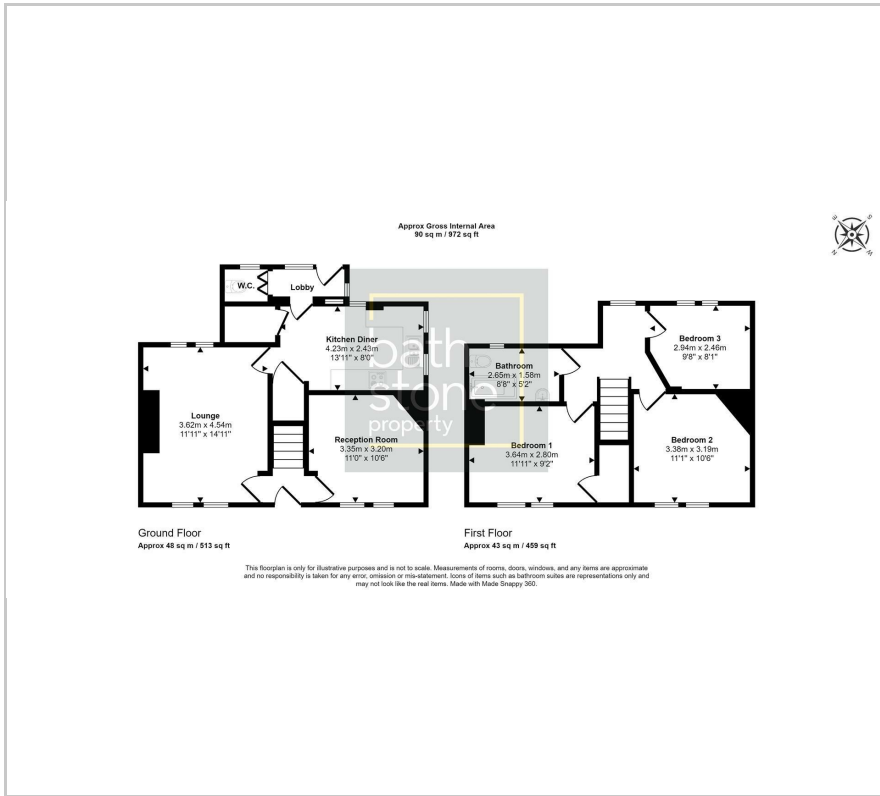

Area Map



Energy Efficiency Graph

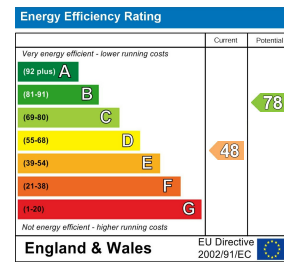

These particulars, whilst believed to be accurate are set out as a general outline only for guidance and do not constitute any part of an offer or contract. Intending purchasers should not rely on them as statements of representation of fact, but must satisfy themselves by inspection or otherwise as to their accuracy. No person in this firm's employment has the authority to make or give any representation or warranty in respect of the property.

1 Gladys House South Road, Midsomer Norton, BA3 2EZ

Tel: 01761 360144 Email: sales@bathstoneproperty.com <https://www.bathstoneproperty.com>