



63 Poolemead Road

, Bath, BA2 1QP

Offers In Excess Of £325,000



3



1



1



c

63 Poolemead Road



Description

360 VIRTUAL TOUR AVAILABLE This 1960's home is a must to see! With fabulous living space, lovely views, lounge/diner, kitchen, conservatory, plenty of storage, three bedrooms and family bathroom. Externally you get a beautiful large garden to the rear and also front garden.

Three Bedrooms
Cul-de-Sac
Light & Airy
Spacious

Mid-Terrace
Large Long Garden
Scope to Extend





Floor Plan

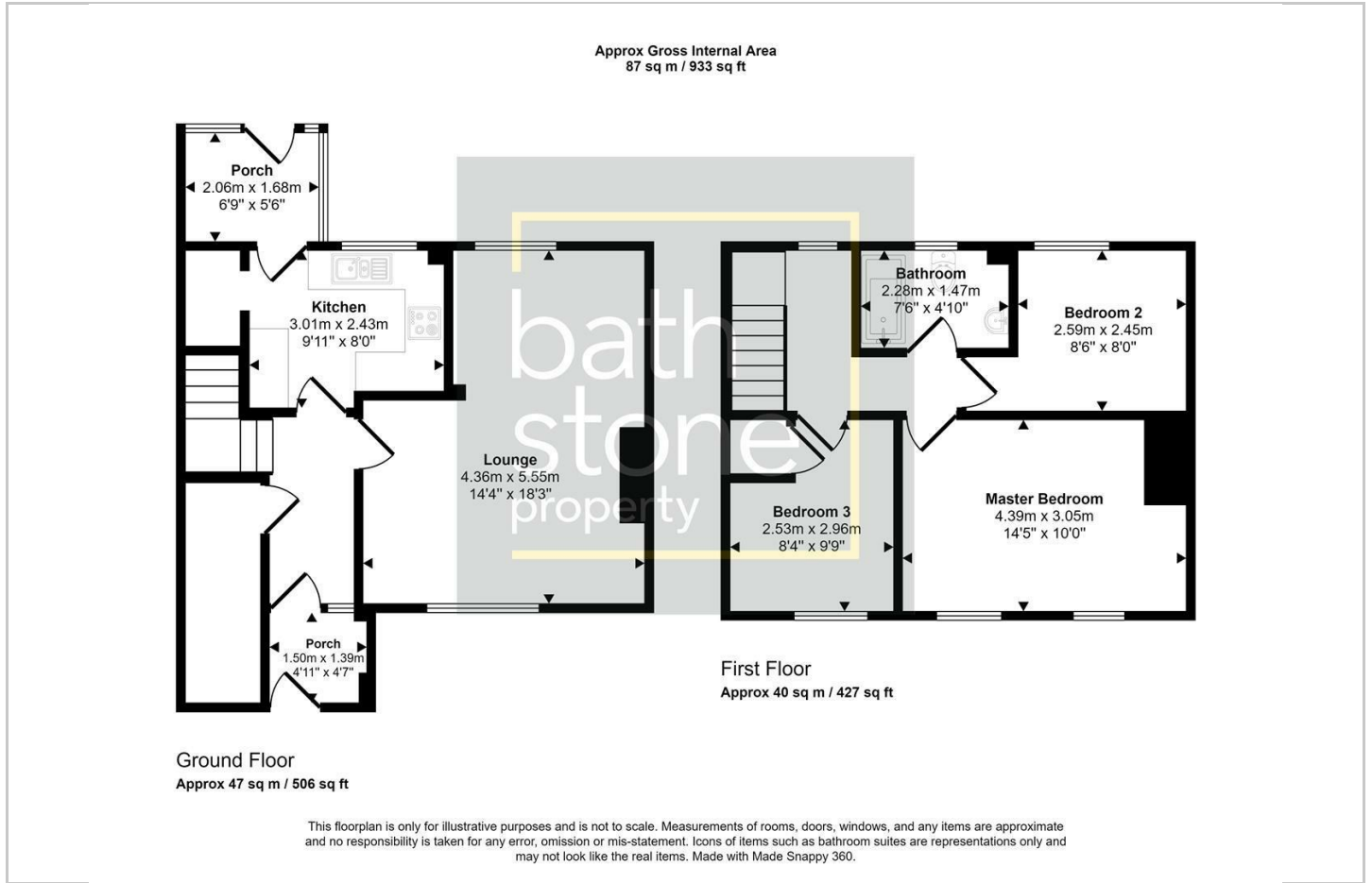

Area Map

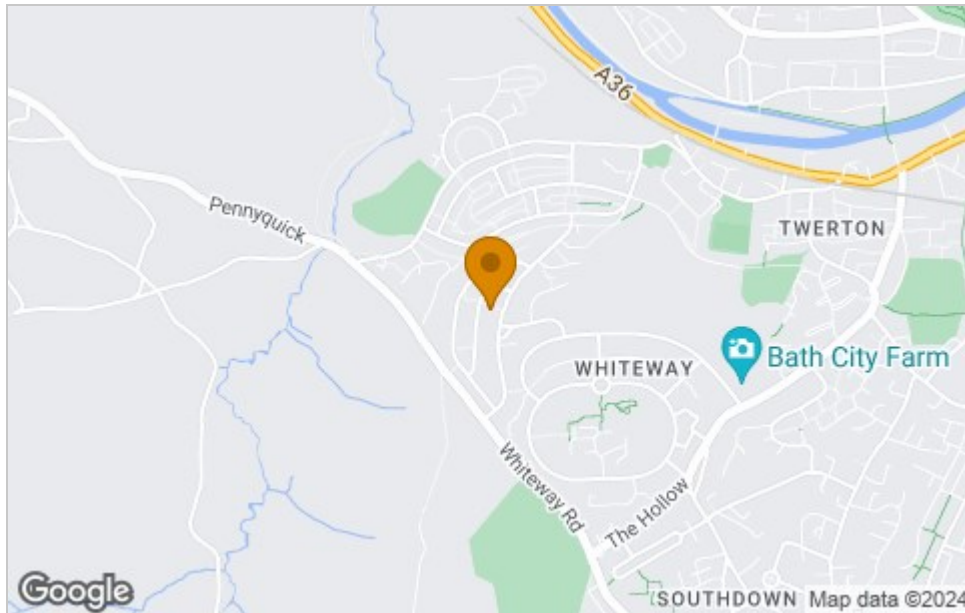

Energy Efficiency Graph

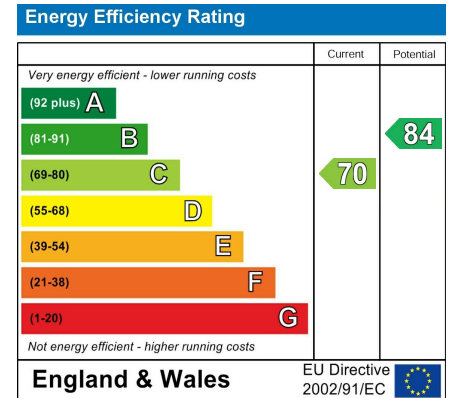

Viewing

Please contact our Bath Stone Property Office on 01225422224 if you wish to arrange a viewing appointment for this property or require further information.

These particulars, whilst believed to be accurate are set out as a general outline only for guidance and do not constitute any part of an offer or contract. Intending purchasers should not rely on them as statements of representation of fact, but must satisfy themselves by inspection or otherwise as to their accuracy. No person in this firm's employment has the authority to make or give any representation or warranty in respect of the property.