



## 14 Middlewood Close

, Bath, BA2 2TU

### Offers In Excess Of £300,000

360 Virtual Tour Available. A well-presented two bedroomed semi-detached home, with a secure enclosed garden to the rear, situated in a quiet, sought after cul-de-sac. The location offers good commuting routes. Middlewood Close is a must to see, to appreciate the spaciousness.

Semi-Detached  
Two Bedrooms  
Cul-de-Sac  
Driveway  
Downstairs WC  
Good Size-Easy Maintenance Garden

#### Viewing

Please contact our Bath Stone Property Office on 01225422224 if you wish to arrange a viewing appointment for this property or require further information.



## Floor Plan

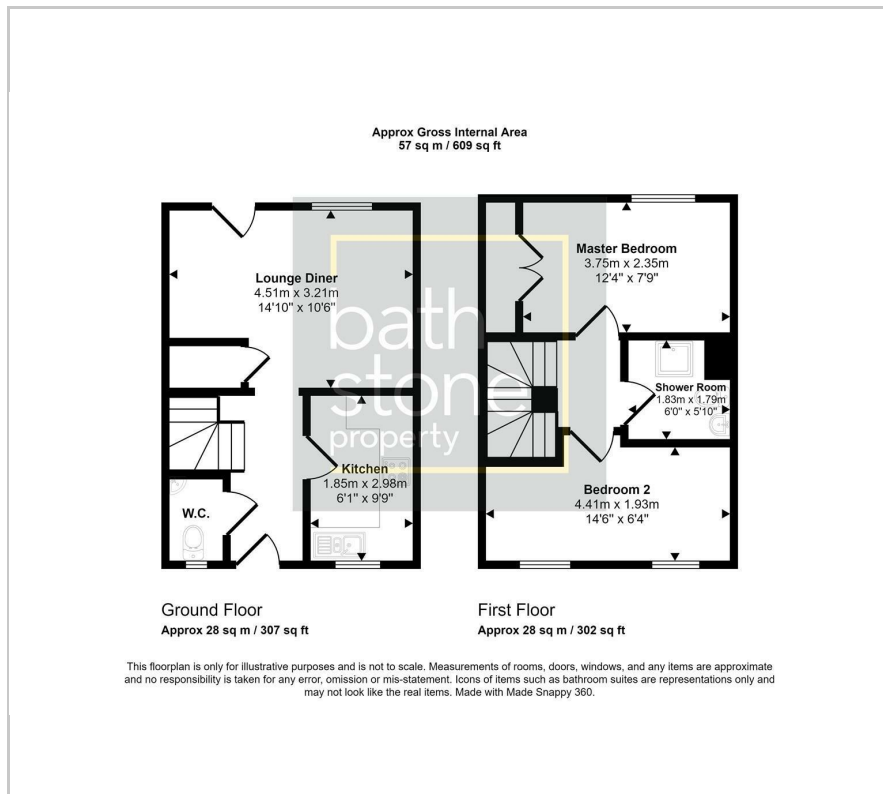

## Area Map

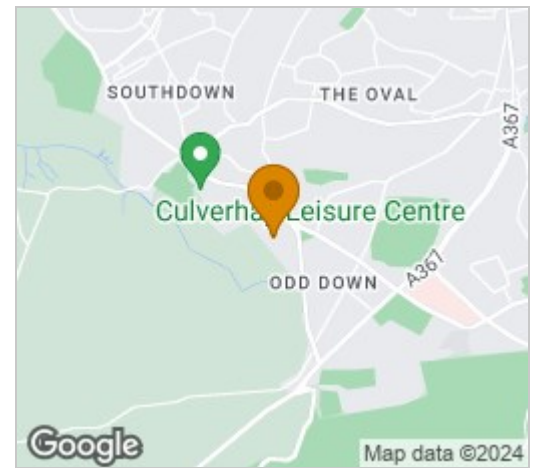

## Energy Efficiency Graph

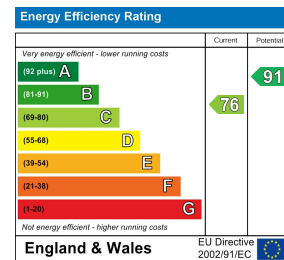

These particulars, whilst believed to be accurate are set out as a general outline only for guidance and do not constitute any part of an offer or contract. Intending purchasers should not rely on them as statements of representation of fact, but must satisfy themselves by inspection or otherwise as to their accuracy. No person in this firm's employment has the authority to make or give any representation or warranty in respect of the property.

1 Hayes Place, Bath, BANES, BA2 4QW

Tel: 01225422224 Email: [sales@bathstoneproperty.com](mailto:sales@bathstoneproperty.com) <https://www.bathstoneproperty.com>