



18 Haycombe Drive

, Bath, BA2 1PF

Offers In Excess Of £325,000

Located on the south side of Bath, this semi-detached house offers three bedrooms and a good size private garden. Local amenities can be found nearby at Mount Road and there is a regular bus service close by. Perfect for first-time buyers or for investment.

Semi-Detached

Three Bedrooms

Two Reception Rooms

Utility room

Easy Maintenance Garden

Spacious accommodation

Viewing

Please contact our Bath Stone Property Office on 01225422224 if you wish to arrange a viewing appointment for this property or require further information.



Floor Plan

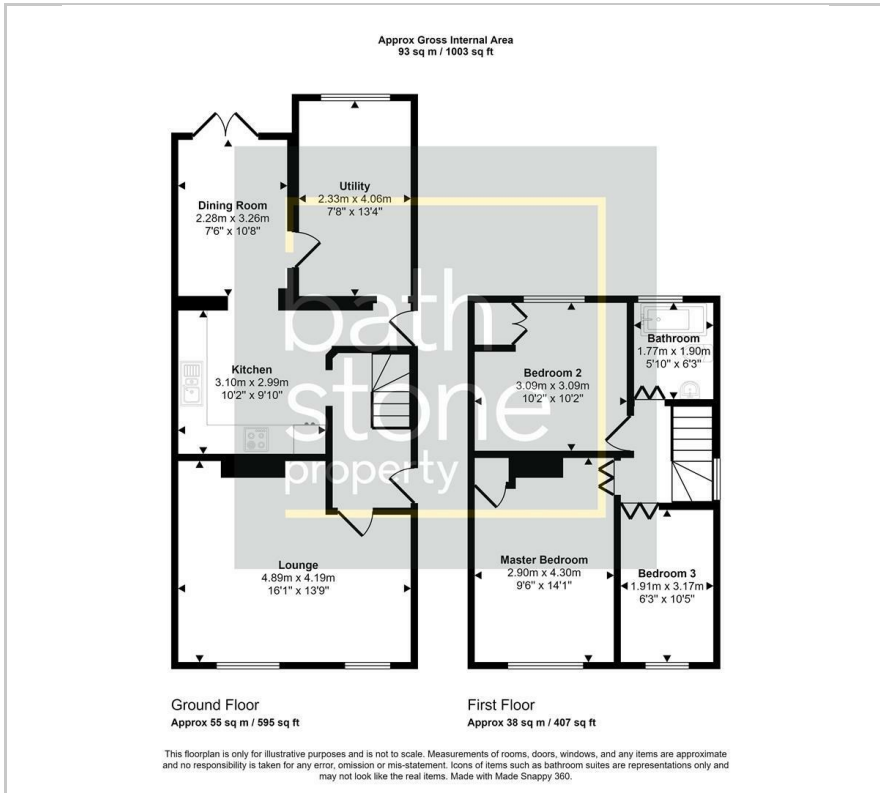

Area Map



Energy Efficiency Graph



These particulars, whilst believed to be accurate are set out as a general outline only for guidance and do not constitute any part of an offer or contract. Intending purchasers should not rely on them as statements of representation of fact, but must satisfy themselves by inspection or otherwise as to their accuracy. No person in this firm's employment has the authority to make or give any representation or warranty in respect of the property.

1 Hayes Place, Bath, BANES, BA2 4QW

Tel: 01225422224 Email: sales@bathstoneproperty.com <https://www.bathstoneproperty.com>