



## 133 The Hollow

Southdown, Bath, BA2 1NQ

£2,320 PCM

Four double bedroom student house, in Southdown close to local shops and cafes, with university bus links.

- Four double bedrooms
- Bathroom and additional WC
- Fully furnished
- Low maintenance garden
- Double glazing
- Gas central heating

### Viewing

Please contact our Bath Stone Property Office on 01225422224 if you wish to arrange a viewing appointment for this property or require further information.



## Floor Plan

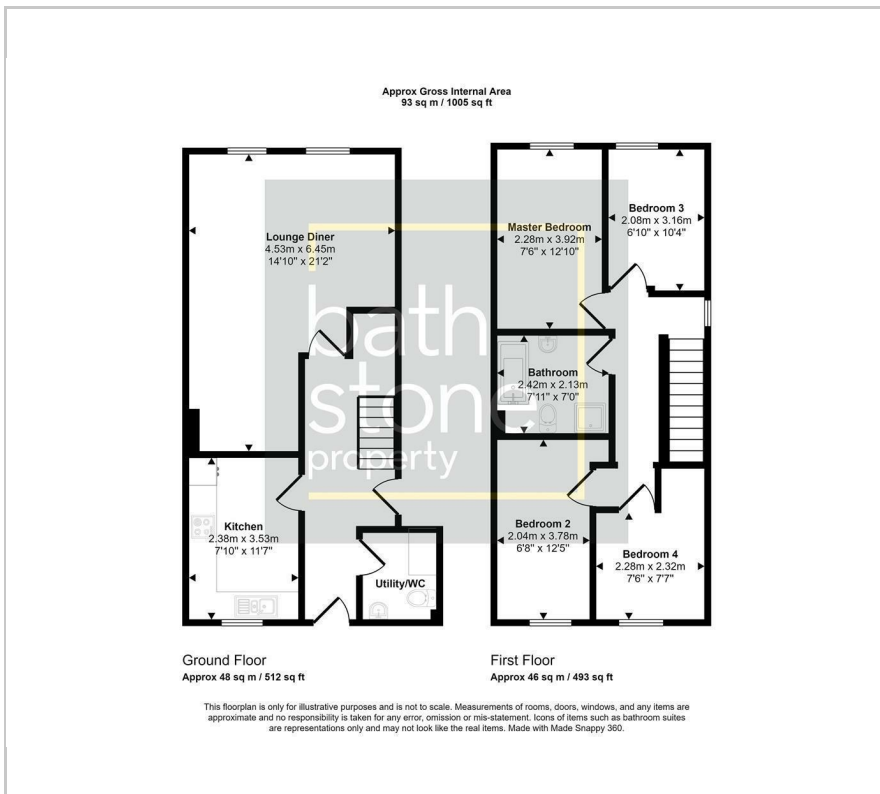

## Area Map



## Energy Efficiency Graph

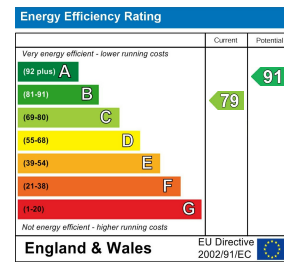

These particulars, whilst believed to be accurate are set out as a general outline only for guidance and do not constitute any part of an offer or contract. Intending purchasers should not rely on them as statements of representation of fact, but must satisfy themselves by inspection or otherwise as to their accuracy. No person in this firm's employment has the authority to make or give any representation or warranty in respect of the property.

1 Hayes Place, Bath, BANES, BA2 4QW

Tel: 01225422224 Email: [sales@bathstoneproperty.com](mailto:sales@bathstoneproperty.com) <https://www.bathstoneproperty.com>