



46 South View Road

Bath, BA2 3RW

£1,875 PCM

Three double bedroom student house, close to Moorland Road with local shops and cafes and university bus links.

- 3 double bedroom student house
- Fully furnished
- Gas central heating
- Double glazing
- On-street parking
- 3 miles to University of Bath
- 0.3 miles to Moorland Road shops and cafes

Viewing

Please contact our Bath Stone Property Office on 01225422224 if you wish to arrange a viewing appointment for this property or require further information.



3



1



1

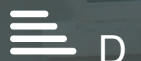

D

Floor Plan

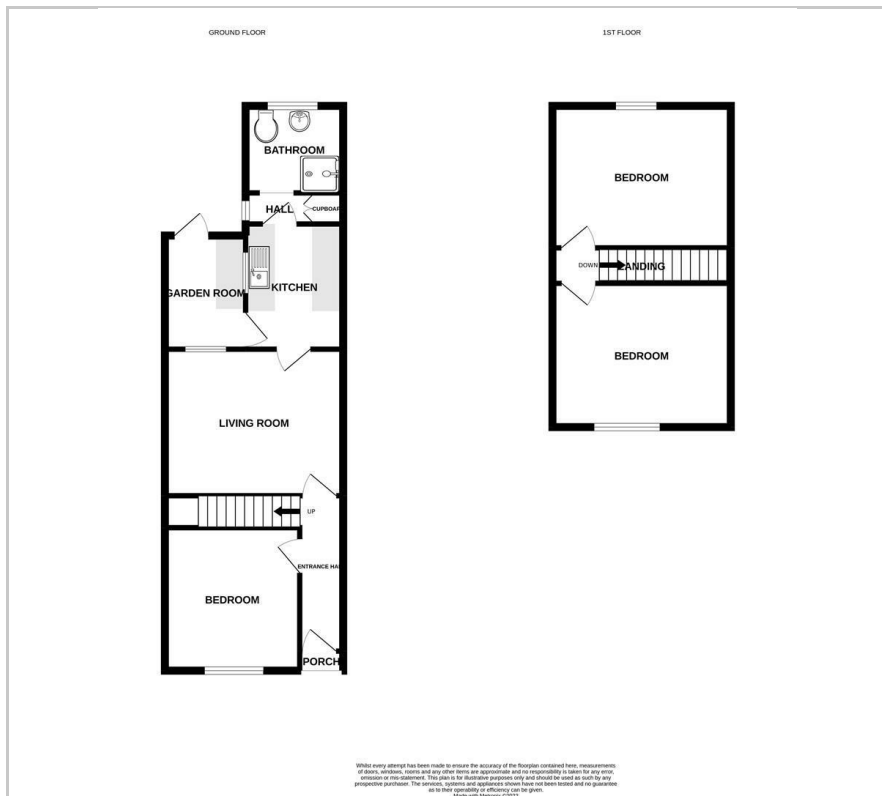

Area Map



Energy Efficiency Graph

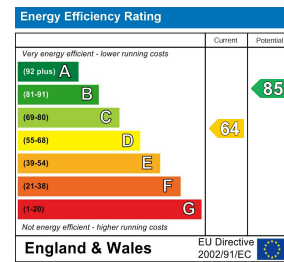

These particulars, whilst believed to be accurate are set out as a general outline only for guidance and do not constitute any part of an offer or contract. Intending purchasers should not rely on them as statements of representation of fact, but must satisfy themselves by inspection or otherwise as to their accuracy. No person in this firm's employment has the authority to make or give any representation or warranty in respect of the property.